

■ DIMENSION

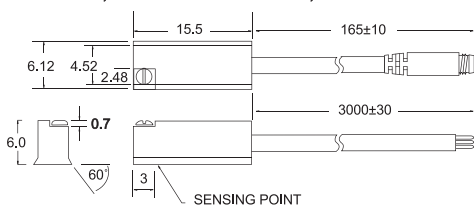

CS-30N, CS-30P / CS-30N-QD, CS-30P-QD



CS-30R / CS-30R-QD

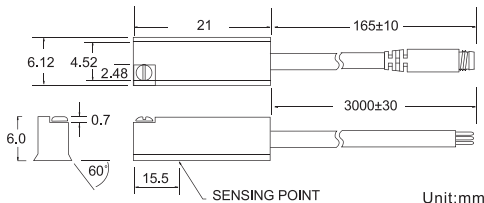

■ QD PINOUT

*3 wire QD wiring

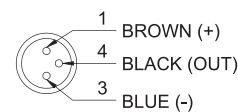

*2 wire QD wiring

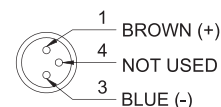

*2 wire EQD wiring

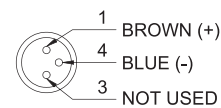

■ SPECIFICATION

TYPE	CS-30R	CS-30N	CS-30P
CONNECT DIAGRAM			
CHARACTERISTICS			
WIRING METHOD	2-Wire Type	3-Wire Type	
SWITCHING LOGIC	SPST, Normally Open	Solid State Output, Normally Open	
SENSOR TYPE	Reed Switch	NPN Current Sinking	PNP Current Sourcing
OPERATING VOLTAGE	5~120V DC/AC	5~30V DC	
SWITCHING CURRENT	50 mA max.	200 mA max.	
CONTACT RATING	6 W max.	6 W max.	
CURRENT CONSUMPTION	--	17 mA @ 24V DC max.	
VOLTAGE DROP	2.5 V max.	0.5 V @ 25mA max.	
LEAKAGE CURRENT	--	0.01 mA max.	
INDICATOR	Red LED		
CABLE	ø2.8, 2C, PUR	ø2.8, 3C, PUR	
OPERATING FREQUENCY	200 Hz	1000 Hz	
MAGNET REQUIREMENT (NOTE 1)	40 Gauss Parallel		
TEMPERATURE RANGE	-10~70°C (+14~158°F)		
SHOCK (NOTE 2)	30 G	50 G	
VIBRATION (NOTE 3)	9 G		
ENCLOSURE CLASSIFICATION	IEC 529 IP 67 (NEMA 6)		
PROTECTION CIRCUIT (NOTE 4)	1		3,4
SET SCREW MAX. TORQUE	1.77 in-lbs (0.2 N-m)		

WARNING: Never exceed rating (Watt=Voltage x Amperage). Permanent damage to sensor will occur.

NOTE:

1. Measuring standard target: ø15.5Xø8X5t (Anisotropy rubber magnet)
2. Sin wave / X, Y, Z 3 directions / 3 times each direction / 11 ms each time.
3. Double amplitude 1.5 mm / 10Hz~55Hz~10Hz (Sweep 1 min) / X, Y, Z 3 directions / 1 hour each time.
4. 1=None / 2=Short-circuit / 3=Power Source Reverse polarity / 4=Surge Suppression

■ GROOVE DIMENSION

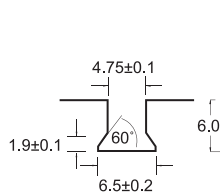

1/4" dovetail

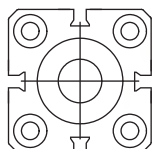

3/8" dovetail adaptor

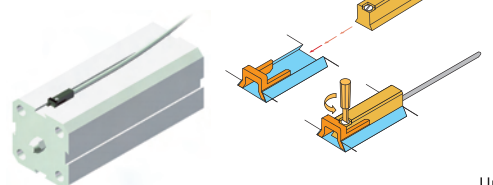

Unit:mm