

Products Recommended for Steam Service

Quick Disconnect Fittings

- available in solid brass with stainless steel springs and locking balls
- sizes ¼" through 1½"
- for more information see page 104

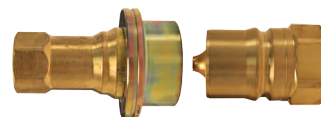

Dry Disconnect Fittings

- available in stainless steel, with EPDM seals
- sizes ¾" and 1"
- for more information see page 104



E

GJ Boss™ Female Ground Joint Fittings

- available in plated steel and/or iron
- sizes ¼" through 6"
- for more information see page 106



Boss Female Washer Seal Fittings

- available in plated steel and/or iron
- sizes ¾" through 3"
- for more information see page 109



Boss Male Stems

- available in steel bar stock sizes ¼" through 1"; iron in sizes 1¼" through 4"; 316 stainless steel in sizes ½" through 4" and brass in sizes ¾" through 3"
- for more information see page 110



Boss Clamps

- 2-bolt and 4-bolt style available in plated iron in sizes ¼" through 3"; stainless steel in sizes ½" through 3" and brass in sizes ½" through 2"
- three-piece style are available in plated iron in sizes 3" through 6"
- for more information see pages 111 and 112



180° Steam Gauge Siphons

- available in steel and red brass pipe
- ¼" NPT schedule 40 steel, welded
- for more information see page 277



250 PSIG Steam Ball Valves

- available in bronze with 316 stainless steel ball and stem
- sizes ½" through 2"
- for more information see page 670



Note: Pressurized steam is an extremely dangerous commodity. Only hose, fittings, clamps and accessory items that have been approved for steam service should ever be used! Never use an unapproved item for steam service. Always follow the manufacturer's product recommendations for pressurized steam handling.

Steam Quick Disconnect Couplings

Applications:

- designed exclusively for steam applications

Features:

- coupler and plug are solid brass with stainless steel springs and locking balls
- coupler has a large plated steel sleeve designed for easier gripping with gloves
- two ethylene propylene O-rings in the coupler and one ethylene propylene O-ring in the plug provide double protection against leaks
- rated to **200 PSI** gauge saturated steam (**388°F**)



Warning: Do Not Disconnect Under Pressure!

poppet valve couplers

Body Size	Female NPT Size	Part #	Price/E
1/4"	1/4"	B16-200S	\$44.92
3/8"	3/8"	B16-300S	48.40
1/2"	1/2"	B16-400S	67.52
3/4"	3/4"	B16-600S	105.71
1"	1"	B16-800S	171.63
1 1/2"	1 1/2"	B16-1200S	459.94

poppet valve plugs

Body Size	Female NPT Size	Part #	Price/E
1/4"	1/4"	B17-200S	\$13.88
3/8"	3/8"	B17-300S	19.64
1/2"	1/2"	B17-400S	24.67
3/4"	3/4"	B17-600S	43.33
1"	1"	B17-800S	56.64
1 1/2"	1 1/2"	B17-1200S	356.40



Dry Disconnect Fittings for Steam Service

Applications:

- Designed to fit hoses carrying steam in chemical (heating) and pharmaceutical (disinfection and sterilization) applications and at loading bays.

Features:

- eliminates unintentional separation preventing accidents and avoiding unintended down time
- performance unaffected by surface rust
- maximum operating: **150 PSI**
- maximum temperature rating: 350°F
- lockable versions are available, contact Dixon for pricing

Materials:

- stainless steel coupling house and all inner parts
- EPDM seals (standard), other materials available, contact Dixon for pricing

coupler x female NPT

Female NPT	Body Size	Stainless Steel Part #	Price/E
3/4"	56 mm	DDSC075SS	\$2956.30
1"	56 mm	DDSC100SS	2956.30

adapter x female NPT

Female NPT	Body Size	Stainless Steel Part #	Price/E
3/4"	56 mm	DDSA075SS	\$832.10
1"	56 mm	DDSA100SS	832.10



Boss Coupling System

Features: The spud part of the coupling serves as one half of the connection and is usually fixed to the equipment. The stem part that is clamped to the hose is the other half. The two halves are connected or disconnected by rotating the wing nut onto the spud. When connected they achieve both a mechanical, and a pressure seal.

Services: Boss couplings are all-purpose hose couplings, universally recommended for steam hose connections. They are also widely used for air, water, fluid petroleum, chemicals and liquid petroleum gas up to 1" ID. Boss couplings can be applied to many types of rubber, synthetic, plastic, metallic or semi-metallic hose. Consult the factory for specific media capabilities.

Purpose: Boss couplings supply a convenient threaded fitting to connect two lengths of hose, or a single length to a male or female threaded (NPT) outlet.

Material:

- stem: ¼" - 1" plated steel, 1¼" - 4" plated iron, 6" tubular steel
- spud: ¼" - 1" plated steel, 1¼" - 6" plated iron
- wing nut: ¼" plated steel, ¾" - 6" plated iron

Seal Types:

- ground joint: copper or polymer seats
- washer: Klingersil® C-4401

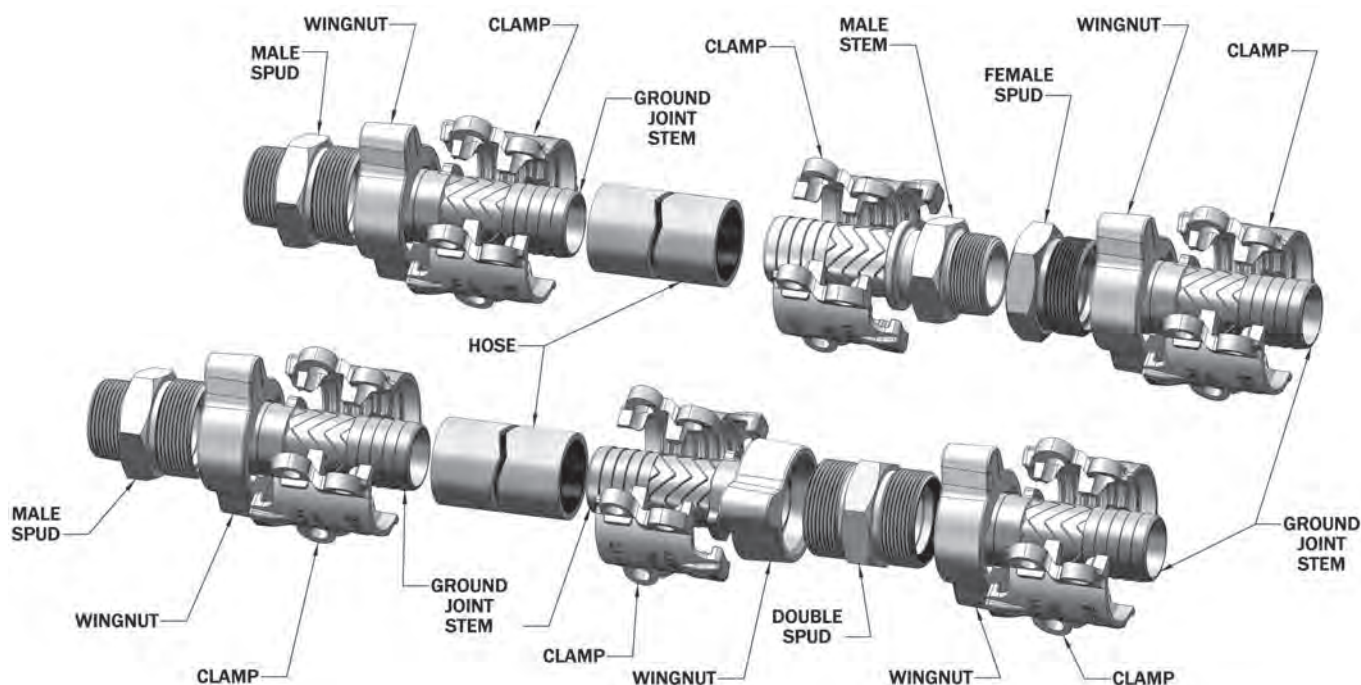

Worn-out hose couplings can be dangerous. They should be checked regularly and replaced when necessary. Each coupling user should review applications and add safety devices where indicated.

GJ Boss™ Ground Joint Seal

E

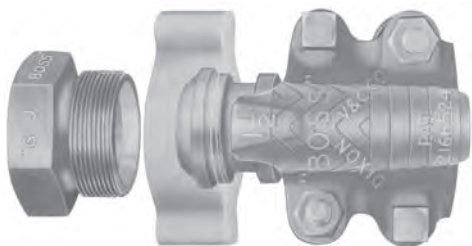

Features:

- positive metal-to-polymer seal
- leakproof seal forms when the metal head of the stem makes contact with the patented polymer seat in the spud
- non-metallic polymer seat resists most chemicals found in manufacturing facilities (reference corrosion resistance chart on pages 802-807)
- recommended for steam service up to **450°F**
- easy to seal
- works with existing fittings
- *plated steel and / or iron*
- use with Boss clamps found on pages 111 and 112.



complete female



stem



wing nut



knurled nut

Hose Shank x NPT	Part #	Price/E	Part #	Price/E	Opt Qty	Part #	Price/E	Opt Qty	Part #	Price/E	Opt Qty
1/4"	GF1 ¹	\$49.30	GBA	\$18.75	100	SLS4	\$12.10	100	---	---	--
3/8"	GF3 ¹	42.45	GCA	8.90	100	CB	11.80	100	---	---	--
1/2"	GF6	33.25	GB1	7.40	100	B2	7.60	100	---	---	--
1/2" x 3/4"	GF26-1	43.10	GB6-1	17.20	50	B12	10.00	25	---	---	--
3/4"	GF26	40.40	GB6	14.50	50	B12	10.00	25	KB12	\$15.45	25
1"	GF36	41.70	GB11	15.20	50	B12	10.00	25	KB12	15.45	25
1 1/4"	GF51	77.25	GB16	23.60	25	B17	18.45	25	---	---	--
1 1/2"	GF61	73.85	GB21	21.80	25	B17	18.45	25	---	---	--
2"	GF81 ²	88.60	GB26 ²	24.30	10	B27	29.45	10	---	---	--
2 1/2"	GF96	215.50	GB31	56.85	5	B32	68.80	5	---	---	--
3"	GF111	225.20	GB36 ³	80.00	5	B37	59.30	5	---	---	--
4"	GF141	500.00	GB46	160.60	5	B47	168.00	5	---	---	--
6"	GF201 ¹	1183.25	GB66	365.00	2	B67	248.25	2	---	---	--

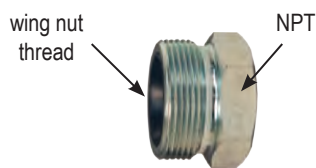
¹ 1/4", 3/8" and 6" available only with copper seat spuds² not to be used with #250, #275 or #306 Boss clamps³ GB36 will be replaced with GB36CR, this replacement part will have a machined hose shank to accommodate a Boss clamp, King Crimp sleeve or ferrule

female spud



male spud

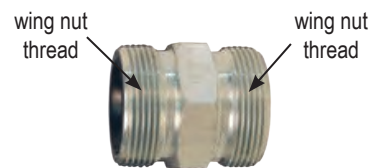

double spud

Thread	Part #	Price/E	Opt Qty	Part #	Price/E	Part #	Price/E
1/4"	GBC ¹	\$18.65	100	---	---	---	---
3/8"	GCC ¹	21.95	100	GMC ¹	\$20.00	---	---
1/2"	GB3	18.25	100	GM3	22.90	GDB3	\$35.15
3/4"	GB8	15.90	50	GM8	21.70	GDB13	35.40
1"	GB13	16.50	50	GM13	22.90	GDB13	35.40
1 1/4"	GB18	36.20	25	GM18	51.85	GDB23	61.50
1 1/2"	GB23	33.60	25	GM23	50.00	GDB23	61.50
2"	GB28	34.85	10	GM28	54.00	GDB28	66.25
2 1/2"	GB33	89.85	5	GM33	128.10	GDB33	131.35
3"	GB38	97.10	5	GM38	134.70	GDB38	137.70
4"	GB48	171.40	5	---	---	---	---
6"	GB68 ¹	570.00	2	---	---	---	---

¹ 1/4", 3/8" and 6" available only with copper seat spuds

A list of products recommended for steam service can be found on page 103.

Boss Holedall Fittings

Applications:

- designed for air and liquid applications where a permanent, low profile clamping system is desired
- not for steam service 

Features:

- supplied with carbon steel ferrules
- consult Dixon for swage and/or crimp specifications

Size	Hose OD		Plated Iron / Steel		Stainless Steel	
	From:	To:	Part #	Price/E	Part #	Price/E
¾"	1-10/64"	1-14/64"	GF26P1	\$58.15	---	---
	1-15/64"	1-18/64"	GF26P2	58.15	---	---
	1-19/64"	1-22/64"	GF26P3	58.15	---	---
1"	1-30/64"	1-34/64"	GF36P1	61.55	---	---
	1-35/64"	1-38/64"	GF36P2	61.55	---	---
	1-39/64"	1-42/64"	GF36P3	61.55	---	---
1½"	1-20/64"	2"	GF61P1	125.35	RGF61P1	\$440.00
	2-1/64"	2-8/64"	GF61P2	125.35	RGF61P2	440.00
	2-9/64"	2-16/64"	GF61P3	125.35	---	---
2"	2-36/64"	2-40/64"	GF81P1	128.75	RGF81P1	580.00
	2-41/64"	2-48/64"	GF81P2	128.75	RGF81P2	580.00
	2-49/64"	2-56/64"	GF81P3	128.75	---	---
3"	3-26/64"	3-40/64"	GF111P1	355.00	---	---
	3-41/64"	3-48/64"	GF111P2	355.00	---	---
	3-49/64"	3-56/64"	GF111P3	355.00	---	---



E

Boss Adapters

Features:

- plated steel and / or iron
- designed to fit the standard ground joint spuds on page 106
- supplied with a wing nut, as shown
- for safety tags and safety tape, see page 778

male NPT adapters

Size	Part #	Price/E	Pkg Qty
¾"	GMAS6	\$51.50	25
1"	GMAS11	53.70	25
1¼"	GMAS16	74.00	10
1½"	GMAS21	88.85	10
2"	GMAS26 ¹	92.50	10

¹ uses a special wing nut, part # B27-3

female NPT adapters

Size	Part #	Price/E
¾"	GFAS6	\$101.40
1"	GFAS11	110.00
1¼"	GFAS16	125.00
1½"	GFAS21 ¹	150.00
2"	GFAS26	162.00

¹ part is produced as a welded fabrication



Boss Wing Nut Caps

Features:

- plated steel and / or iron
- supplied with 12" chain and washer
- for best results, use with washer style spuds and washers on pages 108 and 109



Boss wing nut caps are not intended for pressure applications.

Size	Part #	Price/E	Opt Qty
¾" and 1"	B12SC	\$44.60	25
1¼" and 1½"	B17SC	55.30	25
2"	B27SC	82.25	10
3"	B37SC	131.25	5



316 Stainless Steel Ground Joint

Application:

- recommended for steam service up to 450°F

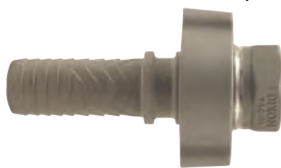

E

complete female

stem

wing nut

female spud

Size	Part #	Price/E	Part #	Price/E	Part #	Price/E	Part #	Price/E
¾"	RGF26	\$219.30	RGB6	\$78.25	RB12	\$70.00	RGB8	\$71.05
1"	RGF36	240.70	RGB11	98.90	RB12	70.00	RGB13	71.80
1¼"	RGF51	354.75	RGB16	109.45	RB17	115.30	RGB18	130.00
1½"	RGF61	426.15	RGB21	118.45	RB17	115.30	RGB23	192.40
2"	RGF81 ¹	560.00	RGB26 ¹	173.00	RB27	194.60	RGB28	192.40



¹ not to be used with #250, #275 or #306 Boss clamps

Brass Ground Joint

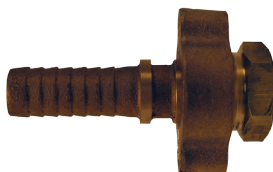

complete female

stem

wing nut

female spud

Size	Part #	Price/E	Part #	Price/E	Part #	Price/E	Part #	Price/E
¾"	BGF26	\$156.95	BGB6	\$60.80	BB12	\$47.70	BGB8	\$48.45
1"	BGF36	174.30	BGB11	56.60	BB12	47.70	BGB13	70.00
1¼"	BGF51	227.60	BGB16	56.70	BB17	81.00	BGB18	89.90
1½"	BGF61	260.20	BGB21	77.50	BB17	81.00	BGB23	101.70
2"	BGF81 ¹	437.80	BGB26 ¹	142.00	BB27	155.40	BGB28	140.40



¹ not to be used with #250, #275 or #306 Boss clamps

316 Stainless Steel Washer Style



complete female

stem

wing nut

female spud

washer²

Size	Part #	Price/E	Part #	Price/E	Part #	Price/E	Part #	Price/E	Part #	Price/E
¾"	RWF26	\$223.60	RB6	\$76.05	RB12	\$70.00	RB8	\$76.60	W12	\$0.95
1"	RWF36	233.15	RB11	84.80	RB12	70.00	RB13	77.40	W12	0.95
1¼"	RWF51	347.30	RB16	122.70	RB17	115.30	RB18	108.00	W17	1.30
1½"	RWF61	440.40	RB21	136.30	RB17	115.30	RB23	187.50	W17	1.30
2"	RWF81 ¹	559.45	RB26 ¹	177.00	RB27	194.60	RB28	186.40	W27	1.45



¹ not to be used with #250, #275 or #306 Boss clamps

² washer is nitrile rubber bonded, non-asbestos Klingsil® C-4401

- brass Washer Style available, consult Dixon for pricing and availability

Boss Washer Seal

Features:

- recommended for steam service up to **450°F**
- easy to seal
- Klingsil® C-4401 washer is inserted between the stem and spud
- leakproof seal forms by rotating the wing nut and hammering it tight
- works with existing fittings
- plated steel and / or iron*
- use with Boss clamps found on pages 111 and 112

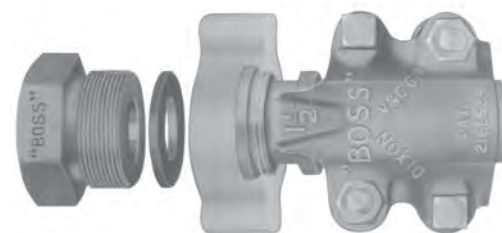

E

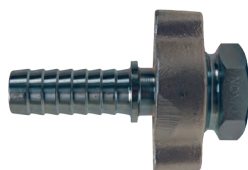

complete female



stem



wing nut



knurled nut

Hose Shank x NPT	Part #	Price/E	Part #	Price/E	Opt Qty	Part #	Price/E	Opt Qty	Part #	Price/E	Opt Qty
3/8"	WF3	\$32.80	SS337	\$7.45	100	CB	\$11.80	100	---	---	---
1/2"	WF6	32.35	B1	11.75	100	B2	7.60	100	---	---	---
1/2" x 3/4"	WF26-1	43.15	B6-1	19.15	50	B12	10.00	25	---	---	---
3/4"	WF26	38.60	B6	14.60	50	B12	10.00	25	KB12	\$15.45	25
1"	WF36	39.55	B11	15.75	50	B12	10.00	25	KB12	15.45	25
1-1/4"	WF51	84.80	B16	30.55	25	B17	18.45	25	---	---	---
1-1/2"	WF61	74.60	B21	24.40	25	B17	18.45	25	---	---	---
2"	WF81 ¹	93.05	B26 ¹	27.20	10	B27	29.45	10	---	---	---
2-1/2"	WF96	219.85	B31	67.90	5	B32	68.80	5	---	---	---
3"	WF111	230.40	B36	80.40	5	B37	59.30	5	---	---	---



¹ not to be used with #250, #275 or #306 Boss clamps

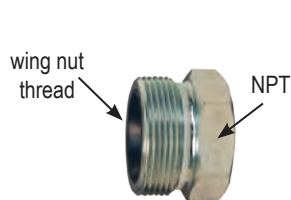

female spud

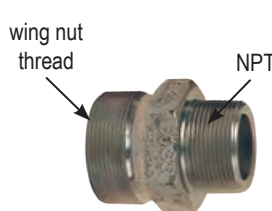

male spud

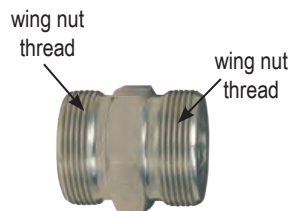

double spud

washer¹

Thread	Part #	Price/E	Opt Qty	Part #	Price/E	Part #	Price/E	Part #	Price/E
3/8"	CC	\$12.85	100	WMC	\$15.20	---	---	WBC	\$0.70
1/2"	B3	12.20	100	WM3	26.55	DB3	\$23.60	W2	0.80
3/4"	B8	13.05	25	WM8	19.45	DB13	27.90	W12	0.95
1"	B13	12.85	50	WM13	23.20	DB13	27.90	W12	0.95
1-1/4"	B18	34.50	25	WM18	45.30	DB23	42.30	W17	1.30
1-1/2"	B23	30.45	25	WM23	53.85	DB23	42.30	W17	1.30
2"	B28	34.95	10	WM28	60.00	DB28	56.90	W27	1.45
2-1/2"	B33	81.50	5	---	---	---	---	W32	1.65
3"	B38	88.10	5	WM38	130.00	DB38	115.65	W37	2.60

¹ washer is nitrile rubber bonded, non-asbestos Klingsil® C-4401

Boss Male Stems

Features:

- recommended for steam service up to **450°F**
- use with Boss clamps on pages 111 and 112; for safety tags and safety tape see page 778



plated steel barstock



plated iron



316 stainless



brass

E

Hose x NPT Size	Plated Steel Bar Stock		Opt Qty	Size	Plated Iron		Opt Qty	Size	316 Stainless		Size	Brass	
	Part #	Price/E			Part #	Price/E			Part #	Price/E		Part #	Price/E
¼" x ⅛"	MS4X2	\$9.60	25	---	---	---	---	½"	RMS1	\$63.55	---	---	---
¼" x ¼"	MSA	7.45	50	---	---	---	---	¾"	RMS6	62.50	¾"	BMS6	\$39.85
¼" x ⅜"	MSB	8.50	25	---	---	---	---	1"	RMS11	64.00	1"	BMS11	54.95
⅜" x ¼"	MS6X4	8.00	25	1¼"	MS16	\$24.00	20	1¼"	RMS16	122.00	1¼"	BMS16	74.80
⅜" x ⅜"	MSC	6.40	100	1½"	MS21	26.90	20	1½"	RMS21	122.50	1½"	BMS21	90.40
⅜" x ½"	MS6X8	11.10	25	2"	MS26	37.50	10	2"	RMS26	133.40	2"	BMS26	139.40
½" x ¼"	MS8X4	7.85	25	2½"	MS31	66.60	5	2½"	RMS31	250.00	---	---	---
½" x ⅜"	MS8X6	7.85	50	3"	MS36	90.50	5	3"	---	---	3"	BMS36	322.50
½" x ½"	MS1	6.45	25	4"	MS46	153.00	2	4"	---	---	---	---	---
½" x ¾"	MS8X12	19.10	25	---	---	---	---	---	---	---	---	---	---
¾" x ½"	MS12X8	14.70	25	---	---	---	---	---	---	---	---	---	---
¾" x ¾"	MS6	9.85	25	---	---	---	---	---	---	---	---	---	---
¾" x 1"	MS12X16	22.00	25	---	---	---	---	---	---	---	---	---	---
1" x ¾"	MS16X12	22.00	25	---	---	---	---	---	---	---	---	---	---
1" x 1"	MS11	14.35	25	---	---	---	---	---	---	---	---	---	---

LP-Boss Male Stems



male NPT end



beveled end

Size	Plated Steel		316 Stainless		Schedule 80 Plated Steel		Unplated Steel	
	Part #	Price/E	Part #	Price/E	Part #	Price/E	Part #	Price/E
1¼"	LP16	\$63.00	---	---	LP16-80 ¹	\$66.50	---	---
1½"	LP21	60.00	---	---	LP21-80 ¹	69.00	---	---
2"	LP26	53.20	---	---	LP26-80 ¹	71.85	LPB26	\$65.25
2½"	LP31	126.50	---	---	---	---	---	---
3"	LP36	125.00	RLP36	\$221.40	---	---	LPB36	115.40
4"	LP46	164.00	RLP46	375.00	---	---	---	---
6"	LP66	340.00	---	---	---	---	---	---

¹ schedule 80 stems meet NFPA 58

Boss Hose Menders

Features:

- collars designed to engage gripping fingers of Boss clamps
- 3/4" - 3" plated iron; 1/2" plated steel



Size	Part #	Price/E	Size	Part #	Price/E
1/2"	M1	\$10.40	1 1/2"	M21	\$21.35
3/4"	M6	18.60	2"	M26	37.35
1"	M11	29.80	2 1/2"	M31	64.50
1 1/4"	M16	22.20	3"	M36	77.30

Boss Spud x Hose Shank

Feature:

- polymer seat



Size	Part #	Steel	Price/E
1"	GH1311		\$38.20
2"	GH2826		79.00

Boss Clamps

⚠ WARNING

- The bolts used in the Boss interlocking clamps are not standard bolts. They vary from standard bolts in their length, diameter, overall thread length and material hardness. These bolts can be retorqued, but it is **not** recommended that the bolts or clamps be reused, as they are designed for a single bend only. Dixon recommends using only factory supplied replacement bolts.
- Torque values for clamps are based on dry bolts. The use of lubricant on bolts will adversely effect clamp performance. *Do not lubricate nuts and bolts.*
- recommended for steam service up to **450°F**
- recommended torque rating in ft. lbs.
- replacement nuts and bolts are available, contact Dixon for more information
- see page 812 for Fraction to Decimal conversion chart

E

Hose ID	Hose OD		Zinc Plated Iron		Opt Qty	Stainless Steel		Torque ³	Brass		Torque
	From:	To:	Part #	Price/E		Part #	Price/E		Part #	Price/E	
¼"	36/64"	42/64"	BD ⁴	\$9.05	100	---	---	6	---	---	--
⅜"	44/64"	56/64"	CD ⁴	8.75	100	---	---	6	---	---	--
½"	52/64"	60/64"	DD ⁴	9.45	100	---	---	6	---	---	--
½"	58/64"	1-2/64"	968 ¹	14.90	50	---	---	6	---	---	--
½"	60/64"	1-4/64"	B4 ⁴	8.15	25	RB4	\$138.40	12	BB4	\$31.75	10
½"	1-4/64"	1-12/64"	B5	10.05	25	---	---	12	---	---	--
¾"	1-10/64"	1-20/64"	BU9 ⁴	10.25	50	RBU9	184.00	21	BBU9	45.60	18
¾"	1-20/64"	1-32/64"	B9	11.60	25	RB9	197.80	21	---	---	18
¾"	1-32/64"	1-44/64"	B10 ⁴	12.95	25	---	---	21	---	---	--
1"	1-26/64"	1-36/64"	156 ¹	19.85	20	---	---	21	---	---	--
1"	1-34/64"	1-46/64"	BU14	19.85	25	RBU14	192.40	21	BBU14	91.80	18
1"	1-44/64"	1-60/64"	B14	19.80	25	RB14	192.40	21	BB14	105.25	18
1"	1-60/64"	2-8/64"	B15	22.70	20	---	---	21	---	---	--
1-¼"	1-32/64"	1-50/64"	BU18	32.20	10	---	---	40	---	---	--
1-¼"	1-44/64"	1-56/64"	187 ¹	29.50	10	---	---	21	---	---	--
1-¼"	1-50/64"	2-6/64"	BU19	35.80	10	---	---	40	---	---	--
1-¼"	1-56/64"	2-4/64"	206 ¹	25.70	20	---	---	21	---	---	--
1-¼"	2-8/64"	2-24/64"	B19	29.45	10	RB19	207.70	40	---	---	28
1-½"	1-52/64"	2"	BU22	36.90	10	---	---	40	---	---	--
1-½"	2"	2-14/64"	B22	34.40	10	---	---	40	---	---	--
1-½"	2"	2-8/64"	212 ¹	35.25	10	---	---	21	---	---	--
1-½"	2-4/64"	2-16/64"	225 ¹	37.15	10	---	---	40	---	---	--
1-½"	2-12/64"	2-24/64"	BU24	30.20	10	RBU24	211.05	40	---	---	28
1-½"	2-24/64"	2-36/64"	B24	27.75	10	RB24	204.00	40	---	---	--
1-½"	2-36/64"	2-48/64"	B25	31.70	10	---	---	40	---	---	--
2"	2-16/64"	2-32/64"	250 ^{1,5}	37.80	10	---	---	40	---	---	--
2"	2-22/64"	2-34/64"	BU28	41.10	10	---	---	60	---	---	--
2"	2-32/64"	2-48/64"	275 ^{1,5}	42.25	10	---	---	40	---	---	--
2"	2-32/64"	2-50/64"	BU29	36.60	10	RBU29	295.00	60	BBU29 ²	173.05	40
2"	2-48/64"	3-4/64"	B29	40.30	10	RB29	309.00	60	---	---	--
2"	2-48/64"	3-4/64"	306 ^{1,5}	51.00	10	---	---	60	---	---	--
2"	3-6/64"	3-28/64"	B30	63.60	5	---	---	60	---	---	--
2-½"	3-4/64"	3-32/64"	350 ¹	53.30	5	---	---	60	---	---	--
2-½"	3-6/64"	3-28/64"	BU34	66.80	5	---	---	60	---	---	--
2-½"	3-32/64"	3-60/64"	B34	86.35	5	---	---	150	---	---	--
3"	3-32/64"	3-48/64"	375 ¹	67.25	5	---	---	60	---	---	--
3"	3-32/64"	3-60/64"	BU35	97.25	5	RBU35	461.70	150	---	---	--
3"	3-48/64"	4"	401 ¹	111.00	5	---	---	150	---	---	--
3"	3-52/64"	4-4/64"	B35	92.30	5	---	---	150	---	---	--
3"	4"	4-12/64"	418 ¹	125.45	4	---	---	200	---	---	--
3"	4-4/64"	4-28/64"	B39	119.00	5	---	---	200	---	---	--
3"	4-12/64"	4-32/64"	450 ¹	124.40	2	---	---	200	---	---	--



two clamp sections
2-bolt type
2 gripping fingers
¼" - ¾" design



two clamp sections
4-bolt type
2 gripping fingers



two clamp sections
4-bolt type
4 gripping fingers

¹ 4 gripping fingers and 4 bolts

² will become obsolete as inventory is depleted

³ torque applies to plated iron and stainless steel clamps

⁴ global investment cast carbon steel

⁵ not to be used with GF81, GB26, WF81, B26, RGF81, RGB26, BGF81, BGB26, RWF81, RB26



Boss Clamps

⚠ WARNING

three clamp sections
6-bolt type
3 gripping fingers



three clamp sections
6-bolt type
6 gripping fingers

- The bolts used in the Boss interlocking clamps are not standard bolts. They vary from standard bolts in their length, diameter, overall thread length and material hardness. These bolts can be retorqued, but it is **not** recommended that the bolts or clamps be reused, as they are designed for a single bend only. Dixon recommends using only factory supplied replacement bolts.
- Torque values for clamps are based on dry bolts. The use of lubricant on bolts will adversely effect clamp performance. *Do not lubricate nuts and bolts.*
- recommended for steam service up to **450°F**
- recommended torque rating in ft. lbs.
- replacement nuts and bolts are available, contact Dixon for more information
- see page 812 for Fraction to Decimal conversion chart

Hose ID	Hose OD		Zinc Plated Iron		Opt Qty	Torque
	From:	To:	Part #	Price/E		
3"	4-16/64"	4-52/64"	BS39	\$223.85	2	150
4"	4-40/64"	5"	B45	224.00	2	150
4"	4-56/64"	5-16/64"	BS49	339.60	2	200
4"	5-16/64"	5-38/64"	BU49	412.00	2	200
4"	5-34/64"	5-60/64"	B49	429.00	2	200
6"	6-56/64"	7-24/64"	750	419.00	1	200
6"	7-32/64"	8"	850	413.50	1	200

Ground Joint Air Hammer Couplings

Features:

- rounded steel head of stem fits concave inserts in spuds for superior sealing
- metal-to-metal copper seat seal
- plated steel* and / or *iron*
- for use with Boss clamps on page 111



complete female



stem



wing nut

Style	Hose ID and NPT Sizes	Coarse Nut Thread	Part #	Price/E	Plated Steel		Iron	
					Part #	Price/E	Part #	Price/E
Compact	1/2"	1-31/64" OD x 8 TPI	GDF6	\$45.00	GBA45	\$13.00	J47	\$11.65
	3/4"		GDF8	48.65	GBA46	13.80	J47	11.65
Heavy Duty	3/4"	1-47/64" OD x 8 TPI	GDF10	64.45	GBB18	22.00	DLB12	15.20
	1"		GDF12	54.85	GBB11	17.40	DLB12	15.20



female spud



male spud



double spud

Style	Hose ID and NPT Sizes	Coarse Nut Thread	Plated Steel w/ Copper seat		Plated Steel w/ Copper seat		Plated Steel w/ Copper seat	
			Part #	Price/E	Part #	Price/E	Part #	Price/E
Compact	1/2"	1-31/64" OD x 8 TPI	GJ65	\$20.35	GJ60	\$27.40	GJ75	\$32.50
	3/4"		GJ55	23.60	GJ50	25.10	GJ75	32.50
Heavy Duty	3/4"	1-47/64" OD x 8 TPI	GDL8	27.25	GDL7	33.80	GDL25	34.80
	1"		GDL13	22.70	GDL10	30.55	GDL25	34.80