

Dixon

C



Features:

- precision machined to rigid tolerances
- durable stainless steel cam arm pins will not rust or bind, providing greater strength and safety
- recess holds gasket firmly in place - ensures proper placement
- long shank design allows proper banding, thus eliminating the major cause of hose damage

Boss-Lock

Features:

- The cast-in lugs allow safety clips to be attached once the lugs are passed through slots in the special cam lever arms providing a patented safety feature. The clips prevent the coupler from being unlocked until they are removed, providing a *positive locking action*.
- Boss-Lock investment stainless steel cam arms are guaranteed! Should you break a Boss-Lock investment stainless steel cam arm, return it to the nearest warehouse for a free replacement.
- The pull ring safety clip simplifies the locking action on Boss-Lock couplers. No more inserting clips or dangling lanyards, just a twist and it's locked, giving you a low profile positive locking action.



pull ring safety clip



EZ Boss-Lock

Features:

- no more fumbling with clamps, wire, clips or pins, just close the handles and the locking mechanism is engaged
- extremely easy to open, the release lever is under your thumb when you want to open the fitting, ergonomic
- resistant to accidental disconnection when being dragged; the release lever opens in the direction opposite to the cam arm, so movements that can open the release lever also can close the cam arm
- if the rotating lever is not flush with the handle, it is not properly engaged
- no sliding pins to jam or pop open
- rotating action helps keep the locking device free of debris
- rugged design protects critical parts from impact
- can be supplied with custom shanks, also available with swaged and PF shanks for hard to couple chemical hoses
- assemblies are investment cast stainless steel with plated carbon steel pull rings
- small OD makes it easy to insert into the hose tubes on tank trucks and to use in restricted spaces
- assemblies can be retrofitted onto undamaged stainless steel Boss-Lock allowing you to protect your investment in stainless steel Boss-Lock couplings while you upgrade
- made in the USA



King Crimp System Cam & Groove



Dixon Type C domestic coupler



EZ Boss-Lock Type C domestic coupler



Type C global coupler



Type E domestic adapter



Type E global adapter

- for a complete listing of the King Crimp System products, including Cam and Groove fittings, please reference pages 12-21



Ordering System

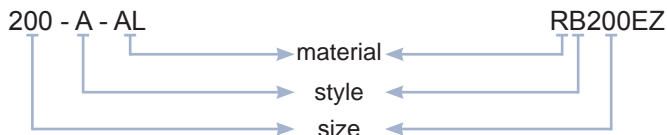

Operation of Cam and Groove

- To make connection, simply slide the adapter into the coupler and with normal hand pressure, press the cam levers down.
- Uncoupling is as quick and simple as coupling. Just lift the cam arms and remove the adapter.

Size represents the coupler or adapter and hose or pipe end. (i.e. 200 = 2") If the coupling is a reducing size, the coupler or adapter is the first size. (i.e. 4030-C is 4" coupler to 3" hose shank).

Specifications on Dixon Cam and Groove

Specifications:

- Dixon, Boss-Lock and EZ Boss-Lock cam and groove couplers and adapters are produced to interchange with all product produced to Commercial Item Description A-A-59326D.
- No standard exists for the 1/2" and 8" fittings, and generally these sizes do not interchange with other manufacturers.
- Dust caps and dust plugs are **not** to be used in pressure applications for safety and environmental reasons.
- Designed for use with liquids, consult Dixon for specific recommendations.

Pressure Ratings:

 Recommendations based on the use of mating Dixon fittings at ambient temperature (70°F) with standard Buna-N seal installed. For use at elevated temperature or other unusual operating conditions, consult Dixon. Dixon, Boss-Lock and EZ Boss-Lock couplers and adapters maximum working pressure are as follows:

Size	1/2"	3/4" thru 2"	2 1/2"	3"	4"	5" and 6"	8"
PSI	150	250	150	125	100	75	50

Cam and Groove Line Drawings

Line drawings are representative of the Dixon line of cam and groove.

C

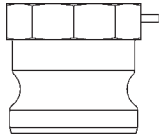

Type A
male adapter x female NPT

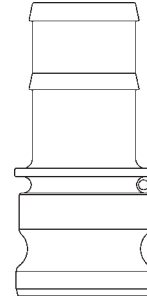

Type E
male adapter x hose shank

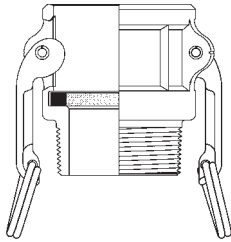

Type B
female coupler x male NPT

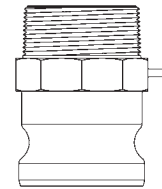

Type F
male adapter x male NPT

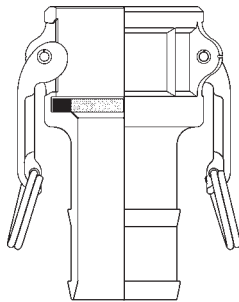

Type C
female coupler x hose shank

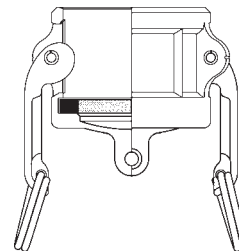

Type DC¹
dust cap

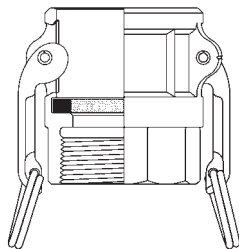

Type D
female coupler x female NPT

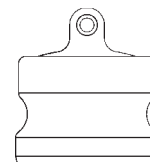

Type DP¹
dust plug



¹ Dust caps and dust plugs are **not** to be used in pressure applications for safety and environmental reasons.

⚠ WARNING

Under no circumstances should cam and groove couplings be used for compressed air or steam service!

Dixon / Boss-Lock Type A Adapters

female NPT x male adapter

Feature:

- Pressure rating is based on the seal of the mating part. See ratings on page 29.

C

356T6 aluminum



aluminum hard coat



brass

Size	356T6 Aluminum		Aluminum Hard Coat		Brass	
	Part #	Price/E	Part #	Price/E	Part #	Price/E
1/2"	50-A-AL ²	\$11.00	---	---	50-A-BR	\$18.50
3/4" x 1/2"	7550-A-AL ²	15.25	---	---	7550-A-BR	36.70
3/4"	75-A-AL ²	10.20	---	---	75-A-BR	23.10
1"	100-A-AL ²	12.85	---	---	100-A-BR	26.20
1 1/4"	125-A-AL	16.50	---	---	125-A-BR	43.00
1 1/2"	150-A-AL	17.60	150-A-ALH	\$30.30	150-A-BR	43.95
2"	200-A-AL	18.80	200-A-ALH	34.60	200-A-BR	55.60
2 1/2"	250-A-AL	28.90	---	---	250-A-BR	98.50
3"	300-A-AL	27.95	300-A-ALH	47.00	300-A-BR	112.25
4"	400-A-AL	62.80	400-A-ALH	97.00	400-A-BR	190.00
5"	500-A-AL	102.00	---	---	500-A-BR	298.90
6"	600-A-AL	122.80	600-A-ALH	188.00	600-A-BR	397.00
8" DIX	800-A-AL ¹	341.25	---	---	---	---
8" BL	801-A-AL ¹	357.95	---	---	---	---



¹ Dixon and Boss-Lock cam and groove couplings *do not interchange in the 8" and 1/2" sizes.*

² made from 6061-T6 aluminum



unplated malleable iron



plated malleable iron



316 stainless

Size	Unplated Malleable Iron		Plated Malleable Iron		316 Stainless Steel	
	Part #	Price/E	Part #	Price/E	Part #	Price/E
1/2"	---	---	---	---	50-A-SS	\$45.45
3/4" x 1/2"	---	---	---	---	7550-A-SS	67.70
3/4"	---	---	75-A-PM	\$16.95	75-A-SS	46.75
1"	---	---	100-A-PM	18.50	100-A-SS	49.40
1 1/4"	---	---	---	---	125-A-SS	61.30
1 1/2"	150-A-MI	\$26.00	150-A-PM	29.00	150-A-SS	59.40
2"	200-A-MI	32.10	200-A-PM	34.10	200-A-SS	63.00
2 1/2"	---	---	---	---	250-A-SS	198.75
3"	300-A-MI	50.80	300-A-PM	55.50	300-A-SS	120.00
4"	400-A-MI	82.00	400-A-PM	86.60	400-A-SS	222.00
5"	500-A-MI	173.25	---	---	500-A-SS	346.00
6"	---	---	600-A-PM ¹	190.00	600-A-SS	384.80

¹ ductile iron

Dixon Type B Couplers

female coupler x male NPT

C

Features:

- Finger rings are not supplied on ½" - 1" Dixon couplings.
- ½" Dixon coupler has only one cam arm.
- Couplers are supplied standard with a Buna-N gasket. Other gasket types are available on pages 74-76.



356T6 aluminum



aluminum hard coat



brass

Size	356T6 Aluminum		Aluminum Hard Coat		Brass	
	Part #	Price/E	Part #	Price/E	Part #	Price/E
½"	50-B-AL	\$25.60	---	---	50-B-BR	\$40.50
¾"	75-B-AL	25.75	---	---	75-B-BR	46.10
1"	100-B-AL	26.90	---	---	100-B-BR	51.00
1¼"	125-B-AL	43.60	---	---	---	---
1½"	150-B-AL	28.00	150-B-ALH	\$47.50	150-B-BR	76.25
2"	200-B-AL	35.10	200-B-ALH	54.00	200-B-BR	87.00
2½"	250-B-AL	66.00	---	---	---	---
3"	300-B-AL	56.25	300-B-ALH	81.30	300-B-BR	167.40
4"	400-B-AL	80.80	400-B-ALH	122.00	400-B-BR	228.00
5"	500-B-AL	140.90	---	---	---	---
6"	600-B-AL	186.80	600-B-ALH	267.00	---	---
8"	800-B-AL ^{1,2}	1030.00	---	---	---	---



¹ Dixon and Boss-Lock cam and groove couplings *do not interchange in the 8" and ½" sizes.*

The 8" Dixon design has 4 cam arms, Boss-Lock design has 2 cam arms.

² Parts are produced as a welded fabrication.



unplated malleable iron



316 stainless

Size	Unplated Malleable Iron		316 Stainless Steel	
	Part #	Price/E	Part #	Price/E
½"	---	---	50-B-SS	\$74.80
¾"	---	---	75-B-SS	73.40
1"	---	---	100-B-SS	81.00
1¼"	---	---	---	---
1½"	150-B-MI ¹	\$57.95	150-B-SS	105.80
2"	200-B-MI	68.50	200-B-SS	119.60
2½"	---	---	250-B-SS	284.00
3"	300-B-MI ¹	105.00	300-B-SS	225.00
4"	400-B-MI	150.30	400-B-SS	275.00
6"	---	---	600-B-SS	782.00

¹ ductile iron

Boss-Lock Type B Couplers

female coupler x male NPT

Features:

- All Boss-Lock couplers are supplied with safety clips.
- Couplers are supplied standard with a Buna-N gasket. Other gasket types are available on pages 74-76.

C



356T6 aluminum



brass



plated malleable iron



316 stainless

Size	356T6 Aluminum		Brass		Plated Malleable Iron		316 Stainless Steel	
	Part #	Price/E	Part #	Price/E	Part #	Price/E	Part #	Price/E
3/4" x 1/2"	---	---	---	---	---	---	RB050BL	\$98.25
3/4"	---	---	BB075	69.00	---	---	RB075BL	91.30
1"	AB100	\$44.10	BB100	73.60	IB100	\$60.00	RB100BL	93.75
1 1/4"	AB125	48.10	BB125	88.30	---	---	RB125BL	127.00
1 1/2"	AB150	44.40	BB150	96.30	---	---	RB150BL	128.00
2"	AB200	44.25	BB200	114.00	IB200	81.25	RB200BL	136.25
2 1/2"	AB250	65.50	BB250	146.50	---	---	---	---
3"	AB300	75.25	BB300	205.00	---	---	RB300BL	256.00
4"	AB400	105.00	BB400	295.00	---	---	RB400BL	296.00
6"	AB600	275.00	---	---	---	---	---	---

EZ Boss-Lock Type B Couplers

female coupler x male NPT

Features:

- Couplers are supplied standard with a Buna-N gasket. Other gasket types are available on pages 74-76.
-  Under no circumstances should the EZ Boss-Lock cam arms be used on any fitting not specifically designed for their use. See pages 28 and 72 for further specifications.



356T6 aluminum



brass



316 stainless

Size	356T6 Aluminum		Brass		316 Stainless Steel	
	Part #	Price/E	Part #	Price/E	Part #	Price/E
3/4" x 1/2"	---	---	---	---	RB050EZ	\$119.00
3/4"	---	---	BB075EZ	\$94.00	RB075EZ	104.00
1"	AB100EZ	\$69.20	BB100EZ	116.00	RB100EZ	109.70
1 1/4"	---	---	BB125EZ	126.00	RB125EZ	142.10
1 1/2"	AB150EZ	79.75	BB150EZ	138.00	RB150EZ	143.65
2"	AB200EZ	81.30	BB200EZ	156.80	RB200EZ	157.00
3"	AB300EZ	120.75	BB300EZ	275.60	RB300EZ	272.95
4"	AB400EZ	152.50	BB400EZ	360.00	RB400EZ	325.00
6"	---	---	---	---	RB600EZ	595.30

Dixon Type C Couplers

female coupler x hose shank

- C** **Features:**
- Finger rings are not supplied on 1/2" - 1" Dixon couplings.
 - 1/2" Dixon coupler has only one cam arm.
 - Couplers are supplied standard with a Buna-N gasket. Other gasket types are available on pages 74-76.



356T6 aluminum



aluminum hard coat



brass

Size	356T6 Aluminum		Aluminum Hard Coat		Brass	
	Part #	Price/E	Part #	Price/E	Part #	Price/E
1/2"	50-C-AL	\$21.50	---	---	50-C-BR	\$46.40
3/4"	75-C-AL	24.70	---	---	75-C-BR	50.95
1"	100-C-AL	26.25	---	---	100-C-BR	60.50
1 1/4"	125-C-AL	57.00	---	---	125-C-BR	88.00
1 1/2"	150-C-AL	33.40	150-C-ALH	\$44.70	150-C-BR	83.60
2"	200-C-AL	37.25	200-C-ALH	55.90	200-C-BR	103.30
2 1/2"	250-C-AL	67.60	---	---	250-C-BR	136.00
3"	300-C-AL	58.60	300-C-ALH	85.80	300-C-BR	189.00
4"	400-C-AL	79.60	400-C-ALH	111.40	400-C-BR	238.00
5"	500-C-AL	123.85	---	---	---	---
6"	600-C-AL	191.20	600-C-ALH	251.00	600-C-BR	795.00
8"	800-C-AL ¹	757.00	---	---	---	---



¹ Dixon and Boss-Lock cam and groove couplings *do not interchange in the 8" and 1/2" sizes.* The 8" Dixon design has 4 cam arms, Boss-Lock design has 2 cam arms.



unplated malleable iron



316 stainless

Size	Unplated Malleable Iron		316 Stainless Steel	
	Part #	Price/E	Part #	Price/E
1/2"	---	---	50-C-SS	\$57.60
3/4"	---	---	75-C-SS	69.10
1"	---	---	100-C-SS	79.30
1 1/4"	---	---	125-C-SS	135.00
1 1/2"	150-C-MI	\$50.25	150-C-SS	96.60
2"	200-C-MI	54.00	200-C-SS	114.25
2 1/2"	---	---	250-C-SS	284.00
3"	300-C-MI ²	87.00	300-C-SS	198.70
4"	400-C-MI ^{1,2}	112.20	400-C-SS	336.00
5"	---	---	500-C-SS	474.00
6"	600-C-MI ^{1,2}	210.00	600-C-SS	548.00

¹ Suitable for use with King Crimp sleeves and ferrules, see pages 14-18.

² ductile iron

Boss-Lock Type C Couplers

female coupler x hose shank

Features:

- All Boss-Lock couplers are supplied with safety clips.
- Couplers are supplied standard with a Buna-N gasket. Other gasket types are available on pages 74-76.



356T6 aluminum



brass



plated malleable iron



316 stainless

Size	356T6 Aluminum		Brass		Plated Malleable Iron		316 Stainless Steel	
	Part #	Price/E	Part #	Price/E	Part #	Price/E	Part #	Price/E
3/4" x 1/2"	---	---	---	---	---	---	RC050BL	\$91.00
3/4"	AC075	\$36.00	BC075	\$57.00	IC075	\$66.25	RC075BL	93.50
1"	AC100	37.30	BC100	70.00	IC100	52.80	RC100BL	97.20
1 1/4"	AC125	44.90	BC125	89.25	---	---	RC125BL	130.00
1 1/2"	AC150	42.70	BC150	94.00	IC150	63.00	RC150BLNO	118.00
2"	AC200	47.40	BC200	109.60	IC200	85.50	RC200BLNO	116.80
2 1/2"	AC250	56.75	BC250	165.00	---	---	---	---
3"	AC300	69.00	BC300	178.00	IC300	108.70	RC300BL	210.40
4"	AC400	97.60	BC400	303.00	IC400 ²	150.00	RC400BLNO	297.00
6"	AC600	213.00	BC600	710.00	IC600 ²	391.00	---	---
8"	AC800 ¹	568.00	---	---	---	---	---	---



¹ Dixon and Boss-Lock cam and groove couplings *do not interchange in the 8" and 1/2" sizes*. The 8" Dixon design has 4 cam arms, Boss-Lock design has 2 cam arms.

² ductile iron

EZ Boss-Lock Type C Couplers

female coupler x hose shank

Feature:

- Couplers are supplied standard with a Buna-N gasket. Other gasket types are available on pages 74-76.



356T6 aluminum



brass



316 stainless

Size	356T6 Aluminum		Brass		316 Stainless Steel	
	Part #	Price/E	Part #	Price/E	Part #	Price/E
3/4" x 1/2"	---	---	---	---	RC050EZ	\$107.00
3/4"	AC075EZ	\$60.80	BC075EZ	\$108.70	RC075EZ	99.00
1"	AC100EZ	68.80	BC100EZ	112.00	RC100EZCR	110.80
1 1/4"	---	---	BC125EZ	160.00	RC125EZCR	150.00
1 1/2"	AC150EZ	72.80	BC150EZ	129.00	RC150EZNO	113.75
2"	AC200EZ	78.40	BC200EZ	145.90	RC200EZNO	121.30
2 1/2"	AC250EZ	89.25	---	---	---	---
3"	AC300EZ	114.40	BC300EZ	235.00	RC300EZCR	210.00
4"	AC400EZ	146.00	BC400EZ	340.00	RC400EZCR	315.00
6"	AC600EZ	336.00	---	---	RC600EZCR	599.00
8"	AC800EZ ¹	600.00	---	---	---	---



¹ Dixon and Boss-Lock cam and groove couplings *do not interchange in the 8" and 1/2" sizes*. The 8" Dixon design has 4 cam arms, Boss-Lock design has 2 cam arms.

Under no circumstances should the EZ Boss-Lock cam arms be used on any fitting not specifically designed for their use.

See pages 28 and 72 for further specifications.

Dixon Type D Couplers

female coupler x female NPT

C Features:

- Finger rings are not supplied on ½" - 1" Dixon couplings.
- ½" Dixon coupler has only one cam arm.
- Couplers are supplied standard with a Buna-N gasket. Other gasket types are available on pages 74-76.



356T6 aluminum



aluminum hard coat



brass

Size	356T6 Aluminum		Aluminum Hard Coat		Brass	
	Part #	Price/E	Part #	Price/E	Part #	Price/E
½"	50-D-AL	\$25.80	---	---	50-D-BR	\$39.00
¾"	75-D-AL	25.60	---	---	75-D-BR	50.70
1"	100-D-AL	26.25	---	---	100-D-BR	49.60
1¼"	125-D-AL	49.50	---	---	125-D-BR	87.70
1½"	150-D-AL	31.95	150-D-ALH	\$51.25	150-D-BR	72.50
2"	200-D-AL	36.00	200-D-ALH	59.00	200-D-BR	91.00
2½"	250-D-AL	64.15	---	---	250-D-BR	137.45
3"	300-D-AL	55.00	300-D-ALH	81.60	300-D-BR	159.00
4"	400-D-AL	77.90	400-D-ALH	125.00	400-D-BR	239.00
5"	500-D-AL	130.00	---	---	500-D-BR	462.00
6"	600-D-AL	177.00	600-D-ALH	260.00	600-D-BR	645.00
8"	800-D-AL ¹	777.00	---	---	---	---



¹ Dixon and Boss-Lock cam and groove couplings *do not interchange in the 8" and ½" sizes*. The 8" Dixon design has 4 cam arms, Boss-Lock design has 2 cam arms.



unplated malleable iron



316 stainless

Size	Unplated Malleable Iron		316 Stainless Steel	
	Part #	Price/E	Part #	Price/E
½"	---	---	50-D-SS	\$70.60
¾"	---	---	75-D-SS	76.40
1"	---	---	100-D-SS	80.00
1¼"	---	---	125-D-SS	133.00
1½"	150-D-MI	\$55.00	150-D-SS	108.15
2"	200-D-MI	56.95	200-D-SS	117.70
2½"	---	---	250-D-SS	238.00
3"	300-D-MI	99.75	300-D-SS	219.30
4"	400-D-MI ¹	124.50	400-D-SS	306.00
5"	500-D-MI	211.00	500-D-SS	535.00
6"	---	---	600-D-SS	620.00

¹ ductile iron

Boss-Lock Type D Couplers

female coupler x female NPT

Features:

- All Boss-Lock couplers are supplied with safety clips.
- Couplers are supplied standard with a Buna-N gasket. Other gasket types are available on pages 74-76.



356T6 aluminum



brass



plated malleable iron



316 stainless

Size	356T6 Aluminum		Brass		Plated Malleable Iron		316 Stainless Steel	
	Part #	Price/E	Part #	Price/E	Part #	Price/E	Part #	Price/E
3/4" x 1/2"	AD050	\$46.40	BD050	\$61.95	---	---	RD050BL	\$105.00
3/4"	AD075	42.60	BD075	60.60	ID075	\$52.10	RD075BL	90.60
1"	AD100	39.20	BD100	66.50	ID100	55.30	RD100BL	92.20
1 1/4"	AD125	45.60	BD125	85.00	---	---	RD125BL	130.20
1 1/2"	AD150	43.00	BD150	82.00	ID150	65.00	RD150BL	119.40
2"	AD200	44.40	BD200	99.60	ID200	78.70	RD200BL	132.90
2 1/2"	AD250	67.40	BD250	171.00	---	---	---	---
3"	AD300	67.60	BD300	187.00	ID300	113.50	RD300BL	248.00
4"	AD400	87.85	BD400	255.00	ID400	129.50	RD400BL	323.00
5"	AD500	141.00	---	---	---	---	---	---
6"	AD600	224.80	BD600	632.00	ID600 ²	418.00	---	---
8"	AD800 ¹	526.70	---	---	---	---	---	---



¹ Dixon and Boss-Lock cam and groove couplings *do not interchange in the 8" and 1/2" sizes.*
The 8" Dixon design has 4 cam arms, Boss-Lock design has 2 cam arms.

² ductile iron

EZ Boss-Lock Type D Couplers

female coupler x female NPT

Feature:

- Couplers are supplied standard with a Buna-N gasket. Other gasket types are available on pages 74-76.



356T6 aluminum



brass



316 stainless



Heavy Duty 316 stainless

Size	356T6 Aluminum		Brass		316 Stainless Steel		Heavy Duty 316 Stainless Steel	
	Part #	Price/E	Part #	Price/E	Part #	Price/E	Part #	Price/E
3/4" x 1/2"	---	---	---	---	RD050EZ	\$121.50	---	---
3/4"	AD075EZ	\$67.25	BD075EZ	\$105.00	RD075EZ	106.50	---	---
1"	AD100EZ	70.55	BD100EZ	111.00	RD100EZ	107.20	---	---
1 1/4"	---	---	BD125EZ	142.00	RD125EZ	141.70	---	---
1 1/2"	AD150EZ	76.90	BD150EZ	123.00	RD150EZ	145.80	---	---
2"	AD200EZ	75.25	BD200EZ	143.50	RD200EZ	147.00	---	---
2 1/2"	AD250EZ	94.30	BD250EZ	200.00	RD250EZ	265.00	---	---
3"	AD300EZ	120.10	BD300EZ	253.00	RD300EZ	278.00	RD300EZHD NEW	\$265.00
4"	AD400EZ	138.20	BD400EZ	310.00	RD400EZ	337.60	RD400EZHD NEW	420.00
5"	AD500EZ	205.00	---	---	---	---	---	---
6"	AD600EZ	327.00	---	---	RD600EZ	550.00	---	---
8"	AD800EZ ¹	536.00	---	---	---	---	---	---



¹ Dixon and Boss-Lock cam and groove couplings *do not interchange in the 8" and 1/2" sizes.*
The 8" Dixon design has 4 cam arms, Boss-Lock design has 2 cam arms.

Under no circumstances should the EZ Boss-Lock cam arms be used on any fitting not specifically designed for their use.
See pages 28 and 72 for further specifications.

Dixon / Boss-Lock Type E Adapters

male adapter x hose shank

C  Pressure rating is based on the seal of the mating part. See ratings on page 29.



356T6 aluminum



aluminum hard coat

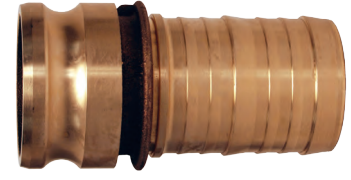

brass

Size	356T6 Aluminum		Aluminum Hard Coat		Brass	
	Part #	Price/E	Part #	Price/E	Part #	Price/E
1/2"	50-E-AL	\$14.75	---	---	50-E-BR	\$25.50
3/4" x 1/2"	7550-E-AL	13.00	---	---	---	---
3/4"	75-E-AL	12.30	---	---	75-E-BR	26.00
1"	100-E-AL	13.90	---	---	100-E-BR	39.25
1 1/4"	125-E-AL	18.55	---	---	125-E-BR	52.00
1 1/2"	150-E-AL	19.30	150-E-ALH	\$33.00	150-E-BR	60.50
2"	200-E-AL	23.50	200-E-ALH	39.30	200-E-BR	83.50
2 1/2"	250-E-AL	35.50	---	---	250-E-BR	121.00
3"	300-E-AL	37.90	300-E-ALH	62.00	300-E-BR	138.75
4"	400-E-AL	70.95	400-E-ALH	105.00	400-E-BR	243.00
5"	500-E-AL	107.00	---	---	---	---
6"	600-E-AL	147.70	600-E-ALH	210.00	600-E-BR	600.00
8" DIX	800-E-AL ¹	567.00	---	---	---	---
8" BL	801-E-AL ¹	584.50	---	---	---	---

! Dixon and Boss-Lock cam and groove couplings *do not interchange in the 8" and 1/2" sizes.*

Dixon / Boss-Lock Type E Adapters

male adapter x hose shank



unplated malleable iron



plated malleable iron



316 stainless

Size	Unplated Malleable Iron		Plated Malleable Iron		316 Stainless Steel	
	Part #	Price/E	Part #	Price/E	Part #	Price/E
1/2"	---	---	---	---	50-E-SS	\$46.35
3/4" x 1/2"	---	---	---	---	7550-E-SS	55.20
3/4"	---	---	75-E-PM	\$24.95	75-E-SS	49.20
1"	---	---	100-E-PM	28.10	100-E-SS	51.00
1 1/4"	---	---	125-E-PM	31.00	125-E-SS	72.10
1 1/2"	150-E-MI	\$31.30	150-E-PM	34.00	150-E-SS	72.35
2"	200-E-MI	40.40	200-E-PM	41.80	200-E-SS	74.10
2 1/2"	---	---	---	---	250-E-SS	198.00
3"	300-E-MI ²	53.20	300-E-PM ²	60.00	300-E-SS	137.50
4"	400-E-MI ^{1,2}	86.35	400-E-PM ^{1,2}	99.75	400-E-SS	278.00
5"	---	---	---	---	500-E-SS	420.00
6"	600-E-MI ^{1,2}	176.00	600-E-PM ^{1,2}	231.00	600-E-SS	538.00

¹ Suitable for King Crimp sleeves and ferrules, see pages 14-18.

² ductile iron

Dixon / Boss-Lock Type F Adapters

male NPT x male adapter



• Pressure rating is based on the seal of the mating part. See ratings on page 29.

C



356T6 aluminum



aluminum hard coat



brass

Size	356T6 Aluminum		Aluminum Hard Coat		Brass	
	Part #	Price/E	Part #	Price/E	Part #	Price/E
1/2"	50-F-AL	\$11.00	---	---	50-F-BR	\$22.25
3/4" x 1/2"	7550-F-AL	24.00	---	---	7550-F-BR	53.00
3/4"	75-F-AL	12.30	---	---	75-F-BR	27.00
1"	100-F-AL	15.55	---	---	100-F-BR	35.20
1 1/4"	125-F-AL	18.60	---	---	125-F-BR	54.25
1 1/2"	150-F-AL	19.40	150-F-ALH	\$33.25	150-F-BR	46.25
2"	200-F-AL	21.10	200-F-ALH	38.30	200-F-BR	57.30
2 1/2"	250-F-AL	38.30	---	---	250-F-BR	132.50
3"	300-F-AL	38.25	300-F-ALH	62.90	300-F-BR	152.00
4"	400-F-AL	72.50	400-F-ALH	109.00	400-F-BR	218.00
5"	500-F-AL	133.00	---	---	---	---
6"	600-F-AL	149.00	600-F-ALH	220.45	600-F-BR	585.00
8" DIX	800-F-AL ¹	450.00	---	---	---	---
8" BL	801-F-AL ¹	460.00	---	---	---	---

¹ Dixon and Boss-Lock cam and groove couplings do not interchange in the 8" and 1/2" sizes.

unplated malleable iron



plated malleable iron



316 stainless

Size	Unplated Malleable Iron		Plated Malleable Iron		316 Stainless Steel	
	Part #	Price/E	Part #	Price/E	Part #	Price/E
1/2"	---	---	---	---	50-F-SS	\$48.40
3/4" x 1/2"	---	---	---	---	7550-F-SS	73.00
3/4"	---	---	75-F-PM	\$24.75	75-F-SS	55.30
1"	---	---	100-F-PM	22.80	100-F-SS	60.75
1 1/4"	---	---	---	---	125-F-SS	84.70
1 1/2"	150-F-MI	\$33.10	150-F-PM	35.25	150-F-SS	79.30
2"	200-F-MI	38.75	200-F-PM	43.40	200-F-SS	83.00
2 1/2"	---	---	---	---	250-F-SS	285.00
3"	300-F-MI	73.25	300-F-PM	76.00	300-F-SS	180.00
4"	400-F-MI	108.00	400-F-PM	113.20	400-F-SS	292.30
6"	---	---	600-F-PM	275.00	600-F-SS	415.80

Dixon Type DC Dust Caps

Features:

- Finger rings are not supplied on 1/2" - 1" Dixon couplings.
- 1/2" Dixon has only one cam arm.
- Couplers are supplied standard with a Buna-N gasket. Other gasket types are available on pages 74-76



356T6 aluminum



aluminum hard coat



brass

Size	356T6 Aluminum		Aluminum Hard Coat		Brass	
	Part #	Price/E	Part #	Price/E	Part #	Price/E
1/2"	50-DC-AL	\$23.00	---	---	50-DC-BR	\$34.25
3/4"	75-DC-AL	25.20	---	---	75-DC-BR	45.30
1"	100-DC-AL	24.85	---	---	100-DC-BR	52.00
1 1/2"	150-DC-AL	31.95	150-DC-ALH	\$47.00	150-DC-BR	77.00
2"	200-DC-AL	30.20	200-DC-ALH	48.00	200-DC-BR	72.00
2 1/2"	250-DC-AL	54.20	---	---	---	---
3"	300-DC-AL	41.10	300-DC-ALH	65.30	300-DC-BR	105.00
4"	400-DC-AL	54.00	400-DC-ALH	96.50	400-DC-BR	153.00
5"	500-DC-AL	86.40	---	---	500-DC-BR	336.00
6"	600-DC-AL	132.80	600-DC-ALH	205.00	---	---
8"	800-DC-AL ¹	534.00	---	---	---	---



¹ Dixon and Boss-Lock cam and groove couplings do not interchange in the 8" and 1/2" sizes. The 8" Dixon dust cap has 2 cam arms.



unplated malleable iron



316 stainless

Size	Unplated Malleable Iron		316 Stainless Steel	
	Part #	Price/E	Part #	Price/E
1/2"	---	---	50-DC-SS	\$66.95
3/4"	---	---	75-DC-SS	63.75
1"	---	---	100-DC-SS	71.50
1 1/2"	---	---	150-DC-SS	89.00
2"	200-DC-MI	\$53.00	200-DC-SS	105.00
2 1/2"	---	---	250-DC-SS	209.00
3"	300-DC-MI	67.20	300-DC-SS	133.00
4"	400-DC-MI	106.00	400-DC-SS	195.00
5"	---	---	500-DC-SS	415.00
6"	---	---	600-DC-SS	490.00



Dust Cap with Pull Handles for Hose Tubes

Features:

- Handles make it easier for tanker operators to remove delivery hoses from the storage tubes; the operator grabs the handle and easily pulls the hose out.
- rugged construction protects the hose coupling and adapter from damage during transportation and the removal of hoses from the hose storage tube
- prevents possible environmental issues due to leaking residue left in an open hose

Materials:

- aluminum body, brass cam arms, Buna seal



Size	Aluminum Part #	Price/E
4"	400-DC-ALPH	\$91.85



Dust caps and dust plugs are not to be used in pressure applications for safety and environmental reasons.

Boss-Lock Type H Dust Caps

Features:

- All Boss-Lock couplers are supplied with safety clips.
- Couplers are supplied standard with a Buna-N gasket. Other gasket types are available on pages 74-76.

C



356T6 aluminum



brass



plated malleable iron



316 stainless

Size	356T6 Aluminum		Brass		Plated Malleable Iron		316 Stainless Steel	
	Part #	Price/E	Part #	Price/E	Part #	Price/E	Part #	Price/E
¾"	---	---	---	---	---	---	RH075BL	\$76.80
1"	AH100	\$39.30	BH100	\$67.10	---	---	RH100BL	81.95
1¼"	AH125	41.10	BH125	79.00	---	---	RH125BL	99.25
1½"	AH150	41.50	BH150	82.80	IH150	\$59.00	RH150BL	105.25
2"	AH200	43.20	BH200	108.70	IH200	70.00	RH200BL	122.95
2½"	AH250	47.00	BH250	129.00	---	---	---	---
3"	AH300	71.40	BH300	160.00	IH300	95.00	RH300BL	188.65
4"	AH400	79.00	BH400	210.00	IH400	122.00	RH400BL	224.00
6"	AH600	213.00	BH600	520.00	IH600	315.00	---	---
8"	AH800 ¹	438.80	---	---	---	---	---	---



¹ Dixon and Boss-Lock cam and groove couplings *do not interchange in the 8" and ½" sizes.*
The 8" Boss-Lock design has 2 cam arms.

EZ Boss-Lock Type H Dust Caps

Feature:

- Couplers are supplied standard with a Buna-N gasket. Other gasket types are available on pages 74-76.



356T6 aluminum



brass



316 stainless

Size	356T6 Aluminum		Brass		316 Stainless Steel	
	Part #	Price/E	Part #	Price/E	Part #	Price/E
¾"	---	---	---	---	RH075EZ	\$93.90
1"	AH100EZ	\$71.30	BH100EZ	\$114.00	RH100EZ	97.60
1¼"	---	---	---	---	RH125EZ	126.50
1½"	AH150EZ	72.00	BH150EZ	120.00	RH150EZ	126.30
2"	AH200EZ	72.80	BH200EZ	130.00	RH200EZ	143.45
2½"	AH250EZ	80.00	---	---	---	---
3"	AH300EZ	103.50	BH300EZ	244.00	RH300EZ	199.50
4"	AH400EZ	122.40	---	---	RH400EZ	245.00
6"	AH600EZ	260.00	---	---	RH600EZ	467.00



- *Under no circumstances should the EZ Boss-Lock cam arms be used on any fitting not specifically designed for their use.* See pages 28 and 72 for further specifications.
- *Dust caps and dust plugs are not to be used in pressure applications for safety and environmental reasons.*

Dixon / Boss-Lock Type DP Dust Plugs

C



356T6 aluminum



aluminum hard coat



brass

Size	356T6 Aluminum		Aluminum Hard Coat		Brass	
	Part #	Price/E	Part #	Price/E	Part #	Price/E
1/2"	---	---	---	---	50-DP-BR	\$26.00
3/4"	75-DP-AL	\$12.30	---	---	75-DP-BR	29.75
1"	100-DP-AL	14.50	---	---	100-DP-BR	25.70
1 1/4"	125-DP-AL	17.00	---	---	125-DP-BR	45.00
1 1/2"	150-DP-AL	17.00	150-DP-ALH	\$32.25	150-DP-BR	48.50
2"	200-DP-AL	17.85	200-DP-ALH	35.30	200-DP-BR	50.70
2 1/2"	250-DP-AL	25.50	---	---	---	---
3"	300-DP-AL	25.80	300-DP-ALH	47.00	300-DP-BR	78.50
4"	400-DP-AL	38.25	400-DP-ALH	70.00	400-DP-BR	170.00
5"	500-DP-AL	64.25	---	---	---	---
6"	600-DP-AL	83.00	600-DP-ALH	130.60	600-DP-BR	540.00
8" DIX	800-DP-AL ¹	355.00	---	---	---	---
8" BL	801-DP-AL ¹	361.00	---	---	---	---



¹ Dixon and Boss-Lock cam and groove couplings do not interchange in the 8" and 1/2" sizes.



unplated malleable iron



plated malleable iron



316 stainless

Size	Unplated Malleable Iron		Plated Malleable Iron		316 Stainless Steel	
	Part #	Price/E	Part #	Price/E	Part #	Price/E
1/2"	---	---	---	---	50-DP-SS	\$40.60
3/4"	---	---	---	---	75-DP-SS	42.40
1"	---	---	100-DP-PM	\$28.00	100-DP-SS	44.50
1 1/4"	---	---	125-DP-PM	30.00	125-DP-SS	47.80
1 1/2"	150-DP-MI	\$25.00	150-DP-PM	25.75	150-DP-SS	56.90
2"	200-DP-MI	32.15	200-DP-PM	34.40	200-DP-SS	64.00
2 1/2"	---	---	250-DP-PM	36.00	250-DP-SS	159.00
3"	300-DP-MI	41.10	300-DP-PM	44.80	300-DP-SS	102.70
4"	400-DP-MI	68.90	400-DP-PM	76.50	400-DP-SS	175.00
5"	---	---	---	---	---	---
6"	---	---	---	---	600-DP-SS	378.00

NEW 2014

Dust Plug with Pull Handles for Hose Tubes



Features:

- Handles make it easier for tanker operators to remove delivery hoses from the storage tubes; the operator grabs the handle and easily pulls the hose out.
- rugged construction protects the hose coupling and adapter from damage during transportation and the removal of hoses from the hose storage tube
- prevents possible environmental issues due to leaking residue left in an open hose

Materials:

- aluminum body and Buna seals

Size	Aluminum Part #	Price/E
4"	400-DP-ALPH	\$42.15



Dust caps and dust plugs are not to be used in pressure applications for safety and environmental reasons.

Hastelloy Adapters

C

female NPT x male adapter
Type Amale NPT x male adapter
Type Fmale adapter x hose shank
Type E

Size	Type A CW-6M-C276 Hastelloy Part #	Price/E	Type F CW-6M-C276 Hastelloy Part #	Price/E	Type E CW-6M-C276 Hastelloy Part #	Price/E
1"	100-A-HA	\$290.00	100-F-HA	\$245.00	100-E-HA	\$271.00
1½"	150-A-HA	360.00	150-F-HA	505.00	150-E-HA	345.00
2"	200-A-HA	405.00	200-F-HA	620.00	200-E-HA	445.00
3" NEW	300-A-HA	800.00	300-F-HA	995.00	300-E-HA	1300.00

Hastelloy Couplers

Features:

- couplers supplied with FKM gaskets
- 316 stainless steel cam arms
- 302 stainless steel pins
- yellow zinc plated 12 gauge steel wire rings

female coupler x hose shank
Type Cfemale coupler x female NPT
Type Dfemale coupler x male NPT
Type B

Size	Type C CW-6M-C276 Hastelloy Part #	Price/E	Type D CW-6M-C276 Hastelloy Part #	Price/E	Type B CW-6M-C276 Hastelloy Part #	Price/E
1"	HAC100EZ	\$460.00	HAD100EZ	\$492.00	HAB100EZ	\$420.40
1½"	HAC150EZ	560.00	HAD150EZ	615.00	HAB150EZ	525.40
2"	HAC200EZ	611.00	HAD200EZ	645.00	HAB200EZ	568.30
3" NEW	HAC300EZ	1700.00	HAD300EZ	1200.00	HAB300EZ	1100.00

Dixon Reducing Cam and Groove Couplings

C



3" coupler x 1½" adapter



4" coupler x 6" adapter



3" coupler x 2½" adapter



5" coupler x 6" adapter

In reducing cam and groove couplings, the coupler is the first size in the part number; (i.e., a 4030-DA-AL is a 4" coupler to a 3" adapter).

Feature:

- supplied standard with a Buna-N gasket, other gaskets available on pages 74-76

coupler x adapter

Size	356T6 Aluminum		Opt Qty	316 Stainless Steel	
	Part #	Price/E		Part #	Price/E
1" x 1½"	1015-DA-AL ¹	\$158.00	---	1015-DA-SS ¹	\$315.00
1½" x 1"	1510DAAL	72.70	---	1510-DA-SS ¹	315.00
1½" x 2"	1520-DA-AL	88.00	10	1520-DA-SS	295.00
2" x 1"	2010-DA-AL ¹	162.50	---	2010-DA-SS	251.60
2" x 1½"	2015-DA-AL	61.00	10	2015-DA-SS	272.00
2" x 2½"	2025-DA-AL ¹	170.00	---	2025-DA-SS ¹	525.00
2" x 3"	2030-DA-AL	75.20	5	2030-DA-SS	291.70
2" x 4"	2040-DA-AL	119.00	---	2040-DA-SS ¹	510.00
2½" x 2"	---	---	---	2520-DA-SS ¹	540.00
2½" x 3"	---	---	---	2530-DA-SS ¹	640.25
3" x 1½"	3015-DA-AL	92.70	---	3015-DA-SS ¹	410.00
3" x 2"	3020-DA-AL	77.40	10	3020-DA-SS	285.30
3" x 2½"	3025-DA-AL ¹	180.00	---	3025-DA-SS ¹	490.00
3" x 4"	3040-DA-AL	107.10	5	3040-DA-SS	788.00
3" x 6"	3060-DA-AL ¹	300.00	---	3060-DA-SS ¹	719.00
4" x 2"	4020-DA-AL	109.00	5	4020-DA-SS ¹	561.00
4" x 2½"	4025-DA-AL	167.50	---	4025-DA-SS ¹	732.00
4" x 3"	4030-DA-AL	115.30	5	4030-DA-SS	535.00
4" x 5"	4050-DA-AL	226.80	2	---	---
4" x 6"	4060-DA-AL	191.30	2	4060-DA-SS ¹	1100.00
5" x 3"	5030-DA-AL ¹	287.75	2	5030-DA-SS ¹	725.00
5" x 4"	5040-DA-AL	187.20	2	5040-DA-SS ¹	800.00
5" x 6"	5060-DA-AL ¹	399.00	---	5060-DA-SS	950.00
6" x 3"	6030-DA-AL	204.70	2	6030-DA-SS ¹	1158.75
6" x 4"	6040-DA-AL	199.75	2	6040-DA-SS	1200.00
6" x 5"	6050-DA-AL	331.35	---	6050-DA-SS ¹	1300.00
8" x 6"	8060-DA-AL ^{1,2}	1100.00	---	---	---

¹ parts are produced as a welded fabrication

² The 8" coupler only has 2 cam arms and *only interchanges with Dixon adapters.*

coupler x adapter

Size	Brass		Opt Qty	Unplated Malleable Iron		Opt Qty
	Part #	Price/E		Part #	Price/E	
3" x 2"	3020-DA-BR	\$305.00	10	3020-DA-MI	\$124.30	10
3" x 4"	3040-DA-BR	410.00	5	---	---	---
4" x 3"	4030-DA-BR	360.00	2	4030-DA-MI	204.00	---
6" x 4"	6040-DA-BR	695.00	---	6040-DA-MI	440.00	---

Reducing Coupler x Adapter with Port

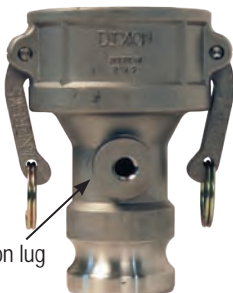

port on lug

Size	Port	316 Stainless Steel	
		Part #	Price/E
3" x 2"	¼"	3020DAT25SS	\$354.00
3" x 2"	⅜"	3020DAT38SS	354.00
3" x 2"	½"	3020DAT50SS	354.00
3" x 2"	¾"	3020DAT75SS	354.00

Boss-Lock Reducing Cam and Groove Couplings

In reducing cam and groove couplings, the coupler is the first size in the part number; (i.e., a ADA4030 is a 4" coupler to a 3" adapter).

Feature:

- supplied standard with a Buna-N gasket, other gaskets available on pages 74-76

coupler x adapter

Size	356T6 Aluminum		316 Stainless Steel		Opt Qty
	Part #	Price/E	Part #	Price/E	
2" x 3"	ADA2030 ¹	\$189.00	RDA2030BL ¹	\$415.00	10
2½" x 2"	ADA2520 ¹	173.80	---	---	--
2½" x 3"	ADA2530 ¹	295.00	---	---	--
3" x 2"	ADA3020	90.50	RDA3020BL	375.00	10
3" x 4"	ADA3040 ¹	225.75	RDA3040BL ¹	400.00	10
4" x 2"	ADA4020 ¹	252.00	RDA4020BL ¹	639.10	10
4" x 3"	ADA4030	138.60	RDA4030BL	599.00	10
6" x 4"	ADA6040 ¹	523.00	---	---	--
8" x 6"	ADA8060 ^{1,2}	1100.00	---	---	--



¹ parts are produced as a welded fabrication

² The 8" coupler *only interchanges with 8" Boss-Lock couplings.*



3" coupler x 2" adapter

EZ Boss-Lock Reducing Cam and Groove Couplings

In reducing cam and groove couplings, the coupler is the first size in the part number; (i.e., a ADA4030EZ is a 4" coupler to a 3" adapter).

Feature:

- supplied standard with a Buna-N gasket, other gaskets types available on pages 74-76

coupler x adapter

Size	356T6 Aluminum		316 Stainless Steel	
	Part #	Price/E	Part #	Price/E
2" x 3"	ADA2030EZ ¹	\$224.30	RDA2030EZ ¹	\$411.95
3" x 2"	ADA3020EZ	137.20	RDA3020EZ	385.80
3" x 4"	ADA3040EZ ¹	249.10	RDA3040EZ ¹	448.00
4" x 2"	ADA4020EZ ¹	294.70	RDA4020EZ ¹	630.00
4" x 3"	ADA4030EZ	194.25	RDA4030EZ	595.00
6" x 4"	ADA6040EZ ¹	581.00	RDA6040EZ	647.00

¹ parts are produced as a welded fabrication

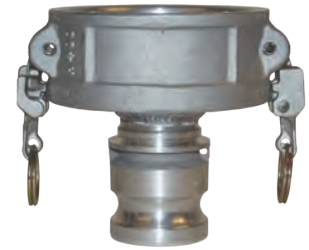

4" coupler x 2" adapter

Dixon Lockable Dust Caps

Features:

- supplied standard with a Buna-N gasket, other gaskets available on pages 74-76
- Dust caps and dust plugs are not to be used in pressure applications for safety and environmental reasons.



Size	356T6 Aluminum			Brass		
	Part #	Price/E	Opt Qty	Part #	Price/E	Opt Qty
1½"	150DC-LAL	\$48.25	10	150DC-LBR	\$94.50	10
2"	200DC-LAL	52.00	10	200DC-LBR	96.00	10
3"	300DC-LAL	65.80	10	300DC-LBR	119.00	10
4"	400DC-LAL	86.60	10	---	---	---
6"	600DC-LAL	203.00	2	---	---	--



Feature:

- angled, ergonomic thumb release

Size	316 Stainless Steel	
	Part #	Price/E
1½"	150DC-LSS	\$119.00
2"	200DC-LSS	163.40
3"	300DC-LSS	197.00
4"	400DC-LSS	256.90



Dixon Spool Adapters

Feature:

- pressure rating is based on the seal of the mating part, see ratings on page 29
- adapter x adapter**

C



increaser / reducer



same size

Size	356T6 Aluminum		316 Stainless Steel	
	Part #	Price/E	Part #	Price/E
1"	---	---	100-AA-SS	\$102.90
1¼"	---	---	125-AA-SS ¹	365.00
1½"	150-AA-AL	\$35.10	150-AA-SS	111.80
1½" x 2"	1520-AA-AL	45.40	1520-AA-SS	176.00
2"	200-AA-AL	41.25	200-AA-SS	160.00
2" x 3"	2030-AA-AL	64.50	2030-AA-SS	218.00
2" x 4"	2040-AA-AL	114.30	2040-AA-SS ¹	446.00
2½" x 3"	2530-AA-AL ¹	218.00	2530-AA-SS ¹	560.00
2½" x 4"	2540-AA-AL ¹	320.00	---	---
3"	300-AA-AL	65.20	300-AA-SS	261.30
3" x 4"	3040-AA-AL	94.50	3040-AA-SS ¹	505.00
4"	400-AA-AL	85.95	400-AA-SS	359.00
4" x 5"	4050-AA-AL	130.00	---	---
4" x 6"	4060-AA-AL	217.35	4060-AA-SS ¹	995.00
5"	500-AA-AL ¹	270.00	500-AA-SS ¹	850.00
5" x 6"	5060-AA-AL ¹	410.00	---	---
6"	600-AA-AL	236.50	600-AA-SS ¹	970.00

Size	Brass	
	Part #	Price/E
2"	200-AA-BR	\$123.75
3"	300-AA-BR	235.00

¹ parts are produced as a welded fabrication

Dixon Spool Couplers

Feature:

- supplied standard with a Buna-N gasket, other gaskets available on pages 74-76
- coupler x coupler**



reducer / increaser



same size

Size	356T6 Aluminum		316 Stainless Steel	
	Part #	Price/E	Part #	Price/E
1½"	---	---	150-DD-SS ¹	\$295.00
2"	200-DD-AL	\$67.70	200-DD-SS	196.25
2" x 3"	2030-DD-AL	110.00	2030-DD-SS	324.00
3"	300-DD-AL	89.75	300-DD-SS	302.30
3" x 4"	3040-DD-AL	125.50	3040-DD-SS ¹	710.00
4"	400-DD-AL	130.00	400-DD-SS ¹	780.00
4" x 5"	4050-DD-AL ¹	395.20	4050-DD-SS ¹	780.00
4" x 6"	4060-DD-AL ¹	357.00	4060-DD-SS	782.00
5"	500-DD-AL ¹	465.00	500-DD-SS	750.00
6"	600-DD-AL ¹	540.00	---	---

¹ parts are produced as a welded fabrication

Boss-Lock Spool Couplers

Feature:

- supplied standard with a Buna-N gasket, other gaskets available on pages 74-76
- coupler x coupler**



reducer / increaser



same size

Size	356T6 Aluminum		316 Stainless Steel	
	Part #	Price/E	Part #	Price/E
2"	ADD200 ¹	\$187.00	RDD200EZ	\$360.85
2" x 3"	ADD2030 ¹	195.00	RDD2030EZ ¹	450.00
3"	ADD300 ¹	253.00	RDD300EZ ¹	548.00
3" x 4"	ADD3040 ¹	320.00	RDD3040EZ ¹	640.00
4"	ADD400 ¹	320.00	RDD400EZ ¹	645.50
6"	---	---	RDD600EZ ¹	1200.00

¹ parts are produced as a welded fabrication

Reducing Cam and Groove Couplings

In reducing couplings, the cam and groove end is the first size given in the part number. (i.e., a 4030-C-AL is a 4" coupler to a 3" hose shank).

C

Type A

Feature:

- pressure rating is based on the seal of the mating part, see ratings on page 29

male adapter x female NPT

Size	356T6 Aluminum		Opt Qty	316 Stainless Steel		Opt Qty
	Part #	Price/E		Part #	Price/E	
2" x 1½"	2015-A-AL	\$45.95	---	2015-A-SS ¹	\$208.70	--
2" x 3"	2030-A-AL	63.50	10	2030-A-SS	234.00	10
3" x 2"	3020-A-AL	59.75	5	3020-A-SS	295.00	10
3" x 4"	3040-A-AL	74.50	10	---	---	--
4" x 3"	4030-A-AL	68.00	10	4030-A-SS ¹	490.00	--
4" x 6"	4060-A-AL	187.20	5	---	---	--
6" x 4"	6040-A-AL	198.30	5	6040-A-SS ¹	985.00	--

¹ parts are produced as a welded fabrication



reducing
male adapter x female NPT

Type B

Feature:

- supplied standard with a Buna-N gasket, other gaskets available on pages 74-76

female coupler x male NPT

Size	356T6 Aluminum		Opt Qty	316 Stainless Steel	
	Part #	Price/E		Part #	Price/E
1½" x 1"	1510-B-AL	\$64.80	10	1510-B-SS ¹	\$320.00
2" x 1½"	2015-B-AL	63.40	10	2015-B-SS ¹	370.00
2" x 3"	2030-B-AL	81.25	---	---	---
3" x 2"	3020-B-AL	81.25	10	3020-B-SS ¹	358.00
3" x 4"	3040-B-AL	107.60	10	---	---
4" x 3"	4030-B-AL	125.25	5	4030-B-SS ¹	495.00

¹ parts are produced as a welded fabrication



reducing
female coupler x male NPT

Type C

Feature:

- supplied standard with a Buna-N gasket, other gaskets available on pages 74-76

female coupler x hose shank

Size	356T6 Aluminum		Opt Qty	316 Stainless Steel	
	Part #	Price/E		Part #	Price/E
1½" x 1"	---	---	---	1510-C-SS	\$235.00
2" x 1½"	2015-C-AL ¹	\$185.00	---	2015-C-SS ¹	260.00
3" x 2"	3020-C-AL	72.50	10	3020-C-SS	342.80
3" x 2½"	---	---	---	3025-C-SS	389.30
3" x 4"	3040-C-AL	130.00	5	---	---
4" x 3"	4030-C-AL	93.10	5	4030-C-SS ¹	600.00
5" x 4"	5040-C-AL ¹	375.00	---	---	---

¹ parts are produced as a welded fabrication



reducing
female coupler x hose shank

Type D

Feature:

- supplied standard with a Buna-N gasket, other gaskets available on pages 74-76

female coupler x female NPT

Size	356T6 Aluminum		Opt Qty	Brass		316 Stainless Steel	
	Part #	Price/E		Part #	Price/E	Part #	Price/E
1½" x 1"	1510-D-AL ¹	\$65.70	10	---	---	1510-D-SS ¹	\$306.00
2" x 1½"	2015-D-AL	48.90	10	---	---	2015-D-SS	220.00
3" x 2"	3020-D-AL	87.60	10	---	---	3020-D-SS	345.50
4" x 3"	4030-D-AL	127.00	10	4030-D-BR	\$300.00	4030-D-SS ¹	498.00
5" x 4"	5040-D-AL ¹	355.00	---	---	---	---	---
6" x 4"	6040-D-AL ¹	410.00	---	---	---	---	---

¹ parts are produced as a welded fabrication



reducing
female coupler x female NPT

Reducing Cam and Groove Couplings

C In reducing couplings, the cam and groove end is the first size given in the part number. (i.e., a 4030-B-AL is a 4" coupler to a 3" male NPT).

Type E

Feature:

- pressure rating is based on the seal of the mating part, see ratings on page 29

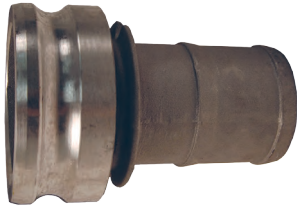

reducing
male adapter x hose shank

male adapter x hose shank

Size	356T6 Aluminum		Opt Qty	316 Stainless Steel	
	Part #	Price/E		Part #	Price/E
1½" x 1"	---	---	---	1510-E-SS	\$221.00
2" x 1½"	2015-E-AL ¹	\$180.00	---	2015-E-SS ¹	218.40
3" x 2"	---	---	---	3020-E-SS ¹	385.00
3" x 2½"	---	---	---	3025-E-SS	199.00
4" x 3"	4030-E-AL	86.80	10	4030-E-SS ¹	550.00
5" x 4"	5040-E-AL ¹	325.00	---	---	---

¹ parts are produced as a welded fabrication

Type F

Feature:

- pressure rating is based on the seal of the mating part, see ratings on page 29



reducing
male adapter x male NPT

male adapter x male NPT

Size	356T6 Aluminum		Opt Qty	316 Stainless Steel	
	Part #	Price/E		Part #	Price/E
1½" x 2"	1520-F-AL	\$45.00	---	---	---
2" x 1½"	2015-F-AL	45.30	---	2015-F-SS ¹	\$398.00
2" x 3"	2030-F-AL	69.00	---	---	---
3" x 1½"	3015-F-AL	64.60	10	3015-F-SS ¹	418.00
3" x 2"	3020-F-AL	64.25	10	3020-F-SS	410.00
3" x 4"	3040-F-AL	83.30	10	---	---
4" x 3"	4030-F-AL	88.90	10	4030-F-SS	325.00

¹ parts are produced as a welded fabrication

Adapters and Couplers with Straight Pipe Thread (NPSM)

Application:

- for delivery of dry goods

Features:

- cork buna gaskets are standard in threaded end replacement gasket; **400GAGFI, \$4.30**
- pressure rating is based on the seal of the mating part, see ratings on page 29

adapter x NPSM thread

Size	356T6 Aluminum	
	Part #	Price/E
4"	400-AS-AL	\$88.00

Feature:

- supplied standard with a Buna-N gasket, other gaskets available on pages 74-76

Boss-Lock coupler x NPSM thread

Size	356T6 Aluminum	
	Part #	Price/E
4"	ADS400	\$97.65

Cam and Groove x Cam and Groove Elbows

Feature:

- supplied standard with a Buna-N gasket, other gaskets available on pages 74-76

C

45° Elbows

adapter x coupler

Size	356T6 Aluminum		316 Stainless Steel	
	Part #	Price/E	Part #	Price/E
2"	200DA-45AL ¹	\$154.25	200DA-45SS ¹	\$495.00
3"	300DA-45AL	180.00	300DA-45SS ¹	715.00
4"	400DA-45AL	239.95	400DA-45SS ¹	960.00
6"	600DA-45AL	543.00	---	---

¹ parts are produced as a welded fabrication



male adapter x female coupler

coupler x coupler

Size	356T6 Aluminum		316 Stainless Steel	
	Part #	Price/E	Part #	Price/E
2"	200DD-45AL	\$157.00	---	--
3"	300DD-45AL	395.20	300DD-45SS	\$599.00
4"	400DD-45AL	398.00	---	--
6"	600DD-45AL	730.00	---	--

• parts are produced as a welded fabrication



female coupler x female coupler

90° Elbows

adapter x coupler

Size	356T6 Aluminum		316 Stainless Steel	
	Part #	Price/E	Part #	Price/E
1"	---	---	100DA-90SS ¹	\$350.00
1½"	150DA-90AL ¹	\$131.25	150DA-90SS ¹	405.00
2"	200DA-90AL	90.95	200DA-90SS	365.00
3"	300DA-90AL	148.50	300DA-90SS	715.00
4"	400DA-90AL	232.80	400DA-90SS	795.00
5"	500DA-90AL ¹	1500.00	---	---
6"	600DA-90AL	481.25	RDA90600EZ ^{1,2}	2300.00

¹ parts are produced as a welded fabrication

² EZ Boss-Lock design (not pictured)



male adapter x female coupler

coupler x coupler

Size	356T6 Aluminum		316 Stainless Steel	
	Part #	Price/E	Part #	Price/E
2"	200DD-90AL	\$179.60	---	---
3"	300DD-90AL	375.00	300DD-90SS	\$565.00
4"	400DD-90AL	198.00	---	---
6"	600DD-90AL	795.00	---	---

• parts are produced as a welded fabrication



female coupler x female coupler

Cam and Groove Elbows

Type A

C

Feature:

- pressure rating is based on the seal of the mating part, see ratings on page 29



male adapter x female NPT

male adapter x female NPT 90° elbow

Size	356T6 Aluminum		316 Stainless Steel	
	Part #	Price/E	Part #	Price/E
1½"	150A-90AL	\$72.90	---	---
2"	200A-90AL	69.75	200A-90SS ¹	\$450.00
3"	300A-90AL	123.00	300A-90SS	475.50
4"	400A-90AL	224.00	---	---

¹ part is produced as a welded fabrication

Type B

Feature:

- supplied standard with a Buna-N gasket, other gaskets available on pages 74-76



female coupler x male NPT

female coupler x male NPT 90° elbow

Size	356T6 Aluminum		316 Stainless Steel	
	Part #	Price/E	Part #	Price/E
1½"	150B-90AL	\$77.00	---	---
2"	200B-90AL	91.00	200B-90SS ¹	\$490.00
3"	---	---	300B-90SS ¹	600.00

¹ Parts are produced as a welded fabrication.

Type C

Feature:

- supplied standard with a Buna-N gasket, other gaskets available on pages 74-76



female coupler x hose shank

female coupler x hose shank 90° elbow

Size	356T6 Aluminum		Brass		316 Stainless Steel	
	Part #	Price/E	Part #	Price/E	Part #	Price/E
1¼"	---	---	125C-90BR	\$135.00	---	---
½"	150C-90AL	\$71.90	---	---	150C-90SS	\$390.00
2"	200C-90AL	71.80	200C-90BR	157.00	200C-90SS	340.00
3"	300C-90AL	102.90	---	---	300C-90SS	495.00
4"	400C-90AL	199.30	---	---	400C-90SS ¹	975.00
6"	600C-90AL	478.95	---	---	---	---

¹ part is produced as a welded fabrication

Cam and Groove Elbows

Type D

Feature:

- supplied standard with a Buna-N gasket, other gaskets available on pages 74-76

female coupler x female NPT 90° elbow

Size	356T6 Aluminum		Brass		316 Stainless Steel	
	Part #	Price/E	Part #	Price/E	Part #	Price/E
1"	---	---	---	---	100D-90SS	\$210.00
1¼"	---	---	125D-90BR	\$134.10	---	---
1½"	150D-90AL	\$81.60	150D-90BR	118.00	---	---
2"	200D-90AL	68.30	200D-90BR	153.00	200D-90SS	217.35
3"	300D-90AL	110.00	---	---	300D-90SS	592.00
4"	400D-90AL	150.50	---	---	400D-90SS ¹	1015.00
4"	AD90400EZ ²	235.00	---	---	---	---
6"	600D-90AL	355.00	---	---	---	---

¹ parts are produced as a welded fabrication

² EZ Boss-Lock design (not pictured)



female coupler x female NPT

Type E

Feature:

- pressure rating is based on the seal of the mating part, see ratings on page 29

male adapter x hose shank 90° elbow

Size	356T6 Aluminum		316 Stainless Steel	
	Part #	Price/E	Part #	Price/E
2"	---	---	200E-90SS ¹	\$504.00
3"	300E-90AL	\$143.00	300E-90SS	564.00
4"	400E-90AL	169.50	400E-90SS ¹	882.00

¹ parts are produced as a welded fabrication



male adapter x hose shank

Type F

Feature:

- pressure rating is based on the seal of the mating part, see ratings on page 29

male adapter x male NPT 90° elbow

Size	356T6 Aluminum		316 Stainless Steel	
	Part #	Price/E	Part #	Price/E
1½"	150F-90AL	\$60.00	---	---
2"	200F90AL	92.00	200F-90SS ¹	\$430.00
3"	---	---	300F-90SS ¹	765.00

¹ parts are produced as a welded fabrication



male adapter x male NPT

Adapters and Couplers x 150# Flanged Drilling

C

Features:

- aluminum and unplated iron flanges are flat faced
- stainless steel flanges are raised face
- see page 822 for flange drilling standards

Dixon adapter x 150# flange



Size	356T6 Aluminum		Flange Thick.	Unplated Malleable Iron		Flange Thick.	316 Stainless Steel		Flange Thick.
	Part #	Price/E		Part #	Price/E		Part #	Price/E	
1"	---	---	---	---	---	---	100-AL-SS	\$209.00	9/16"
1½"	---	---	---	---	---	---	150-AL-SS	197.70	11/16"
2"	200-AL-AL	\$115.00	3/4"	---	---	---	200-AL-SS	229.70	7/16"
3"	300-AL-AL	121.50	5/8"	300-AL-MI	\$203.70	5/8"	300-AL-SS	299.00	7/16"
4"	400-AL-AL	164.00	5/8"	---	---	---	400-AL-SS	495.00	7/16"
6"	600-AL-AL	275.00	5/8"	---	---	---	600-AL-SS	750.00	5/8"
8"	800-AL-AL ¹	1400.00	1-1/8"	---	---	---	---	---	---

¹ part is produced as a welded fabrication

Feature:

- supplied standard with a Buna-N gasket, other gaskets available on pages 74-76

Dixon coupler x 150# flange



Size	356T6 Aluminum		Flange Thickness	316 Stainless Steel		Flange Thickness
	Part #	Price/E		Part #	Price/E	
1"	---	---	---	100-DL-SS	\$196.10	21/32"
1½"	---	---	---	150-DL-SS	260.80	25/32"
2"	200-DL-AL	\$160.00	3/4"	200-DL-SS	385.00	7/16"
3"	300-DL-AL	222.00	15/16"	300-DL-SS	499.00	7/16"
4"	400-DL-AL	324.00	15/16"	400-DL-SS	985.00	7/16"
6"	600-DL-AL	419.00	1"	600-DL-SS	1124.00	5/8"
8"	800-DL-AL ¹	1800.00	1-1/8"	---	---	---

¹ part is produced as a welded fabrication

Feature:

- supplied standard with a Buna-N gasket, other gaskets available on pages 74-76

EZ Boss-Lock coupler x 150# flange



Size	316 Stainless Steel		Flange Thickness
	Part #	Price/E	
1"	RDL100EZ ¹	\$401.00	9/16"
1½"	RDL150EZ ¹	605.00	11/16"
2"	RDL200EZ	425.00	7/16"
3"	RDL300EZ ¹	600.00	7/16"
4"	RDL400EZ ¹	765.00	7/16"
6"	RDL600EZ ¹	1683.00	1"

¹ part is produced as a welded fabrication

In-Line Sight Glass for Bulk Transfer

Application:

- designed for dry bulk transfer hose
- not intended for liquid service, for dry bulk transfer *only*

Features:

- aluminum body, Buna seals, acrylic sight glasses, stainless steel hardware and bronze cam arms (where applicable)



Size	coupler x adapter		adapter x adapter		coupler x coupler	
	Part #	Price/E	Part #	Price/E	Part #	Price/E
3" x 3"	3533CA	\$329.65	3533AA	\$244.85	3533CC	\$410.80
3" x 4"	3534CA	329.65	3534AA	244.85	---	---
4" x 3"	3543CA	329.65	---	---	3543CC	410.80
4" x 4"	3544CA	329.65	3544AA	244.85	3544CC	410.80

Specialty Items

coupler x adapter wye

Size	356T6 Aluminum	
	Part #	Price/E
2"	200YDAAAL	\$142.00



C

tank truck flanged tee

Size	356T6 Aluminum	
	Part #	Price/E ¹
4"	400-TLT-AL	\$255.00



¹ Price subject to availability. Minimum production quantities may be required. Some parts have a colored anodized surface finish.

TTMA Series Flange Adapters

Application:

- provides an easy way to quickly convert threaded components to a standard TTMA flange configuration

Features:

- solid cast lightweight aluminum design is more durable than welded fabrications
- design improves flow through adapter even on the 3" reducer
- compact size reduces the overall space needed to install
- for flange drilling standards, see page 822

Male Threaded

TTMA flange x standard male NPT

TTMA Flange	Male NPT	Aluminum	
		Part #	Price/E
3"	3"	TTF3AL-3MT	\$87.50
4"	3"	TTF4AL-3MT	65.90
4"	4"	TTF4AL-4MT	61.10



Extended Length - Male Threaded

TTMA flange x extended length male NPT

TTMA Flange	Male NPT	Aluminum	
		Part #	Price/E
4"	3"	TTF4AL-3EMT	\$87.50
4"	4"	TTF4AL-4EMT	102.15



Female Threaded

TTMA flange x female NPT

TTMA Flange	Female NPT	Aluminum	
		Part #	Price/E
4"	3"	TTF4AL-3FT	\$78.35
4"	4"	TTF4AL-4FT	78.05



Slip-on

TTMA flange x slip-on

TTMA Flange	Pipe Size	Aluminum	
		Part #	Price/E
4"	4"	TTF400SP	\$67.00



TTMA Flange Extensions

C



TETF4AL



TETFG4AL

Applications:

- used on load arms to connect an API load coupler to a load arm

Features:

- adds a 6" space between the load arm and the tank truck
- extension with groove provides a specified parting point to prevent excessive damage to the loading arm

Size	Description	Aluminum	
		Part #	Price/E
4"	TTMA flange extension	TETF4AL	\$130.00
4"	TTMA flange extension with groove	TETFG4AL	133.50

Dixon Adapters and Couplers x Round Tank Truck Flange

Features:

- aluminum flanges have a flat face, stainless flanges have a raised face
- see page 822 for flange drilling standards
- pressure rating is based on the seal of the mating part, see ratings on page 29



adapter x round tank truck flange

adapter x round tank truck flange

Size	356T6 Aluminum		316 Stainless Steel	
	Part #	Price/E	Part #	Price/E
3"	300-ALT-AL	\$78.25	300-ALT-SS¹	\$480.00
3" x 4"	3040ALTAL	112.80	---	---
4"	400-ALT-AL	84.70	400-ALT-SS¹	750.00
6"	600-ALT-AL	236.00	---	---

¹ parts are produced as a welded fabrication

Feature:

- supplied standard with a Buna-N gasket, other gaskets available on pages 74-76

coupler x round tank truck flange



coupler x round tank truck flange

Size	356T6 Aluminum		Price/E
	Part #	Price/E	
3"	300-DLT-AL	\$142.60	
3" x 4"	3040DLTAL	159.40	
4"	400-DLT-AL	167.00	
6"	600-DLT-AL	350.00	

Dixon 22½° Adapters and Couplers x Round Tank Truck Flange

Feature:

- pressure rating is based on the seal of the mating part, see ratings on page 29

22½° adapter x round tank truck flange



22½° adapter x round flange

Size	356T6 Aluminum		Price/E
	Part #	Price/E	
4"	40022ALTAL	\$186.30	

Feature:

- supplied standard with a Buna-N gasket, other gaskets available on pages 74-76

22½° coupler x round tank truck flange



22½° coupler x round flange

Size	356T6 Aluminum		Price/E
	Part #	Price/E	
4"	40022DLTAL	\$153.60	

Round Tank Truck Flange Gaskets (TTMA)



Size	OD	ID	Thick.	Material	Part #	Price/E
3"	5-5/8"	3-1/2"	1/8"	Cork / Buna	300GTTFCB	\$3.90
3"	5-5/8"	3-1/2"	1/16"	PTFE envelope with Klinger filler	300GTTFTK	17.25
3"	5-5/8"	3-1/2"	1/8"	Klingsil® C-4401	300GTTFK	9.95
3"	5-7/8"	3-1/2"	1/4"	PTFE with fiber core	40321TF	22.65
4"	6-5/8"	4-9/16"	1/8"	Cork / Buna	400GTTFCB	4.60
4"	6-5/8"	4-9/16"	1/16"	PTFE envelope with Klinger filler	400GTTFTK	23.00
4"	6-5/8"	4-9/16"	1/8"	Klingsil® C-4401	400GTTFK	18.25
4"	6-7/8"	4-9/16"	1/4"	PTFE with fiber core	40322TF	34.00

Dixon Vapor Recovery Couplers



- not intended for liquid service, for vapor recovery *only*

Features:

- cast aluminum body
- bronze arms with stainless steel pins
- plated carbon steel finger rings
- Buna-N gasket

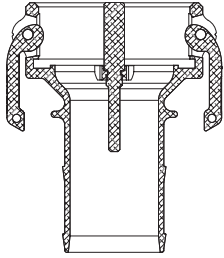

coupler with probe x hose shank

Coupler Size	Hose Shank Size	356T6 Aluminum	
		Part #	Price/E
4"	3"	4030-CVR-AL	\$129.10
4"	4"	400-CVR-AL	137.00

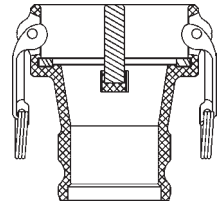

coupler with probe x adapter

Coupler Size	Adapter Size	356T6 Aluminum	
		Part #	Price/E
4"	3"	4030-DAVR-AL	\$139.50

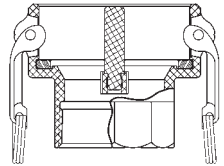

coupler with probe x female NPT

Coupler Size	Female NPT Size	356T6 Aluminum	
		Part #	Price/E
4"	3"	4030-DVR-AL	\$155.00
4"	4"	400-DVR-AL	157.30

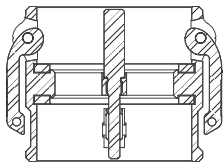

coupler with probe x coupler with probe

Coupler Size	Coupler Size	356T6 Aluminum	
		Part #	Price/E
4"	4"	400-DDVR-AL	\$160.00



Dixon Bayco Vapor Recovery Couplers



Applications:

- for use with 3" vapor hose
- not intended for liquid service, for vapor recovery *only*

Features:

- cast aluminum body, bronze arms with stainless steel pins and finger rings
- Buna-N gasket
- Dixon replacement handle assemblies will not work on these fittings, contact Dixon for replacements.*

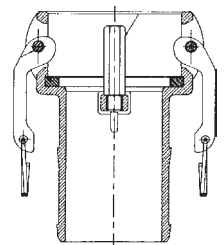

coupler with probe x hose shank

Coupler Size	Hose Shank Size	Aluminum	
		Part #	Price/E
3"	3"	VRC3000AL	\$144.05



Feature:

- VR4030CS-AL has an FKM O-ring poppet seal

coupler with poppet and probe x hose shank

Coupler Size	Hose Shank Size	Aluminum	
		Part #	Price/E
4"	3"	VR4030CS-AL¹	\$213.25
4"	4"	VR4040CS-AL	412.00 NEW



¹ interchanges with all competitor vapor valves *except* Civacon #633LVH (special bulb design).

Dixon Butt Weld to Tube Cam and Groove

C

Application:

- designed to be butt welded to standard sanitary tubing

Feature:

- 316 stainless steel investment casting



adapter x butt weld to tube end

Size	316 Stainless Steel	
	Part #	Price/E
1"	RE100BT	\$130.00
1½"	RE150BT	143.00
2"	RE200BT	165.00
3"	RE300BT	357.00

Boss-Lock coupler x butt weld to tube end



Size	316 Stainless Steel	
	Part #	Price/E
1"	RC100BT	\$195.00
1½"	RC150BT	240.00
2"	RC200BT	260.00
3"	RC300BT	425.00

Dixon Adapters for Welding

Feature:



- not all configurations are stocked
- line drawings are for reference only, consult Dixon for specific dimensions
- final weld preparation, as with all weld fittings, is the responsibility of the welder

socket weld to schedule 40 pipe

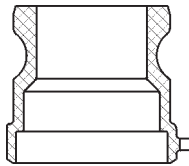

Size	Bore	356T6 Aluminum		316 Stainless Steel	
		Part #	Price/E	Part #	Price/E
¾"	1.065	---	---	75AWSPSS	\$104.20
1"	1.330	---	---	100AWSPSS	97.95
1½"	1.915	150AWSPAL	\$60.00	150AWSPSS	117.00
2"	2.390	200AWSPAL	46.35	200AWSPSS	110.00
3"	3.530	300AWSPAL	58.60	300AWSPSS	196.35
4"	4.530	400AWSPAL	80.00	400AWSPSS	298.00
5"	5.593	500AWSPAL	123.75	500AWSPSS	450.00
6"	6.655	600AWSPAL	135.00	600AWSPSS	474.00
8" DIX	8.711	800AWSPAL ¹	474.00	---	---
8" BL	8.711	801AWSPAL ¹	453.00	---	---

butt weld to schedule 40 pipe / socket weld to nominal OD tubing

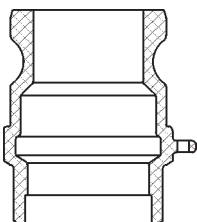

Size	Bore	356T6 Aluminum		316 Stainless Steel	
		Part #	Price/E	Part #	Price/E
¾"	.765	---	---	75AWBPSTSS	\$104.20
1"	1.015	---	---	100AWBPSTSS	97.95
1½"	1.515	150AWBPSTAL	\$60.00	150AWBPSTSS	117.00
2"	2.015	200AWBPSTAL	39.15	200AWBPSTSS	110.00
3"	3.015	300AWBPSTAL	58.60	300AWBPSTSS	196.35
4"	4.015	400AWBPSTAL	80.00	400AWBPSTSS	298.00
5"	5.015	500AWBPSTAL	123.75	500AWBPSTSS	450.00
6"	6.020	600AWBPSTAL	142.00	600AWBPSTSS	474.00
8" BL	8.035	801AWBPSTAL ¹	440.00	---	---



¹ Dixon and Boss-Lock cam and groove couplings do not interchange in the 8" size.

Dixon Couplers for Welding

Feature:

- not all configurations are stocked
- Boss-Lock versions are also available, consult Dixon for pricing and availability
- line drawings are for reference only, consult Dixon for specific dimensions
- final weld preparation, as with all weld fittings, is the responsibility of the welder



socket weld to schedule 40 pipe

Size	Bore	356T6 Aluminum		316 Stainless Steel	
		Part #	Price/E	Part #	Price/E
¾"	1.065	---	---	75DWSPSS	\$152.00
1"	1.330	100DWSPAL	\$55.00	100DWSPSS	126.20
1½"	1.915	150DWSPAL	61.80	150DWSPSS	153.00
2"	2.390	200DWSPAL	74.25	200DWSPSS	168.75
3"	3.530	300DWSPAL	71.80	300DWSPSS	268.80
4"	4.530	400DWSPAL	98.00	400DWSPSS	351.00
5"	5.562	500DWSPAL	227.00	500DWSPSS	691.00
6"	6.655	600DWSPAL	236.90	600DWSPSS	772.50
8"	8.711	800DWSPAL ¹	990.90	---	---



¹ Dixon and Boss-Lock cam and groove couplings *do not interchange in the 8" size*. The 8" Dixon design has 4 cam arms.

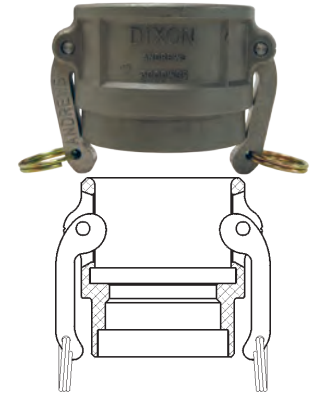

butt weld to schedule 40 pipe / socket weld to nominal OD tubing

Size	Bore	356T6 Aluminum		316 Stainless Steel	
		Part #	Price/E	Part #	Price/E
¾"	.765	---	---	75DWPSTSS	\$125.90
1"	1.015	---	---	100DWPSTSS	126.20
1½"	1.515	150DWPSTAL	\$61.80	150DWPSTSS	153.00
2"	2.015	200DWPSTAL	57.70	200DWPSTSS	168.75
3"	3.015	300DWPSTAL	71.80	300DWPSTSS	268.80
4"	4.015	400DWPSTAL	93.90	400DWPSTSS	378.00
5"	5.015	500DWPSTAL	172.00	---	---
6"	6.020	600DWPSTAL	236.90	---	---

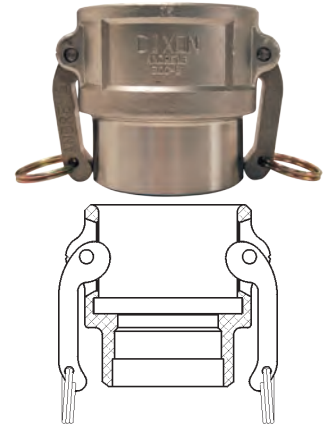

EZ Boss-Lock Couplers for Welding

socket weld to schedule 40 pipe

Size	Bore	316 Stainless Steel	
		Part #	Price/E
¾"	1.065	RDWSP075EZ	\$214.25
1"	1.330	RDWSP100EZ	199.80
1½"	1.915	RDWSP150EZ	208.00
2"	2.390	RDWSP200EZ	215.30
3"	3.530	RDWSP300EZ	299.00
4"	4.530	RDWSP400EZ	356.00
6"	6.655	RDWSP600EZ	695.75

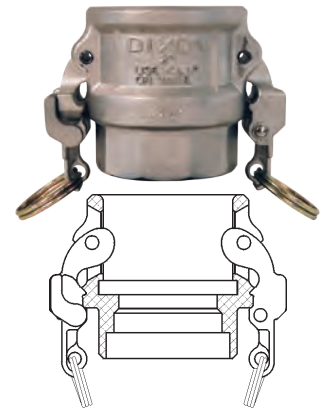

butt weld to schedule 40 pipe / socket weld to nominal OD tubing

Size	Bore	316 Stainless Steel	
		Part #	Price/E
¾"	.765	RDWBPST075EZ	\$153.40
1"	1.015	RDWBPST100EZ	159.65
1½"	1.515	RDWBPST150EZ	221.45
2"	2.015	RDWBPST200EZ	227.00
3"	3.015	RDWBPST300EZ	307.00
4"	4.015	RDWBPST400EZ	380.00
6"	6.020	RDWBPST600EZ	554.00

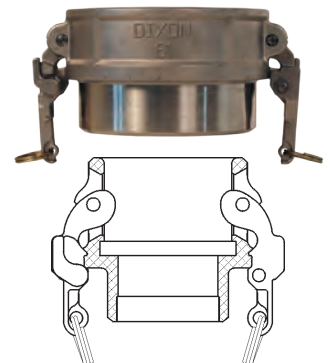

Railroad Tank Car Connections

Features:

- all swivel nuts have standard 5" Railroad Tank Car thread
- supplied with a Buna-N gasket in the threaded end, other gaskets available on page 65
- also available in other materials and in 2" and 2½" sizes, consult Dixon for pricing and availability

Style A



Stainless steel railroad tank car connections are not compatible with aluminum and brass.



Male Adapter	Swivel Nut	Elbow	316 Stainless Steel Part #	Price/E
3"	5"	120°	RTCA30	\$815.00
4"	5"	110°	RTCA40¹	998.00

¹ parts are produced as a welded fabrication

Style F

Features:

- 4" TTMA flange can be bolted to sight glass; API adapter or other dry disconnect
- 110° elbow
- supplied with PTFE Buna-N envelope gasket



TTMA Flange	Swivel Nut	Part #	Aluminum	Price/E
4"	5"	ATCF40¹		\$708.00

¹ part is produced as a welded fabrication

Style GF

Features:

- 4" TTMA flange can be bolted to sight glass; API adapter or other dry disconnect
- 110° elbow



TTMA Flange	Boss-lock Coupler	Part #	Aluminum	Price/E
4"	4"	NEW ATCGF40		\$530.25

Style S

Feature:

- 110° elbow



Shank Size	Swivel Nut	Part #	Aluminum	Price/E
4"	5"	ATCS40		\$334.50

Railroad Tank Car Connections Style T

Features:

- 3" threaded end has a 120° elbow
- 4" threaded end has a 110° elbow

Male NPT	Swivel Nut	Iron		Aluminum	
		Part #	Price/E	Part #	Price/E
3"	5"	TCT30	\$265.00	ATCT30	\$292.00
4"	5"	TCT40	320.00	ATCT40	360.00



C

Style T



Stainless steel railroad tank car connections are not compatible with aluminum and brass.

Features:

- 3" threaded end has a 120° elbow
- 4" threaded end has a 110° elbow

Male NPT	Swivel Nut	316 Stainless Steel	
		Part #	Price/E
3"	5"	RTCT30	\$665.00
4"	5"	RTCT40	780.00



Dixon x Coupler Tank Car

Features:

- parts are produced as a welded fabrication
- pressure rating is based on the seal of the mating part, see ratings on page 29

Coupler	Male Tank Car Thread	Aluminum	
		Part #	Price/E
4"	5"	400DWX5TC	\$500.00



EZ Boss-Lock x Coupler Tank Car

Features:

- parts are produced as a welded fabrication
- pressure rating is based on the seal of the mating part, see ratings on page 29

Coupler	Male Tank Car Thread	Aluminum	
		Part #	Price/E
4"	5"	AD400ALEZMTC	\$575.80



2014
NEW

C

Railcar Unloading Assemblies

Features:

- robust aluminum body construction
- removable, easy carry handle
- safe and reliable - valves will not open unless fittings are properly connected
- API configuration uses stainless steel springs on the adapter and coupler for corrosion resistance



Assembly with Dry Disconnect Adapter

Adapter Size	Swivel Nut Size	Aluminum	
		Part #	Price/E
4"	5"	ATC40ASSDDA	\$2629.40

Dry Disconnect Couplers

Female NPT	Body Size	Aluminum	
		Part #	Price/E
4"	164 mm	DDC400AL	\$3958.40



TTMA Flange	Body Size	Aluminum	
		Part #	Price/E
4"	164 mm	DDC400AL164TTMA	\$5141.00

Assembly with API Adapter



Adapter Size	Swivel Nut Size	Aluminum	
		Part #	Price/E
4"	5"	ATC40ASSAPI	\$1860.90

API Coupler



TTMA Flange	Body Size	Aluminum	
		Part #	Price/E
4"	4"	5300BC	\$2580.00

Build It Your Way

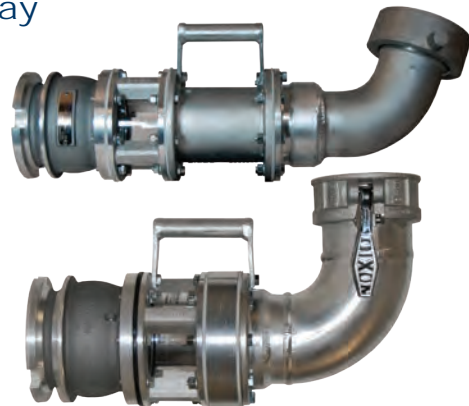

- multiple configurations available, consult Dixon for pricing and availability

Tank Truck Flanged Sight Flow Indicators

- Due to the proprietary blending of petroleum products, Dixon recommends that the thermoplastic tubing and the gaskets be immersion tested in the product to be handled to ensure compatibility (not compatible with crude oil).
- for tank truck flange gaskets, see page 54
- for dimensional information on tank truck flange drilling, see page 822
- maximum flange bolt torque is 200 in-lb (inch pounds)



C

TTMA pattern flanged short sight flow indicators

Features:

- durable cast aluminum housing replaces competitions all acrylic sight glass
- allows for visual identification of the fuel grade prior to opening the valve
- works with tank truck flanged butterfly valves found on gasoline trucks
- low cost sight glass tube can be easily replaced

Size	Width	Aluminum	
		Part #	Price/E
4"	1 3/4"	5200-SFI	\$180.95



sight flow indicator with 4 3/8" flow

Features:

- allows for visual identification of the fuel grade prior to opening the valve
- works with tank truck flanged butterfly valves found on gasoline trucks
- larger ID 4 3/8" flow indicator allows tank truck flanged butterfly valves to connect to either end of the indicator
- rated to **150 PSI**

Size	Width	Aluminum		Opt Qty
		Part #	Price/E	
4"	3 1/4"	5201-SFI	\$256.25	5



replacement parts

Description	Used on	Part #	Price/E
replacement Baylast O-rings, sight glass and retaining ring	5201-SFI	5201-SFI-RK1	\$84.45
Buna-N O-ring		O249BU	4.75

sight flow indicator with 4" flow

Features:

- allows for visual identification of the fuel grade prior to opening the valve
- 4" flow diameter

Size	Aluminum		Opt Qty
	Part #	Price/E	
4"	4-1460-AL	\$190.10	10

replacement parts

Description	Part #	Price/E	Opt Qty
plexiglass insert	4PSG	\$84.00	10
Buna-N O-ring	O246BU	4.25	10



TTMA Flange Screen

Feature:

- stainless steel screen is encapsulated in an FKM gasket

Size	Description	Stainless Steel	
		Part #	Price/E
4"	screen with 1" square holes	TTFS4SS	\$150.00

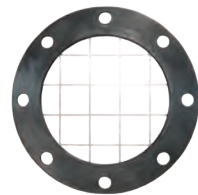

TTMA Flange Spacer with 1/2" Port

Size	Description	Aluminum	
		Part #	Price/E
4"	flange spacer with 1/2" female NPT port	TTFS4AL-FP50	\$185.60



TTMA Series Flange Adapters

Application:

- provides an easy way to quickly convert threaded components to a standard TTMA flange configuration

C

Features:

- more durable than welded fabrications due to the solid cast lightweight aluminum design
- design improves flow through adapter even on the 3" reducer
- compact size reduces the overall space needed to install
- for flange drilling standards, see page 822

Male Threaded

TTMA flange x standard male NPT



TTMA Flange	Male NPT	Aluminum	
		Part #	Price/E
3"	3"	TTF3AL-3MT	\$87.50
4"	3"	TTF4AL-3MT	65.90
4"	4"	TTF4AL-4MT	61.10

Extended Length - Male Threaded

TTMA flange x extended length male NPT



TTMA Flange	Male NPT	Aluminum	
		Part #	Price/E
4"	3"	TTF4AL-3EMT	\$87.50
4"	4"	TTF4AL-4EMT	102.15

Female Threaded

TTMA flange x female NPT



TTMA Flange	Female NPT	Aluminum	
		Part #	Price/E
4"	3"	TTF4AL-3FT	\$78.35
4"	4"	TTF4AL-4FT	78.05

Slip-on

TTMA flange x slip-on



TTMA Flange	Pipe Size	Aluminum	
		Part #	Price/E
4"	4"	TTF400SP	\$67.00

API Couplers

Features:

- completely modular, coupler can be built with various face seal combinations to be compatible with different alternative fuel / performance levels and applications
- 4" TTMA inlet mounting flange
- 5 cam design for easy alignment and tight connection
- ball-end handle for easy, comfortable operation
- no special tools needed for maintenance
- shaft seals can be changed without removing coupler from loading arm
- link, shaft, pin and crank: hardened 17-4PH stainless steel
- cam: stainless steel
- weight: 20 lbs.
- maximum working pressure: **150 PSI**
- peak surge pressure: 350 PSI
- operating temperature: **-20°F to 400°F** (FKM-B seals)
- maximum flow rate: 600 GPM
- pressure drop: 3 to 4 PSI
- replacement parts are available, contact Dixon

C



API coupler with bonded nose seal

Seal Material	Part #	Price/E
Buna	5300	\$2343.25
FKM-B	5300B	2577.60
FKM-B GFLT	5300G	2694.50
FKM-B with stainless wave spring	5300BC ¹ NEW	2580.00

API coupler with replaceable nose seal

Seal Material	Part #	Price/E
Buna	5400	\$2434.95
FKM-B	5400B	2678.45
FKM-B GFLT	5400G	2799.55

¹ has stainless steel internal springs and is recommended for crude oil service

Load API Valves

Application:

- Used for bottom loading of petroleum tankers, typically mounted to the piping below each tank compartment using the built-in 4" TTMA flange connection.

Description	Part #	Price/E
load only API valve without sight glass, ALH nose ring	5204LNG	\$547.50
load only API valve without sight glass, Baylast™ seal, stainless steel springs	5204LSNG ¹	643.75 NEW
load only API valve without sight glass, Baylast™ seal, stainless steel springs with 1/2" FNPT drain port	5204LSNGP ¹	721.00 NEW



¹ has stainless steel internal springs and is recommended for crude oil service

4" Hose Fittings for Tank Car Unloading

C



TTFST40CS

Size	Description	Carbon Steel	
		Part #	Price/E
4"	TTMA flange x crimp hose shank	TTFST40CS	\$222.50
4"	150# flange x crimp hose shank	FST40CS	182.20
4"	male NPT x crimp hose shank	STC40CS	63.65

King Crimp Style Ferrules



Only use the crimp style shanks with the crimp style sleeves and ferrules. Due to differences in dimensions and tolerances for safety reasons, do not interchange other manufacturer's products with Dixon products.



Hose ID	Hose OD		Carbon Steel Part #
	From ¹	To ¹	
4"	xxx	xxx	CF400-xxxCS

¹ refer to page 17 for crimp ferrule part numbers based on hose OD

Dixon Tank Car Adapters



Stainless steel adapters are not compatible with the aluminum and brass adapters.



Features:

- standard 5" Railroad Tank Car thread
- supplied with a Buna-N gasket in the threaded end, see next page for other gaskets

Size	356T6 Aluminum		Brass		Iron		316 Stainless Steel	
	Part #	Price/E	Part #	Price/E	Part #	Price/E	Part #	Price/E
2"	200-TCA-AL	\$121.60	---	---	---	---	200-TCA-SS	\$693.00
3"	300-TCA-AL	105.00	300-TCA-BR	\$350.00	300-TCA-MI	\$257.00	300-TCA-SS	737.40
4"	400-TCA-AL	119.10	400-TCA-BR	420.00	---	---	400-TCA-SS	815.00



Features:

- standard 5" Railroad Tank Car thread
- 45° tank car swivel adapter
- unit has a long handle brass swivel nut and a swivel retaining ring
- supplied with a Buna-N gasket in the threaded end, see next page for other gaskets

Size	356T6 Aluminum	
	Part #	Price/E
4"	40A-45TCAL	\$474.00

Dixon Railroad Tank Car Gaskets

Old Style

Feature:

- for use with Dixon fittings

Size	OD	ID	Thick	Material	Part #	Price/E
5"	5-1/4"	3-1/2"	3/16"	leather	G9	\$15.00



C

Standard

Feature:

- for use with Dixon fittings

Size	OD	ID	Thick.	Material	Part #	Price/E
5"	5-1/4"	3-7/8"	1/8"	Buna-N	500GTCABU	\$6.55
5"	5-1/4"	3-7/8"	1/8"	FKM	500GTCAVI	53.50
5"	5-1/4"	3-7/8"	1/8"	fuel grade Buna	500GTCABF	6.25
5"	5-5/16"	3-7/8"	3/16"	FKM	500GTCAVITHK	32.00 NEW



PTFE Envelope

Features:

- for use with Dixon fittings
- may be too thick for insertion in some older Dixon fittings

Size	OD	ID	Thick	Material	Part #	Price/E
5"	5-1/4"	3-13/16"	3/16"	PTFE with Buna-N filler	500GTCATF	\$65.00
5"	5-1/4"	3-13/16"	3/16"	PTFE with FKM filler	500GTCATV	112.00

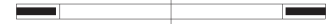

Wrenches

Pin Lug

Feature:

- used on aluminum and iron tank car nuts

Part #	Iron	Price/E
G10		\$115.00



Long Handle

Feature:

- used on stainless steel tank car nuts

Part #	Iron	Price/E
LHW		\$372.00



Boss-Lock PF Cam and Groove

Applications:

- The shank design on these fittings was developed specifically for chemical transport hoses having Crosslinked Polyethylene (XLPE) or Ultra High Molecular Weight Polyethylene (UHMW) tubes, where shank retention can be a problem when using conventional band clamps.

Features:

- in testing tank transport hoses from a wide variety of manufacturers, the Boss-Lock-PF fitting showed significant improvement in hose coupling retention over the conventional cam and groove shank design
- for best results we recommend the use of 3/4" wide band clamps found on pages 369 and 370
- other sizes available, consult Dixon for pricing and availability



female coupler x PF hose shank

EZ Boss-Lock type C coupler x phono finish hose shank

Size	316 Stainless Steel		Opt Qty
	Part #	Price/E	
2"	RC200EZPF	\$180.00	10
3"	RC300EZPF	275.00	5



male adapter x PF hose shank

type E adapter x special phono finish shank

Size	316 Stainless Steel		Opt Qty
	Part #	Price/E	
2"	RE200PF	\$111.00	10

Cam and Groove Hydrant Adapters



female NST x male adapter

Features:

- pin lugs allow for easy connection using standard spanner and hydrant wrenches (pages 618 and 619)
- supplied with a Buna-N washer in the threaded end

Female NST Thread	Male Adapter	Brass		Aluminum	
		Part #	Price/E	Part #	Price/E
1½"	1½"	HA1515ADP	\$75.50	AHA1515ADP	\$56.05
2½"	2½"	HA2525ADP	83.30	AHA2525ADP	52.50

Replacement Washers



ID	OD	Thickness	Buna-N	
			Part #	Price/E
1-9/16"	2-1/16"	1/8"	SW150	\$2.00
2-9/16"	3-3/16"	3/16"	SW250	3.20

Swaged Cam and Groove

Applications:

- Developed specifically for chemical transport hoses having Crosslinked Polyethylene (XLPE) or Ultra High Molecular Weight Polyethylene (UHMW) tubes. Swaged Boss-Lock provides you with a permanently attached cam and groove fitting when superior coupling retention is required.

Features:

- in testing tank transport hoses from a wide variety of manufacturers, the swaged Boss-Lock fitting proved itself to be the clear winner in overall performance
- also available on special order for other sizes or hose OD's, consult the factory for pricing and availability
- special equipment required for installation*, consult Dixon for pricing and availability or refer to page 414 for more information

EZ Boss-Lock type C coupler with ferrule

Size	Hose OD		316 Stainless Steel	
	from	to	Part #	Price/E
¾"	1-6/64"	1-22/64"	RC075EZ-70	\$130.70
1"	1-29/64"	1-35/64"	RC100EZ-20	137.10
1"	1-36/64"	1-44/64"	RC100EZ-70	141.40

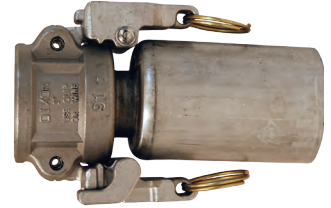

coupler x hose shank with ferrule

Boss-Lock type E adapter with ferrule

Size	Hose OD		316 Stainless Steel	
	from	to	Part #	Price/E
¾"	1-6/64"	1-22/64"	RE075-1370	\$91.50
1"	1-29/64"	1-35/64"	RE100-1620	69.00
1"	1-36/64"	1-44/64"	RE100-1770	76.30



adapter x hose shank with ferrule

Notched Ferrules

Size	Hose OD		304 Stainless Steel	
	from	to	Part #	Price/E
1½"	1-60/64"	2-12/64"	GAS2334NO	\$34.80
1½"	2-4/64"	2-22/64"	GAS2370NO	37.20
2"	2-30/64"	2-44/64"	GAS2709NO	31.80
2"	2-42/64"	2-54/64"	GAS2885NO	66.25
3"	3-30/64"	3-46/64"	GAS3760NO	45.40
3"	3-47/64"	3-54/64"	GAS3885NO	62.10
4"	4-40/64"	4-47/64"	GAS5010NO	258.75



Dixon stems and ferrules are specifically designed to be used together as a coupling system.

Due to differences in dimensions and tolerances for safety reasons, do not use other manufacturer's stems or ferrules with Dixon Holedall products.

Notched Cam and Groove

Features:

- coupling can be removed from a damaged hose by cutting away the ferrule, without necessarily damaging the fitting, *after inspection of the fitting to determine its suitability for reuse*, it can be reinstalled into another hose by using a *new ferrule*
- system allows you to better manage your inventories, you can stock one coupling and two ferrules, and cover the same hose range with less inventory, *you must purchase a fitting and the matching ferrule to create an assembly*
- for use with notched ferrules on previous page



Dixon stems and ferrules are specifically designed to be used together as a coupling system. Due to differences in dimensions and tolerances for safety reasons, do not use other manufacturer's stems or ferrules with Dixon products.

Couplers

EZ Boss-Lock type C with notched shank



female coupler x
notched hose shank

Size	316 Stainless Steel	
	Part #	Price/E
1½"	RC150EZNO	\$113.75
2"	RC200EZNO	121.30
3"	RC300EZNO	208.20
4"	RC400EZNO	310.85

Boss-Lock type C with notched shank



female coupler x
notched hose shank

Size	316 Stainless Steel	
	Part #	Price/E
1½"	RC150BLNO	\$118.00
2"	RC200BLNO	116.80
3"	RC300BLNO	199.40
4"	RC400BLNO	297.00

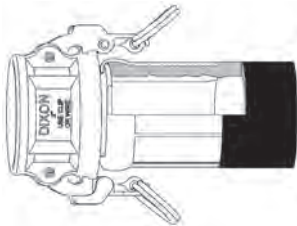

crimped assembly

Contact Dixon for swage and crimp recommendations.

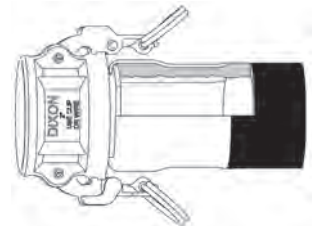

swaged assembly

Adapters

Boss-Lock type E with notched shank



male adapter x
notched hose shank

Size	316 Stainless Steel	
	Part #	Price/E
1½"	RE150NO	\$61.00
2"	RE200NO	65.30
3"	RE300NO	126.00
4"	RE400NO	246.90



swaged assembly

Contact Dixon for swage and crimp recommendations.



crimped assembly

Dixon Cam and Groove with Notched NOS Shank

Features:

- system allows you to better manage your inventories, you can stock one stem and two ferrules, and cover the same hose range with less inventory, *you must purchase a fitting and the matching ferrule to create an assembly*
- for hose outside diameters of 2-4/64" and below, *the couplings are crimp only*
- for hose outside diameters of 2-5/64" and above, the couplings can be crimped or swaged
- for use with notched ferrules at bottom of the page
- see pages 282 and 419 for male NPT notched NOS fittings



Only use the NOS shank with the NOS ferrules. Due to differences in dimensions and tolerances for safety reasons, do not use other manufacturer's stems or ferrules with Dixon products.

Couplers

Dixon type C with NOS shank

Size	316 Stainless Steel	
	Part #	Price/E
1½"	150CNOSSS ¹	\$80.00
2"	200CNOSSS	85.10
3"	300CNOSSS	168.90

¹ part will be discontinued as stock is depleted



female coupler x notched NOS hose shank

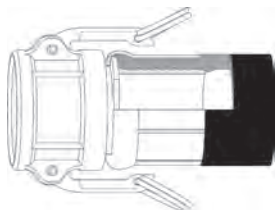

crimped assembly

Contact Dixon for swage and crimp recommendations.

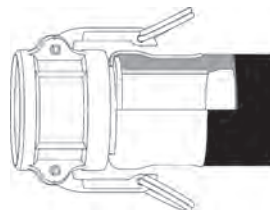

swaged assembly

Adapters

type E with NOS shank

Size	316 Stainless Steel	
	Part #	Price/E
1½"	150ENOSSS ¹	\$38.00
2"	200ENOSSS	50.60
3"	300ENOSSS	101.00

¹ part will be discontinued as stock is depleted



male adapter x notched NOS hose shank



swaged assembly

Contact Dixon for swage and crimp recommendations.



crimped assembly

Notched NOS Ferrules

Size	Hose OD		304 Stainless Steel	
	from	to	Part #	Price/E
1½"	1-60/64"	2-12/64"	GAS2334NOS	\$31.90
1½"	2-4/64"	2-22/64"	GAS2370NOS	34.50
2"	2-30/64"	2-44/64"	GAS2709NOS	31.50
2"	2-42/64"	2-54/64"	GAS2885NOS	64.40
3"	3-30/64"	3-46/64"	GAS3760NOS	46.35
3"	3-47/64"	3-54/64"	GAS3885NOS	63.00



Strap-Grip Saddles and Fittings

C

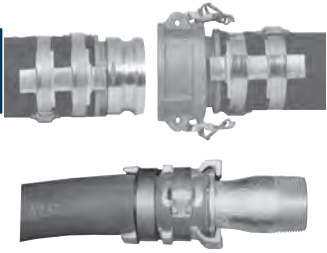

Features:

- design provides greater resistance to end pull than conventional band clamps
- only the fittings shown below are designed for use with Strap-Grip Saddles
- saddles are sold in pairs and designed for use with 3/4" or 5/8" wide band clamps
- bands must be purchased separately
- band clamps should first be applied to the OD to seal the hose, then Strap-Grip saddles should be banded over the initial clamp to anchor the fitting in the hose

saddles only



saddles

Size	Hose OD		Plated Iron	
	from	to	Part #	Price/E ¹
1½"	1-13/16"	2-1/8"	SGS150	\$14.40
2"	2-5/8"	3"	SGS200	16.90
3"	3-1/2"	3-7/8"	SGS300	21.40
4"	4-9/16"	5-1/8"	SGS400	24.40
6"	6-1/2"	7-1/16"	SGS600	45.00

¹ prices are a for two saddle set

male NPT x hose shank



male NPT x hose shank

Size	Schedule 40 Plated Carbon Steel		Schedule 40 Stainless Steel		Schedule 80 ¹ Plated Carbon Steel	
	Part #	Price/E	Part #	Price/E	Part #	Price/E
1½"	LP21	\$60.00	---	---	LP21-80	\$69.00
2"	LP26	53.20	---	---	LP26-80	71.85
3"	LP36	125.00	RLP36 ²	\$221.40	---	---
4"	LP46	164.00	RLP46 ²	375.00	---	---
6"	LP66	340.00	---	---	---	---

¹ Schedule 80 stems meet NFPA 58 standard

² tubular steel construction

Boss-Lock type C coupler x hose shank



female coupler x hose shank

Size	316 Stainless	
	Part #	Price/E
1"	RC100CEZ	\$120.20
1½"	RC150CEZ	170.00
2"	RC200CEZ ¹	152.25

¹ item will be discontinued as inventory is depleted

Dixon Standard Handle Assemblies

Features:

- stainless steel pins standard with all assemblies
- roll pins are 302 stainless and solid pins are 303 stainless
- pull rings are standard on sizes 1¼" thru 6", pull rings are optional on other sizes

C



Coupler Size	Description	Brass		316 Sintered Stainless Steel		316 Investment Stainless Steel	
		Part #	Price/E	Part #	Price/E	Part #	Price/E
½"	cam arm and pin	---	---	50-HP-SP	\$4.50	---	---
¾"	cam arm and pin	---	---	75-HP-SP	4.15	---	---
1"	cam arm and pin	---	---	100-HP-SP	5.10	---	---
1¼" - 2½"	cam arm, ring and pin	200-HRP-BR	\$8.90	200-HRP-SP	6.85	---	---
2"	cam arm, ring and pin	---	---	---	---	200-HSCRPSI	\$12.00
3"	cam arm, ring and pin	---	---	---	---	300-HSCRPSI	15.50
3" - 5"	cam arm, ring and pin	300-HRP-BR	9.65	300-HRP-SP	8.20	---	---
6"	cam arm, ring and pin	600-HRP-BR	38.65	---	---	600-HRP-SI	57.70
8"	cam arm and pin for new coupler design	800-HNP-BR	69.50	---	---	---	---

Locking Handle for Dixon Dust Caps

Feature:

- not supplied with pins

Coupler Size	Hole Diameter	Brass		316 Investment Stainless Steel ^{NEW}	
		Part #	Price/E	Part #	Price/E
2"	9/32"	200-LH-BR	\$19.50	200-LH-SI	\$18.00
3"	5/16"	300-LH-BR	21.00	300-LH-SI	19.00
4"	3/8"	400-LH-BR	25.10	400-LH-SI	22.00



Paddle Handle for Dixon Couplings

Feature:

- not supplied with pins

Coupler Size	Brass	
	Part #	Price/E
3" and 4"	300H-PADBR	\$34.50



Coupler Size	316 Investment Cast Stainless Steel	
	Part #	Price/E
3" and 4"	300H-PADSS	\$29.75



Boss-Lock Standard Handle Assemblies

assembly includes cam arm, pin and pull ring safety clip

Coupler Size	Brass		316 Invest. Cast Stain. Steel		Plated Iron	
	Part #	Price/E	Part #	Price/E	Part #	Price/E
¾" - 1"	BHSC175	\$12.85	RHSC175	\$15.95	---	---
1¼" - 2½"	BHSC152	12.75	RHSC152	19.40	IHSC152	\$11.00
3" and 4"	BHSC34	14.90	RHSC34	29.00	IHSC34	11.00



assembly includes cam arm, pin and pull ring

Coupler Size	Brass		Plated Iron	
	Part #	Price/E	Part #	Price/E
6" and 8"	BH6	\$42.60	IH6	\$34.00



EZ Boss-Lock Handles

Features:

- investment cast stainless steel cam arm and lever
- 316 stainless steel spring
- stainless steel pin, washer, plated carbon steel pull ring



Coupler Size	316 Stainless Steel	
	Part #	Price/E
3/4" - 1"	RHEZ175	\$21.40
1 1/4" - 2 1/2"	RHEZ152	24.70
3" and 4"	RHEZ34	38.50
6" and 8"	RHEZ6	62.40

! Under no circumstances should the EZ Boss-Lock cam arms be used on any fitting not specifically produced for their use. The aluminum, brass and iron are made from sand castings. To ensure proper functioning of the EZ Boss-Lock cam arm assemblies, we sort the castings to ensure there is sufficient length and orientation on the lugs on the main casting to engage the lever. We also buff or grind the rougher sand cast surface to ensure that the lever will move freely. *The EZ Boss-Lock cam arms cannot be retrofitted onto existing aluminum, brass or plated iron Boss-Lock already in service.*

Witches Hat Strainers

Features:

- used with female cam and groove couplings
- pre-attached Buna-N gasket



Size	304 Stainless Steel		Buna-N Gasket	
	Part #	Price/E	Part #	Price/E
3"	WH300-A	\$36.25	WH300-G	\$9.50
4"	WH400-A	44.70	WH400-G	10.50

Disk Strainers

Features:

- threads into bottom of female NPT fitting to protect equipment from large contaminants
- 304 stainless steel parts are investment castings



Size	Hole Size	6061T6 Aluminum		304 Stainless Steel	
		Part #	Price/E	Part #	Price/E
2"	1/4"	SDA200	\$21.00	SDS200	\$29.00
3"	1/4"	SDA300	24.00	SDS300	40.00
4"	1/4"	SDA400	37.80	SDS400	61.50

Pull Ring Safety Clips for Boss-Lock Couplings



Coupler Size	Carbon Steel		316 Stainless Steel	
	Part #	Price/E	Part #	Price/E
3/4" - 1"	---	---	100PRSCSS	\$2.50
1 1/4" - 2 1/2"	200PRSCCS	\$2.10	200PRSCSS	3.00
3" and 4"	300PRSCCS	2.10	300PRSCSS	3.00

Stainless Steel Pull Ring



304 Stainless Steel	
Part #	Price/E
R200SS	\$1.60

Clips and Lanyards for Boss-Lock Couplings

Features:

- carbon steel clip
- nylon lanyard



Coupler Size	Part #	Price/E
3/4" - 1"	ACL4	\$3.30
1 1/4" - 4"	ACL2	3.15

Features:

- carbon steel clip
- no lanyard supplied with this clip



Coupler Size	Part #	Price/E
6"	ACL3	\$6.50

Locking Cam Arm Velcro® Straps

Applications:

- used on the female end of the cam and groove coupler
- use with cam and groove couplers to prevent spills, secure from damage, and hold in place during transport

Feature:

- high visibility orange hook and loop with metal buckle provides strength, durability and long life

Length	Used On	Part #	Price/E
12"	fits up to 1½" coupler	CVS12	\$9.25
18"	fits up to 3" coupler	CVS18	10.00
24"	fits up to 5" coupler	CVS24	11.25
36"	fits up to 8" coupler	CVS36	12.00



coupler sold separately

2014
NEW

C

Features:

- for use with Boss-Lock couplings
- includes a pull ring, chain and AC3 clip

Part #	Price/E
BLCA152CS	\$9.10



Carbon Steel Clip Assembly

Feature:

- .072 stainless steel wire

Stainless Steel Part #	Price/E
AC7	\$2.25



Clip for Boss-Lock Couplings

Feature:

- breaking strength: 160 lbs.

304 Stainless Part #	Overall Length	Price/E
LR7	7"	\$8.00



Lanyard for Boss-Lock Couplings

Jack Chains with S-Hooks

Length	Material	Part #	Price/E	Opt Qty
6"	brass	CH-B-6	\$8.25	10
12"	brass	CH-B-12	9.25	10
24"	brass	CH-B-24	18.90	---
12"	carbon steel	CH-C-12	7.90	10
6"	stainless	CH-SS-6	8.75	10
12"	stainless	CH-SS-12	11.95	10
24"	stainless	CH-SS-24	18.60	10



Sash Chains with Pull Rings

Feature:

- brass chain, plated steel pull ring

Length	Part #	Price/E
4½"	J125	\$8.00
6½"	J150	8.95
8½"	J300	12.00
12¾"	J500	16.90



PVC Coated Lanyards

Features:

- PVC coated carbon steel with aluminum crimp sleeves
- one end factory crimped, one end uncrimped for field installation

Length	Part #	Price/E
15"	CAL15	\$7.00
25"	CAL25	8.45



Cam and Groove Gaskets

C

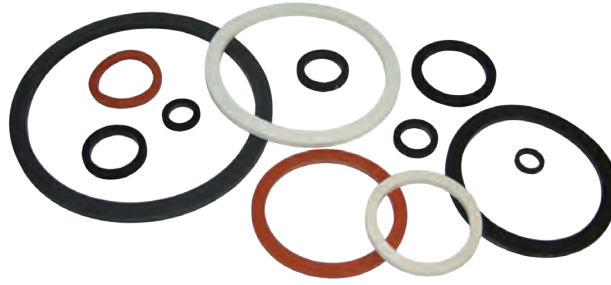

Feature:

- white neoprene and white Buna-N gaskets all contain FDA approved materials

Size	Buna-N		FKM		extra thick Buna-N		Ethylene Propylene	
	Part #	Price	Part #	Price/E	Part #	Price/E	Part #	Price/E
1/2"	50-G-BU	\$1.20	50-G-VI	\$4.90	---	---	---	---
3/4"	75-G-BU	1.20	75-G-VI	6.20	---	---	75-G-EPR	\$2.05
1"	100-G-BU	1.20	100-G-VI	8.75	100GTHK	\$1.75	100-G-EPR	2.05
1 1/4"	125-G-BU	1.20	125-G-VI	12.50	125GTHK	2.25	125-G-EPR	2.30
1 1/2"	150-G-BU	1.35	150-G-VI	12.30	150GTHK	2.25	150-G-EPR	2.25
2"	200-G-BU	1.20	200-G-VI	16.90	200GTHK	2.30	200-G-EPR	2.50
2 1/2"	250-G-BU	1.50	250-G-VI	20.90	250GTHK	3.00	250-G-EPR	2.70
3"	300-G-BU	1.55	300-G-VI	20.80	300GTHK	2.60	300-G-EPR	2.65
4"	400-G-BU	2.05	400-G-VI	34.80	400GTHK	3.40	400-G-EPR	3.60
5"	500-G-BU	3.75	500-G-VI	76.40	---	---	---	---
6"	600-G-BU	5.15	600-G-VI	71.50	---	---	---	---
8"	800-G-BU	22.50	800-G-VI	119.00	---	---	---	---

Size	Neoprene		white Neoprene		white Buna-N		Silicone	
	Part #	Price	Part #	Price/E	Part #	Price/E	Part #	Price/E
1/2"	---	---	---	---	---	---	---	---
3/4"	75-G-NE	\$2.20	---	---	---	---	---	---
1"	100-G-NE	2.20	---	---	---	---	---	---
1 1/4"	125-G-NE	2.25	---	---	---	---	---	---
1 1/2"	150-G-NE	2.30	150-G-WNE	\$4.50	---	---	150-G-SIL	\$3.80
2"	200-G-NE	2.50	200-G-WNE	6.70	---	---	200-G-SIL	4.15
2 1/2"	250-G-NE	3.25	---	---	---	---	---	---
3"	300-G-NE	3.80	300-G-WNE	9.00	300-G-WB	\$8.95	300-G-SIL	9.00
4"	400-G-NE	4.65	400-G-WNE	9.35	400-G-WB	9.20	400-G-SIL	9.95
5"	---	---	500-G-WNE	18.80	---	---	---	---
6"	---	---	600-G-WNE	15.25	---	---	---	---
8"	---	---	---	---	---	---	---	---

Cam and Groove Fuel Gaskets



Size	Part #	Material	Price
1 1/2"	150-G-BF	Buna	\$2.00
2"	200-G-BF	Buna	2.40
3"	300-G-BF	Buna	2.70
4"	400-G-BF	Buna	3.90
3"	300GTHKBF	extra thick Buna-N	4.80
4"	400GTHKBF	extra thick Buna-N	6.35

PTFE Cam and Groove Gaskets

The torque (force) required to close the handles on a pair of cam and groove fittings will vary according to the gasket chosen. Due to the nature of the PTFE material, the various PTFE gasket designs will require the most torque, increasing as you go from envelope to encapsulated, and finally, accordion.

C

Features:



- PTFE white Buna filler (TFWB) and PTFE encapsulated silicone (TES) all contain FDA approved materials
- PTFE accordion gaskets (TFACC) are recommended for use with viscous (thick) fluids only
- encapsulated gasket pressure ratings are reduced to **125 PSI** for ¾" - 4" at ambient temperature (**70°F**)
- envelope and accordion gasket pressure ratings on page 29
- PTFE encapsulated FKM (TEV) gaskets - maximum operating temperature **200°F**
- PTFE encapsulated silicone gaskets (TES) gaskets - maximum operating temperature **225°F**
- *maximum operating temperatures for specific chemicals may be lower, contact Dixon for specific recommendations*

Envelope

Size	PTFE (TFE) with Buna-N filler		PTFE (TFE) with FKM filler		PTFE (TFE) with white Buna-N filler		PTFE (TFE) with Ethylene Propylene filler	
	Part #	Price	Part #	Price/E	Part #	Price/E	Part #	Price/E
½"	50-G-TF	\$7.70	50-G-TF-VI	\$10.75	---	---	---	---
¾"	75-G-TF	8.75	75-G-TF-VI	19.00	---	---	---	---
1"	100-G-TF	9.40	100GTFVI	20.00	---	---	---	---
1¼"	125-G-TF	11.00	125GTFVI	29.20	---	---	---	---
1½"	150-G-TF	13.00	150GTFVI	24.00	---	---	150GTFEP	\$15.50
2"	200-G-TF	14.80	200GTFVI	29.60	200GTFWB	\$15.90	200GTFEP	16.50
2½"	250-G-TF	26.00	250GTFVI	48.00	---	---	---	---
3"	300-G-TF	19.25	300GTFVI	41.50	300GTFWB	22.00	300GTFEP	20.40
4"	400-G-TF	31.00	400GTFVI	65.40	400GTFWB	40.75	---	---
5"	---	---	---	---	500GTFWB	73.00	---	---
6"	600-G-TF	75.40	600GTFVI	120.00	---	---	---	---

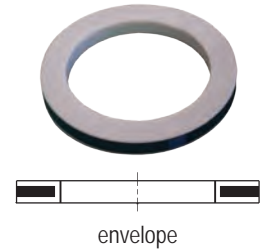

Encapsulated

Size	PTFE (FEP) encapsulated silicone		PTFE (FEP) encapsulated FKM	
	Part #	Price/E	Part #	Price/E
¾"	75-G-TES	\$33.00	75-G-TEV	\$50.00
1"	100-G-TES	33.00	100-G-TEV	49.60
1¼"	125-G-TES	37.75	125-G-TEV	55.00
1½"	150-G-TES	38.30	150-G-TEV	59.00
2"	200-G-TES	40.00	200-G-TEV	60.60
2½"	250-G-TES	48.20	250-G-TEV	79.60
3"	300-G-TES	55.00	300-G-TEV	83.50
4"	400-G-TES	74.00	400-G-TEV	121.00



Accordion

Size	PTFE (TFE)	
	Part #	Price/E
¾"	75GTFACC	\$14.80
1"	100GTFACC	16.00
1¼"	125GTFACC	20.90
1½"	150GTFACC	19.00
2"	200GTFACC	22.00
3"	300GTFACC	48.00

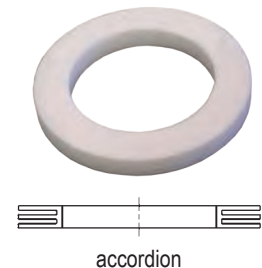

Dixon Cam and Groove Gasket Dimensions

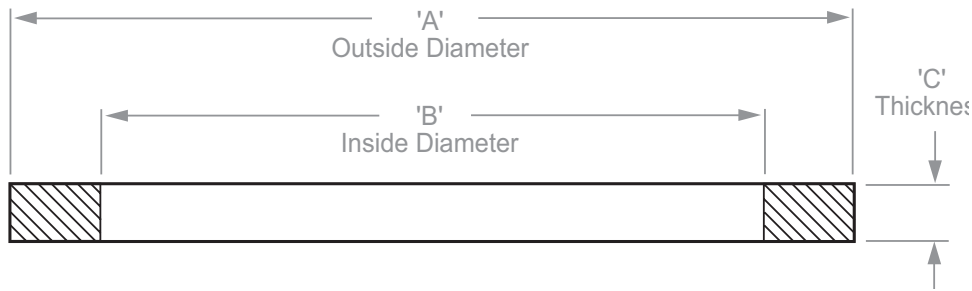

- nominal dimensions for Dixon's elastomeric cam and groove gaskets are listed
- ID's of the PTFE envelope gaskets and the PTFE accordion gaskets are $1/16''$ smaller than the ID's for the elastomeric gaskets shown below
- thickness of PTFE accordion gaskets may vary from chart below

Size	Part #	Dimensions		
		'A'	'B'	'C'
1/2"	50-G¹	1-1/32"	11/16"	.156"
3/4"	75-G	1-3/8"	7/8"	.218"
1"	100-G	1-9/16"	1-1/16"	.250"
1 1/4"	125-G	1-15/16"	1-23/64"	.250"
1 1/2"	150-G	2-3/16"	1-5/8"	.250"
2"	200-G	2-5/8"	2"	.250"
2 1/2"	250-G	3-1/8"	2-3/8"	.250"
3"	300-G	3-23/32"	3"	.250"
4"	400-G	4-7/8"	4"	.250"
5"	500-G	5-15/16"	4-7/8"	.250"
6"	600-G	7-1/16"	6"	.250"
8"	800-G¹	9-5/16"	8-1/8"	.343"



¹ No interchange standard exists for the 1/2" and 8" fittings. Generally, these sizes do not interchange with other manufacturer's products. As such, the gaskets in these sizes are not suitable for use in other manufacturers' couplings.

Dixon Cam and Groove Gasket Color Codes

Gasket Code ¹	Gasket Material	Material Color	Color code stripes (appear on the OD of the gasket or filler)
-BU	Buna-N (standard in all metal fittings)	black	1 blue
-BF	Buna (formulated for fuel service)	black	1 green
-VI	FKM	black	1 yellow
-THK	Extra Thick Buna	black	2 blue
-EPR	Ethylene Propylene	black	1 white
-NE	Neoprene	black	1 red
-WNE	White Neoprene, FDA approved material	white	none
-WB	White Buna N, FDA approved material	white	blue
-SIL	Silicone	red	none
-TF	PTFE (TFE) Envelope with Buna-N filler	white / black	1 blue
TFVI	PTFE (TFE) Envelope with FKM filler	white / black	1 yellow
TFWB	PTFE (TFE) Envelope with White Buna-N filler, FDA approved materials	white / white	blue
TFEP	PTFE (TFE) Envelope with Ethylene Propylene filler	white / black	1 white stripe
-TES	PTFE (FEP) Encapsulated Silicone core, FDA approved materials	translucent / red	none
-TEV	PTFE (FEP) Encapsulated FKM core	translucent / black	none
TFACC	PTFE (TFE) Accordion, FDA approved materials	white	none

¹ part number suffix



Since other manufacturer's coding systems vary, this chart should not be used as a reference in identifying gaskets of unknown origin.

Global Cam and Groove

Features:

- interchange with all products produced to A-A-59326D
- made to Dixon specifications and branded Dixon
- Buna seals are standard
- pressure rating for adapters is based on the seal of the mating part



- Dust caps and dust plugs are not to be used in pressure applications for safety and environmental reasons

C

Global Type A Adapters

Size	A380 Permanent Mold AL		ASTMC38000 Forged Brass		316 Investment Cast SS	
	Part #	Price/E	Part #	Price/E	Part #	Price/E
½"	G50-A-AL ¹	\$6.35	G50-A-BR ¹	\$11.80	G50-A-SS NEW	\$18.00
¾"	G75-A-AL	5.00	G75-A-BR	10.70	G75-A-SS	19.00
1"	G100-A-AL	5.10	G100-A-BR	13.70	G100-A-SS	18.60
1¼"	G125-A-AL	7.75	G125-A-BR	17.70	G125-A-SS	29.10
1½"	G150-A-AL	5.70	G150-A-BR	20.45	G150-A-SS	31.05
2"	G200-A-AL	6.05	G200-A-BR	26.70	G200-A-SS	37.45
2½"	G250-A-AL	14.60	G250-A-BR	41.05	G250-A-SS	72.30
3"	G300-A-AL	12.40	G300-A-BR	47.05	G300-A-SS	78.35
4"	G400-A-AL	19.55	G400-A-BR	82.80	G400-A-SS	138.35
5"	G500-A-AL ¹	73.60	G500-A-BR ¹	197.30	---	---
6"	G600-A-AL	51.40	---	---	G600-A-SS	248.50
8"	G800-A-AL ¹	238.55	---	---	---	---

¹ Does not interchange in the ½", 5", and 8" sizes with Dixon or Boss-Lock style cam and groove.



female NPT x male adapter

Global Type B Couplers

Size	A380 Permanent Mold AL with Brass Handles		ASTMC38000 Forged Brass		316 Investment Cast Stainless Steel		A380 Permanent Mold AL with SS Handles	
	Part #	Price/E	Part #	Price/E	Part #	Price/E	Part #	Price/E
½"	G50-B-AL ^{1,2}	\$16.20	G50-B-BR ¹	\$27.10	G50-B-SS NEW	\$29.50	---	---
¾"	G75-B-AL ²	10.75	G75-B-BR	24.45	G75-B-SS	31.45	---	---
1"	G100-B-AL	11.95	G100-B-BR	26.35	G100-B-SS	32.20	---	---
1¼"	G125-B-AL	16.30	G125-B-BR	36.70	G125-B-SS	52.45	---	---
1½"	G150-B-AL	13.65	G150-B-BR	35.70	G150-B-SS	52.10	G150-B-ALSI	\$13.65
2"	G200-B-AL	14.25	G200-B-BR	41.90	G200-B-SS	65.55	G200-B-ALSI	14.25
2½"	G250-B-AL	26.00	G250-B-BR	63.35	G250-B-SS	94.60	---	---
3"	G300-B-AL	23.60	G300-B-BR	77.70	G300-B-SS	109.35	G300-B-ALSI	23.60
4"	G400-B-AL	33.35	G400-B-BR	108.85	G400-B-SS	160.40	G400-B-ALSI	33.35
5"	G500-B-AL ¹	97.05	G500-B-BR ¹	316.10	---	---	---	---
6"	G600-B-AL	92.70	---	---	G600-B-SS	429.75	---	---

¹ Does not interchange in the ½" and 5" sizes with Dixon or Boss-Lock style cam and groove.

² supplied with stainless steel handles



female coupler x male NPT

Global Type C Couplers

Size	A380 Permanent Mold AL with Brass Handles		ASTMC38000 Forged Brass		316 Investment Cast SS		A380 Permanent Mold AL with SS Handles	
	Part #	Price/E	Part #	Price/E	Part #	Price/E	Part #	Price/E
½"	G50-C-AL ^{1,2}	\$13.15	G50-C-BR ¹	\$31.10	G50-C-SS NEW	\$28.75	---	---
¾"	G75-C-AL ²	10.70	G75-C-BR	20.40	G75-C-SS	30.40	---	---
1"	G100-C-AL	10.95	G100-C-BR	29.50	G100-C-SS	29.50	---	---
1¼"	G125-C-AL	15.50	G125-C-BR	30.25	G125-C-SS	50.35	---	---
1½"	G150-C-AL	13.20	G150-C-BR	39.60	G150-C-SS	49.80	G150-C-ALSI	\$13.20
2"	G200-C-AL	15.25	G200-C-BR	48.05	G200-C-SS	63.65	G200-C-ALSI	15.25
2½"	G250-C-AL	25.90	G250-C-BR	70.45	G250-C-SS	86.00	---	---
3"	G300-C-AL	23.55	G300-C-BR	90.95	G300-C-SS	125.45	G300-C-ALSI	23.55
4"	G400-C-AL	36.75	G400-C-BR	132.00	G400-C-SS	173.95	G400-C-ALSI	36.75
5"	G500-C-AL ¹	103.00	G500-C-BR ¹	409.20	---	---	---	---
6"	G600-C-AL	109.20	---	---	G600-C-SS	406.15	---	---
8"	G800-C-AL ¹	335.00	---	---	---	---	---	---

¹ Does not interchange in the ½", 5", and 8" sizes with Dixon or Boss-Lock style cam and groove.

² supplied with stainless steel handles



female coupler x hose shank

Global Type D Couplers

C



female coupler x female NPT

Size	A380 Permanent Mold AL with Brass Handles		ASTMC38000 Forged Brass		316 Investment Cast SS		A380 Permanent Mold AL with SS Handles	
	Part #	Price/E	Part #	Price/E	Part #	Price/E	Part #	Price/E
1/2"	G50-D-AL ^{1,2}	\$16.35	G50-D-BR ¹	\$29.90	G50-D-SS ^{NEW}	\$29.75	---	---
3/4"	G75-D-AL ²	12.10	G75-D-BR	22.75	G75-D-SS	31.35	---	---
1"	G100-D-AL	11.60	G100-D-BR	30.25	G100-D-SS	31.35	---	---
1 1/4"	G125-D-AL	16.95	G125-D-BR	35.15	G125-D-SS	52.90	---	---
1 1/2"	G150-D-AL	12.90	G150-D-BR	39.20	G150-D-SS	54.70	G150-D-ALSI	\$12.90
2"	G200-D-AL	15.05	G200-D-BR	45.35	G200-D-SS	65.60	G200-D-ALSI	15.05
2 1/2"	G250-D-AL	26.45	G250-D-BR	77.30	G250-D-SS	88.45	---	---
3"	G300-D-AL	25.15	G300-D-BR	80.95	G300-D-SS	107.45	G300-D-ALSI	25.15
4"	G400-D-AL	34.00	G400-D-BR	129.45	G400-D-SS	169.95	G400-D-ALSI	35.00
5"	G500-D-AL ¹	92.25	G500-D-BR ¹	310.90	---	---	---	---
6"	G600-D-AL	98.45	---	---	G600-D-SS	421.00	---	---

¹ does not interchange in the 1/2" and 5" sizes with Dixon or Boss-Lock style cam and groove

² stainless steel handles

Global Type E Adapters



hose shank x male adapter

Size	A380 Permanent Mold AL		ASTMC38000 Forged Brass		316 Investment Cast SS	
	Part #	Price/E	Part #	Price/E	Part #	Price/E
1/2"	G50-E-AL ¹	\$8.80	G50-E-BR ¹	\$19.20	G50-E-SS ^{NEW}	\$15.90
3/4"	G75-E-AL	4.35	G75-E-BR	19.70	G75-E-SS	16.75
1"	G100-E-AL	5.05	G100-E-BR	19.05	G100-E-SS	22.45
1 1/4"	G125-E-AL	7.55	G125-E-BR	21.35	G125-E-SS	36.10
1 1/2"	G150-E-AL	6.55	G150-E-BR	27.40	G150-E-SS	36.25
2"	G200-E-AL	8.40	G200-E-BR	38.25	G200-E-SS	50.45
2 1/2"	G250-E-AL	16.20	G250-E-BR	63.25	G250-E-SS	83.15
3"	G300-E-AL	15.15	G300-E-BR	76.75	G300-E-SS	110.25
4"	G400-E-AL	25.10	G400-E-BR	123.00	G400-E-SS	161.00
5"	G500-E-AL ¹	78.05	G500-E-BR ¹	447.95	---	---
6"	G600-E-AL	79.45	---	---	G600-E-SS	360.30
8"	G800-E-AL ¹	240.00	---	---	---	---

¹ does not interchange in the 1/2", 5", and 8" sizes with Dixon or Boss-Lock style cam and groove

Global Type F Adapters



male NPT x male adapter

Size	A380 Permanent Mold AL		ASTMC38000 Forged Brass		316 Investment Cast SS	
	Part #	Price/E	Part #	Price/E	Part #	Price/E
1/2"	G50-F-AL ¹	\$6.60	G50-F-BR ¹	\$14.70	G50-F-SS ^{NEW}	\$22.00
3/4"	G75-F-AL	5.35	G75-F-BR	13.30	G75-F-SS	23.30
1"	G100-F-AL	5.70	G100-F-BR	16.55	G100-F-SS	25.55
1 1/4"	G125-F-AL	9.40	G125-F-BR	29.65	G125-F-SS	41.20
1 1/2"	G150-F-AL	6.80	G150-F-BR	29.75	G150-F-SS	44.75
2"	G200-F-AL	7.65	G200-F-BR	34.60	G200-F-SS	53.80
2 1/2"	G250-F-AL	17.85	G250-F-BR	44.50	G250-F-SS	92.25
3"	G300-F-AL	16.85	G300-F-BR	67.55	G300-F-SS	112.05
4"	G400-F-AL	24.80	G400-F-BR	99.50	G400-F-SS	159.80
5"	G500-F-AL ¹	88.60	G500-F-BR ¹	332.10	---	---
6"	G600-F-AL	64.60	---	---	G600-F-SS	385.45

¹ does not interchange in the 1/2" and 5" sizes with Dixon or Boss-Lock style cam and groove

Global Type DC Dust Caps

Size	A380 Permanent Mold AL with Brass Handles		ASTMC38000 Forged Brass		316 Investment Cast SS		A380 Permanent Mold AL with SS Handles	
	Part #	Price/E	Part #	Price/E	Part #	Price/E	Part #	Price/E
1/2"	G50-DC-AL ^{1,2}	\$14.40	G50-DC-BR ¹	\$24.05	G50-DC-SS ^{NEW}	\$27.00	---	---
3/4"	G75-DC-AL ²	10.60	G75-DC-BR	18.10	G75-DC-SS	28.45	---	---
1"	G100-DC-AL	10.40	G100-DC-BR	22.30	G100-DC-SS	28.80	---	---
1 1/4"	G125-DC-AL	14.00	G125-DC-BR	31.25	G125-DC-SS	50.50	---	---
1 1/2"	G150-DC-AL	12.70	G150-DC-BR	34.95	G150-DC-SS	48.35	G150-DC-ALSI	\$12.70
2"	G200-DC-AL	12.40	G200-DC-BR	38.25	G200-DC-SS	56.90	G200-DC-ALSI	12.40
2 1/2"	G250-DC-AL	20.70	G250-DC-BR	44.90	G250-DC-SS	78.45	---	---
3"	G300-DC-AL	23.10	G300-DC-BR	69.90	G300-DC-SS	93.60	G300-DC-ALSI	23.10
4"	G400-DC-AL	29.25	G400-DC-BR	97.05	G400-DC-SS	126.05	G400-DC-ALSI	29.25
5"	G500-DC-AL ¹	80.00	G500-DC-BR ¹	304.90	---	---	---	---
6"	G600-DC-AL	84.35	---	---	G600-DC-SS	405.95	---	---



dust cap

¹ does not interchange in the 1/2" and 5" sizes with Dixon or Boss-Lock style cam and groove
² stainless steel handles

Global Type DP Dust Plugs

Size	A380 Permanent Mold AL		ASTMC38000 Forged Brass		316 Investment Cast SS	
	Part #	Price/E	Part #	Price/E	Part #	Price/E
1/2"	G50-DP-AL ¹	\$5.05	G50-DP-BR ¹	\$18.65	G50-DP-SS ^{NEW}	\$14.75
3/4"	G75-DP-AL	4.85	G75-DP-BR	12.80	G75-DP-SS	15.85
1"	G100-DP-AL	4.75	G100-DP-BR	14.20	G100-DP-SS	18.85
1 1/4"	G125-DP-AL	5.65	G125-DP-BR	18.75	G125-DP-SS	31.00
1 1/2"	G150-DP-AL	5.45	G150-DP-BR	17.85	G150-DP-SS	29.15
2"	G200-DP-AL	6.55	G200-DP-BR	21.20	G200-DP-SS	33.55
2 1/2"	G250-DP-AL	9.70	G250-DP-BR	34.60	G250-DP-SS	60.10
3"	G300-DP-AL	11.05	G300-DP-BR	37.40	G300-DP-SS	72.85
4"	G400-DP-AL	17.50	G400-DP-BR	62.15	G400-DP-SS	86.85
5"	G500-DP-AL ¹	48.20	G500-DP-BR ¹	201.45	---	---
6"	G600-DP-AL	44.90	---	---	G600-DP-SS	249.95



dust plug

¹ does not interchange in the 1/2" and 5" sizes with Dixon or Boss-Lock style cam and groove

Replacement Handle Assemblies for Global Couplers

For Aluminum and Brass Global Couplers

Feature:

- supplied complete with ring and pin



investment stainless



forged brass

Fits on sizes	Investment Stainless	
	Part #	Price/E
3/4"	G75HRP	\$2.70
1"	G100HRP	4.05
1 1/2" and 2"	G152HRPSI	4.60
3" and 4"	G34HRPSI	7.10
6"	G600HRPSI	20.45

Fits on sizes	Forged Brass	
	Part #	Price/E
1 1/4" - 2 1/2"	G152HRP	\$4.05
3" and 4"	G34HRP	7.10
6" and 8"	G600HRP	15.75

For Stainless Steel Global Couplers



investment stainless

Fits on sizes	Investment Stainless	
	Part #	Price/E
3/4"	G75HRPSS	\$4.15
1"	G100HRPSS	4.00
1 1/4" - 2 1/2"	G125250HRPSS	9.35
3" and 4"	G300400HRPSS	9.35
6"	G600HRPSS	20.25

Safety Clip for Global Couplers

Zinc Plated Carbon Steel	
Part #	Price/E
GSAFETYCLIP	\$0.40



Global Type DD Spool Couplers

C



Size	A380 Permanent Mold AL		316 Investment Cast SS	
	Part #	Price/E	Part #	Price/E
2"	G200-DD-AL	\$53.95	G200-DD-SS	\$129.55
3"	G300-DD-AL	75.45	G300-DD-SS	193.50
4"	G400-DD-AL	103.85	---	---

Global Type AA Spool Adapters



G300-AA-AL

Size	A380 Permanent Mold AL		316 Investment Cast SS	
	Part #	Price/E	Part #	Price/E
1"	G100-AA-AL	\$8.55	---	---
1½"	G150-AA-AL	25.00	---	---
2"	G200-AA-AL	21.60	G200-AA-SS	\$105.60
3"	G300-AA-AL	50.40	G300-AA-SS	183.35
4"	G400-AA-AL	65.80	---	---



G2030-AA-AL

jump size male spool adapter

Size	A380 Permanent Mold Aluminum	
	Part #	Price/E
1½" x 2"	G1520-AA-AL	\$32.40
2" x 3"	G2030-AA-AL	49.75
3" x 4"	G3040-AA-AL	71.10

Global Jump Size Cam and Groove

male adapter x female NPT



G3020-C-AL

Size	A380 Permanent Mold Aluminum	
	Part #	Price/E
3" x 2"	G3020-A-AL	\$42.30
4" x 3"	G4030-A-AL	52.30

female coupler x hose shank



G3020-DA-AL

Size	A380 Permanent Mold Aluminum	
	Part #	Price/E
3" x 2"	G3020-C-AL	\$52.95
4" x 3"	G4030-C-AL	68.20

female coupler x male adapter



G3020-E-AL

Size	A380 Permanent Mold Aluminum	
	Part #	Price/E
3" x 2"	G3020-DA-AL	\$58.05
4" x 3"	G4030-DA-AL	83.70
5" x 4"	G5040-DA-AL	123.60

male adapter x hose shank

Size	A380 Permanent Mold Aluminum	
	Part #	Price/E
3" x 2"	G3020-E-AL	\$27.85
4" x 3"	G4030-E-AL	57.30

Polypropylene Adapters



NOT recommended for use with PTFE gaskets

C

Features:

- manufactured from a glass-filled polypropylene
- maximum operating pressure: **125 PSI** (½" - 1"), **100 PSI** (1¼" - 2") and **75 PSI** (3" - 4"); recommendations based on the use of mating Dixon fittings at an ambient temperature of **70°F** with standard seal installed
- ½" couplers and adapters will interchange with ¾" couplers and adapters, only the threads and barbs are ½"
- 1¼" couplers and adapters will interchange with 1½" couplers and adapters, only the threads and barbs are 1¼"
- polypropylene cam and groove should not be mixed with metal fittings

type A

Size	Polypropylene		Opt Qty
	Part #	Price/E	
¾" x ½"	PPA50	\$5.20	24
¾"	PPA75	5.20	24
1"	PPA100	5.65	24
1½" x 1¼"	PPA125	5.85	24
1½"	PPA150	6.30	24
2"	PPA200	7.45	24
3"	PPA300	16.70	24
4"	PPA400	27.50	8



male adapter x female NPT

type F

Size	Polypropylene		Opt Qty
	Part #	Price/E	
¾" x ½"	PPF50	\$5.70	24
¾"	PPF75	5.70	24
1"	PPF100	6.45	24
1½" x 1¼"	PPF125	6.50	24
1½"	PPF150	6.55	24
2"	PPF200	9.00	24
3"	PPF300	21.25	24
4"	PPF400	27.50	8



male adapter x male NPT

type E

Size	Polypropylene		Opt Qty
	Part #	Price/E	
¾" x ½"	PPE50	\$5.70	24
¾"	PPE75	5.70	24
1"	PPE100	6.45	24
1½" x 1¼"	PPE125	6.50	24
1½"	PPE150	6.55	24
2"	PPE200	8.60	24
3"	PPE300	21.25	24
4"	PPE400	27.50	8



male adapter x hose shank

type P¹

Size	Polypropylene		Opt Qty
	Part #	Price/E	
¾"	PPP75	\$5.20	24
1"	PPP100	5.65	24
1½"	PPP150	6.25	24
2"	PPP200	8.35	24
3"	PPP300	16.70	24
4"	PPP400	22.00	8



dust plug¹



4" plug has a different design



¹ Dust caps and dust plugs are not to be used in pressure applications for safety and environmental reasons.

Polypropylene Adapter Elbows

Features:

- maximum operating pressure: **100 PSI** (1½" - 2"); recommendations based on the use of mating Dixon fittings at an ambient temperature of **70°F** with standard seal installed
- manufactured from a glass-filled polypropylene
- for use at elevated temperatures or other unusual operating conditions, consult Dixon



90° Elbow x FNPT

Size	Polypropylene		Opt Qty
	Part #	Price/E	
1½"	90PPA150	\$10.40	24
2"	90PPA200	11.10	24



male adapter x female NPT

90° Elbow x MNPT

Size	Polypropylene		Opt Qty
	Part #	Price/E	
1½"	90PPF150	\$12.00	24
2"	90PPF200	12.50	24



male adapter x male NPT

Polypropylene Couplers



NOT recommended for use with PTFE gaskets

C Features:

- manufactured from a glass-filled polypropylene
- supplied with EPDM gaskets, 304 stainless steel handles and pins
- polypropylene cam and groove should not be mixed with metal fittings
- maximum operating pressure: **125 PSI** (½" - 1"), **100 PSI** (1¼" - 2") and **75 PSI** (3" - 4"); recommendations based on the use of mating Dixon fittings at an ambient temperature of **70°F** with standard seal installed
- ½" couplers and adapters will interchange with ¾" couplers and adapters, only the threads and barbs are ½"
- 1¼" couplers and adapters will interchange with 1½" couplers and adapters, only the threads and barbs are 1¼"

type D

Size	Polypropylene		Opt Qty
	Part #	Price/E	
¾" x ½"	PPD50	\$14.10	24
¾"	PPD75	14.10	24
1"	PPD100	16.00	24
1½" x 1¼"	PPD125	19.20	24
1½"	PPD150	19.00	24
2"	PPD200	22.50	24
3"	PPD300	37.00	24
4"	PPD400²	72.50	8



female coupler x female NPT

type B

Size	Polypropylene		Opt Qty
	Part #	Price/E	
¾" x ½"	PPB50	\$14.10	24
¾"	PPB75	14.10	24
1"	PPB100	16.00	24
1½" x 1¼"	PPB125	19.20	24
1½"	PPB150	19.00	24
2"	PPB200	22.50	24
3"	PPB300	37.00	24
4"	PPB400²	72.50	8



female coupler x male NPT

type C

Size	Polypropylene		Opt Qty
	Part #	Price/E	
¾" x ½"	PPC50	\$14.10	24
¾"	PPC75	14.10	24
1"	PPC100	16.00	24
1½" x 1¼"	PPC125	19.20	24
1½"	PPC150	19.00	24
2"	PPC200	22.50	24
3"	PPC300	37.00	24
4"	PPC400²	72.50	8



female coupler x hose shank



dust cap¹



4" cap has 3 handles

type H¹

Size	Polypropylene		Opt Qty
	Part #	Price/E	
¾"	PPH75	\$13.60	24
1"	PPH100	15.50	24
1½"	PPH150	19.00	24
2"	PPH200	22.50	24
3"	PPH300	37.00	24
4"	PPH400²	52.75	8

locking handle pictured is only available in 1¼" thru 2"



¹ Dust caps and dust plugs are not to be used in pressure applications for safety and environmental reasons.

² 4" coupler has 3 handles

Polypropylene Coupler Elbows

Features:

- manufactured from a glass-filled polypropylene
- supplied with EPDM gaskets, 304 stainless steel handles and pins
- maximum operating pressure: **100 PSI** (1½" - 2"); recommendations based on the use of mating Dixon fittings at an ambient temperature of **70°F** with standard seal installed



• for use at elevated temperatures or other unusual operating conditions, consult Dixon.

90° Elbow x FNPT

Size	Polypropylene		Opt Qty
	Part #	Price/E	
1½"	90PPD150	\$22.20	24
2"	90PPD200	26.25	24



female coupler x female NPT

90° Elbow x Hose Shank

Size	Polypropylene		Opt Qty
	Part #	Price/E	
1½"	90PPC150	\$22.20	24
2"	90PPC200	26.25	24



female coupler x hose shank

Replacement Parts for Polypropylene Cam & Groove Handles

Used on sizes	430 Stainless Steel	
	Part #	Price/E
1/2"	61594	\$4.40
3/4"	61594	4.40
1"	61594	4.40
1 1/4"	61595	6.05
1 1/2"	61595	6.05
2"	61595	6.05
3"	61596	10.10
4"	61596	10.10



1/4", 1/2", 2"



1/2", 3/4", 1", 3", 4"

C

Gaskets

Used on sizes	EPDM	
	Part #	Price/E
1/2"	61570	\$1.20
3/4"	61570	1.20
1"	61571	1.20
1 1/4"	61572	1.85
1 1/2"	61572	1.85
2"	61574	2.10
3"	61575	2.30
4"	62797	9.40



Key Rings

Used on sizes	304 Stainless Steel	
	Part #	Price/E
1/2"	61589	\$1.40
3/4"	61589	1.40
1"	61589	1.40
1 1/4"	61589	1.40
1 1/2"	61589	1.40
2"	61589	1.40
3"	61589	1.40
4"	61589	1.40



Cam Handle Pins

Used on sizes	304 Stainless Steel	
	Part #	Price/E
1/2"	61582	\$1.30
3/4"	61582	1.30
1"	61582	1.30
1 1/4"	61585	1.90
1 1/2"	61585	1.90
2"	61585	1.90
3"	61584	2.75
4"	61584	2.75



Safety Clips

Used on sizes	304 Stainless Steel	
	Part #	Price/E
1 1/4"	63545	\$1.10
1 1/2"	63545	1.10
2"	63545	1.10

