

NYLON SUCTION STRAINERS

SERIES AN-6235

- **ECONOMICAL**
- **DISPOSABLE**
- **ALL-NYLON CONSTRUCTION**
- **30 MESH-SIZE EQUIVALENT**
- **CORROSIVE RESISTANT**

These all-nylon suction strainers are ideal for use where stainless steel or other metal strainers might corrode or contaminate your fluid. Such applications include water/seawater/de-ionized water, medical/pharmaceutical, general industrial, chemical, and coolant/lubricant. They are available in nut or nipple sizes in flow rates to 3 GPM. The nut style is available in 5 pipe sizes, while the nipple is available in 3. Their unique construction, molded from nylon, offers the equivalent retention of 30 mesh woven wire.

That low-cost construction also makes them economical, easy-to-use, and disposable, saving you time and money.

HOW TO ORDER NYLON SUCTION STRAINERS

Select the desired specifications from the ordering table and build an ordering code number, as shown in this sample:

NYL - 3 - 1/2 - NUT - 30
STYLE - GPM - NPT - CONNECTION - MESH

STYLE	GPM	NPT (Pipe Size)	CONNECTION (Nut or Nipple)	MESH (Screen Size)
NYL	3	1/8	Nut	30
		1/4		
		3/8		
		1/2		
		3/4		
		3/8	Nipple	
	1/2			
	3/4			

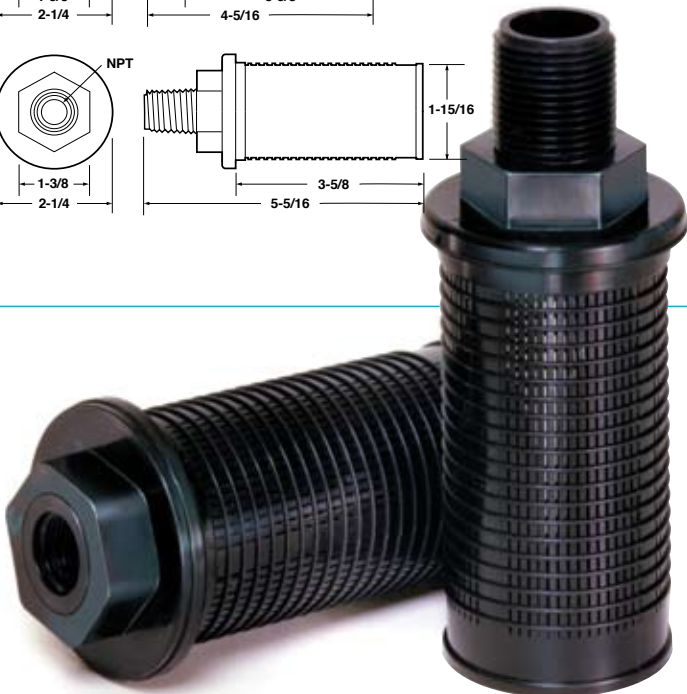
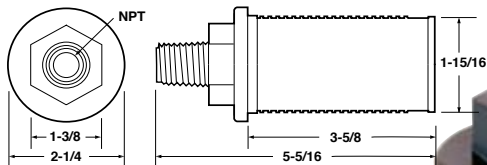
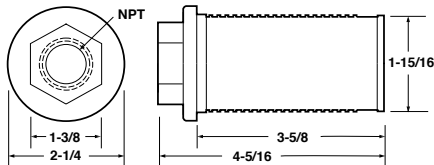

DISPOSABLE AND CLEANABLE LINE TYPE FILTER ELEMENTS

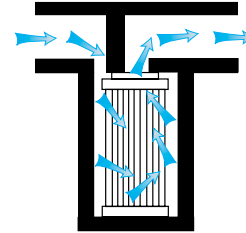

FLOW EZY PART NO.	OLD FLOW EZY PART NO.	A	B	C	O-RING NO.				
AN PART NO. AN-6235-1A									
AN-6235-1A-03G	9133-22	1-7/8	.391	53/64	2-012				
AN-6235-1A-10C	9133-11								
AN-6235-1A-25W	9133-05								
AN-6235-1A-40W	9133-04								
AN-6235-1A-74W	9133-02								
AN-6235-1A-149W	9133-01								
AN-6235-1A-238W	9133								
AN-6235-1A-590W	9133-30M								
AN PART NO. AN-6235-2A									
AN-6235-2A-03G						4-5/8	.641	1-1/8	2-114
10C									
25W									
40W									
74W									
149W									
238W									
590W									
AN PART NO. AN-6235-3A									
AN-6235-3A-03G	6836-03G	3-7/16	.890	1-5/8	2-212				
10C	6836-10C								
10W	6836-10W								
25W	6836-25W								
40W	6836-40W								
74W	6836-74W								
149W	6836-149W								
238W	6836-238W								
590W	6836-590W								
AN PART NO. AN-6235-4A									
AN-6235-4A-03G	6927-03G	4-7/16	1.015	1-3/4	2-214				
10C	6927-10C								
05W	6928-05W								
10W	6928-10W								
25W	6928-25W								
40W	6928-40W								
74W	6928-74W								
149W	6928-149W								
238W	6928-238W								
590W	6928-30 MESH								

