

6 cm² Nominal Diameter Hydraulic Load Cell

1000 SERIES



- Compact flat body design for compression force measurement
- Ranges from 150 lb_f to 7,000 lb_f
- Accuracy levels range from ±0.125% full scale (BFSL) to ±1.5% full scale, depending on the measuring instrument
- Durable stainless steel housing and piston provide exceptional corrosion resistance and durability
- A high quality NOSHOK 300 Series pressure gauge or 100, 200 or 615 Series transducer is directly mounted to the load cell for precise measurement indication
- Operates without an external power supply when using a pressure gauge for indication
- Provides an extremely high degree of accuracy because the load cell is vacuum filled and sealed, eliminating the error that can be caused by entrapped air
- Steel jacketed flexible tubing and capillary systems are offered to accommodate applications that require remote mounting of the gauge or transducer
- An optional liquid filled gauge dampens the effects of pulsation, vibration and shock, and lubricates the gauge internals for extended service life
- Various output signals available in transducer models that are CE compliant

APPLICATIONS

- Spot welding
- Control the forces of the stamp on printing machines
- Control the forces between rollers on printing equipment
- Measure and control the forces between welding tongs on spot welding machines
- Control systems
- Robotic equipment
- Production lines
- Testing equipment

SPECIFICATIONS

Nominal diameter	ND 6
Load cell housing	Stainless steel
Piston	6 cm ² Stainless steel Optional plastic for welding brackets
Max piston stroke	0.02" (0.5 mm)
Connecting type	Connecting spacer, 50 mm - standard Connecting spacer, 100 mm - optional Flexible tubing with spiral steel jacket - optional (Max. length 1 m)
Gauge fill fluid	Glycerine Others available upon request
Load cell fill	Silicone
Operating temperature	14 °F to 122 °F (-10 °C to 50 °C)
Ambient temperature	-4 °F to 140 °F (-20 °C to 60 °C)

ORDERING INFORMATION			
LOAD CELLS	106P ND 6 - Compression - plastic piston	106S ND 6 - Compression - stainless steel piston	
MEASURING RANGES	150A 150 lb _f	900A 900 lb _f	4800A 4,800 lb _f
	400A 400 lb _f	1400A 1,400 lb _f	7000A 7,000 lb _f
	750A 750 lb _f	2800A 2,800 lb _f	
	Other ranges available, please consult factory.		
INSTRUMENTS	1 25-300 Series gauge	7 200 Series transducer	
	6 100 Series transmitter	8 615 Series transducer	
INSTRUMENT ORIENTATIONS	A Bottom connection	C Right side connection	
	B Top connection	D Left side connection	
25-300 SERIES GAUGE OPTIONS	100 SERIES TRANSMITTER OPTIONS	200 SERIES TRANSDUCER OPTIONS	615 SERIES TRANSDUCER OPTIONS
0 No options	Accuracy	Accuracy	Accuracy
1 Dry gauge	1 0.50%	1 0.50%	1 0.25%
2 Maximum indicating pointer	2 0.25%	2 0.25%	2 0.125%
3 Set pointer	Output	Output	Output
4 Rubber case protector	1 4 mA to 20 mA	2 0 Vdc to 5 Vdc	1 4 mA to 20 mA
5 Glass overlay	Electrical Connection	3 1 Vdc to 5 Vdc	2 0 Vdc to 5 Vdc
6 Safety glass overlay	1 Option 7 with 36" cable	5 0 Vdc to 10 Vdc	3 1 Vdc to 5 Vdc
	3 6-pin Bendix	Electrical Connection	5 0 Vdc to 10 Vdc
	6 1/2" NPT conduit w/ 6" cable	1 Option 7 with 36" cable	Electrical Connection
	7 Mini-Hirschmann	3 6-pin Bendix	1 Option 8 with 36" cable
	25 M12 x 1 (4-pin)	6 1/2" NPT conduit w/36" cable	3 6-pin Bendix
		7 Mini-Hirschmann	6 1/2" NPT conduit w/ 36" cable
		25 M12 x 1 (4-pin)	8 Hirschmann
			25 M12 x 1 (4-pin)
CONNECTING TYPES	1 50 mm SS spacer	3 Capillary w/ spiral protective sleeve	
	2 100 mm SS spacer		
CAPILLARY LENGTH	## Specify in feet (for options 3 and 4)		

Please consult your local NOSHOK Distributor or NOSHOK, Inc. for availability and delivery information.

Note: Separate multiple options with forward slash "/"

EXAMPLE - With Pressure Gauge

Load cell..... 1000 Series ND 6
 Measuring range..... 2,800 lb_f
 Instrument..... 25-300 Series gauge
 Instrument orientation..... Bottom connection
 Options..... Dry gauge, set pointer, RCP
 Connecting type..... 50 mm stainless steel spacer

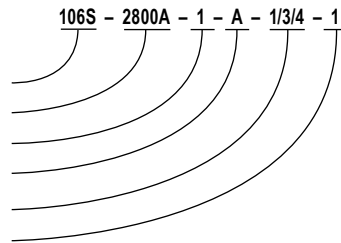

EXAMPLE - With Pressure Transducer

Load cell..... 1000 Series ND 6
 Measuring range..... 7,000 lb_f
 Instrument..... 615 Series transducer
 Instrument orientation..... Bottom connection
 Options..... 0.25% accuracy, 0 Vdc to 5 Vdc, M12 x 1 (4-pin)
 Connecting type..... Capillary w/ spiral protective sleeve
 Capillary length..... 5'

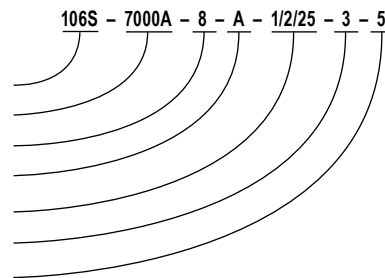

Dimensions

With 25-300 Series Pressure Gauge

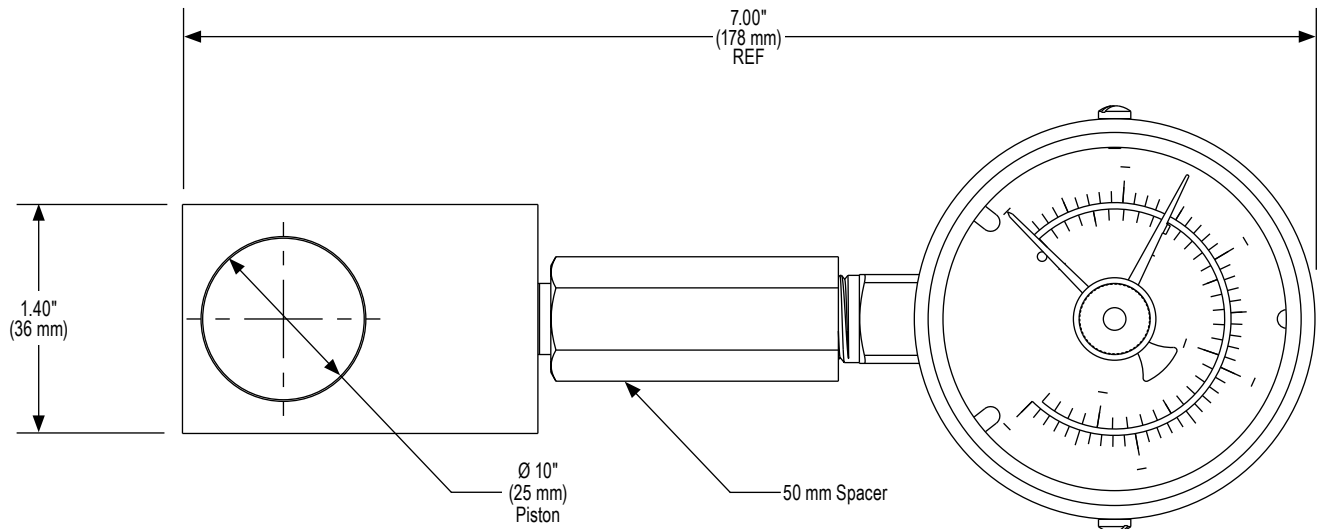
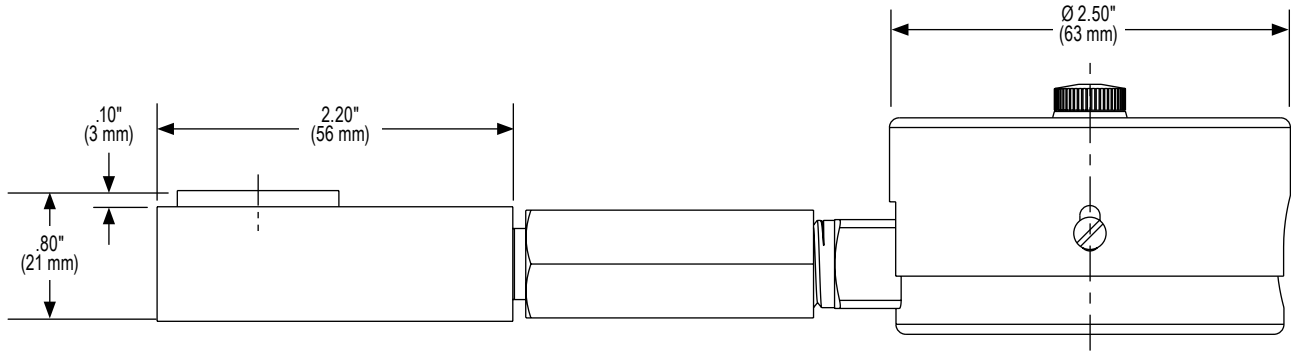

With 100/200 Series Transducer

