

Load Pin



5301/5308 SERIES

- Utilizes proven thin film sensor technology laser welded directly to the measuring instrument to provide accuracies up to $\pm 0.5\%$
- Minimizes the disadvantages seen in the bonded foil versions (temperature drifts and long term stability)
- Measuring ranges from 0 kN to 5 kN through 0 kN to 200 kN
- Available in a variety of sizes and shapes for direct replacement of existing bolts
- Various output signals are available to integrate with almost any electrical system

APPLICATIONS

- Shear force measurement
- Force measurement on roller bearings
- Industrial weighing
- Measurement of cable tension on hoists and overload protection on cranes

SPECIFICATIONS

Output signals	1-2 mV/V (4-wire), 4 mA to 20 mA (2-wire), 0 Vdc to 10 Vdc (3-wire), CANopen®, PROFIBUS®, others available on request
Measuring ranges	0 kN to 5 kN through 0 kN to 200 kN
Accuracy	$\pm 2.0\%$ full scale to $\pm 0.5\%$ full scale
Housing material	316 stainless steel
Environmental protection	NEMA 4X, IP67 per EN 60529/IEC 529
Operating temperature	-40 °F to 176 °F (-40 °C to 80 °C)
Electrical protection	Reverse polarity, overvoltage and short circuit protection
Nominal deflection	<0.002" (<0.05 mm)
Weight	5 kN: 0.51 lb (230 g) 10 kN: 0.66 lb (300 g) 20 kN: 0.95 lb (430 g) 30 kN: 1.39 lb (630 g) 50 kN: 2.09 lb (950 g)

CANopen® is a registered trademark of the CAN in Automation User's Group.
Profibus® is a registered trademark of Profibus International.

ORDERING INFORMATION				
SERIES	5301 Standard	5308 Custom		
MEASURING RANGES	5K	0 kN to 5 kN	20K	0 kN to 20 kN
	10K	0 kN to 10 kN	30K	0 kN to 30 kN
ACCURACIES	1	±2.0% full scale	2	±1.0% full scale
OUTPUT SIGNALS	1	4 mA to 20 mA	5	0 Vdc to 10 Vdc
ELECTRICAL CONNECTION	25	M12 x 1 (4-pin)		

Please consult your local NOSHOK Distributor or NOSHOK, Inc. for availability and delivery information.

* For 5308 only.

EXAMPLE

Series 5301 Series
 Measuring range 0 kN to 100 kN
 Accuracy ±1.0% full scale
 Output signal 0 Vdc to 10 Vdc
 Electrical connection M12 x 1 (4-pin)

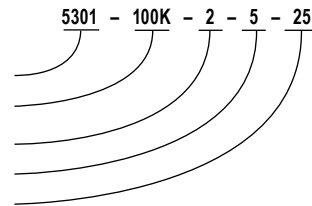

5301 Series

5301 Series - 5 kN

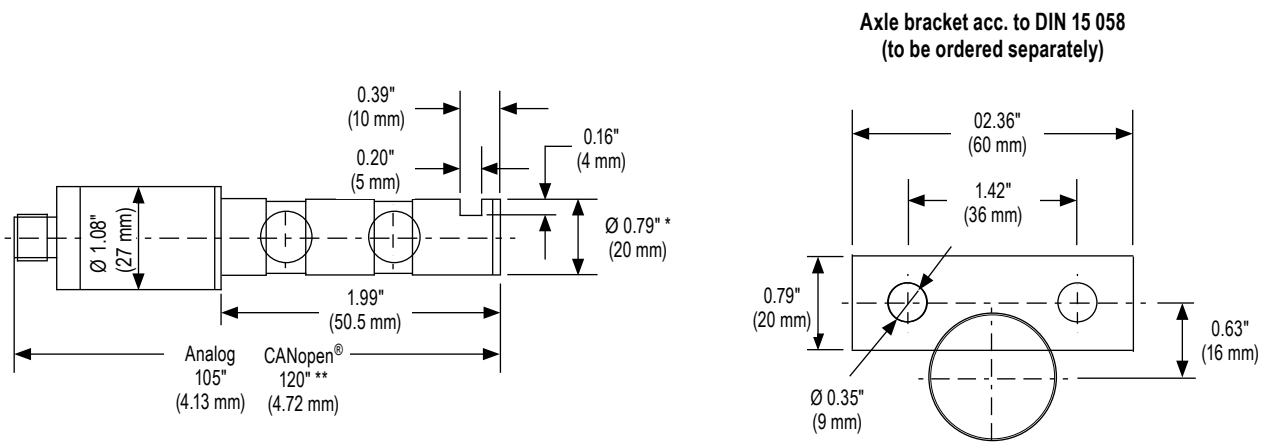

* Other load pin-Ø available
 ** Case diameter 1-37/64" (40 mm)

Dimensions

5301 Series - 10 kN

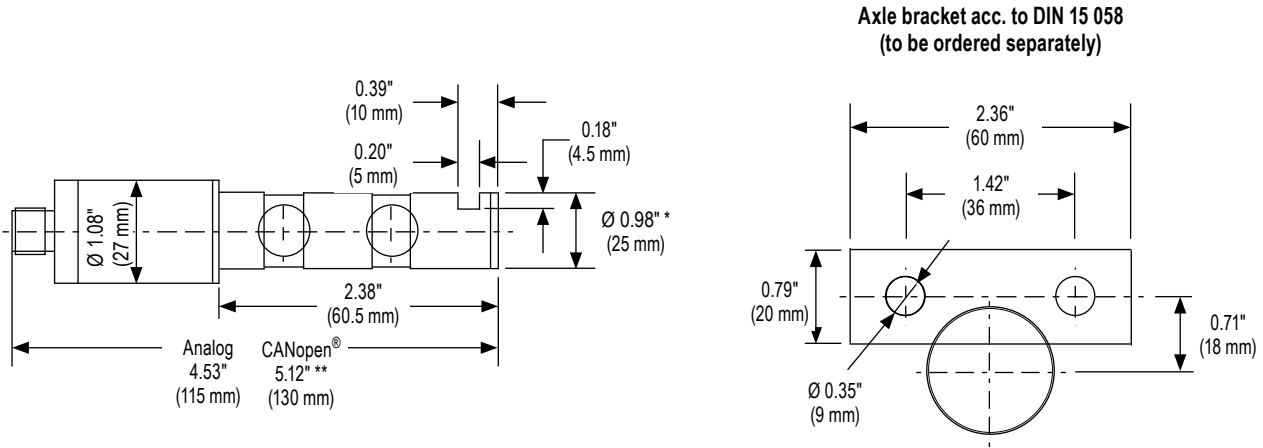

* Other load pin-Ø available
 ** Case diameter 1-37/64" (40 mm)

5308 Series - 20 kN

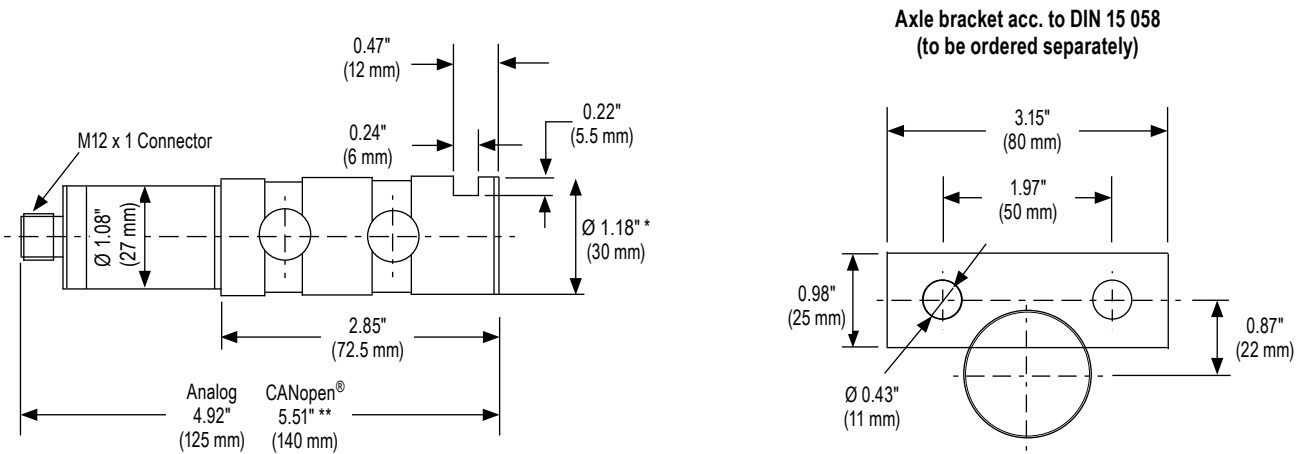

* Other load pin-Ø available
 ** Case diameter 1-37/64" (40 mm)

5308 Series - 30 kN

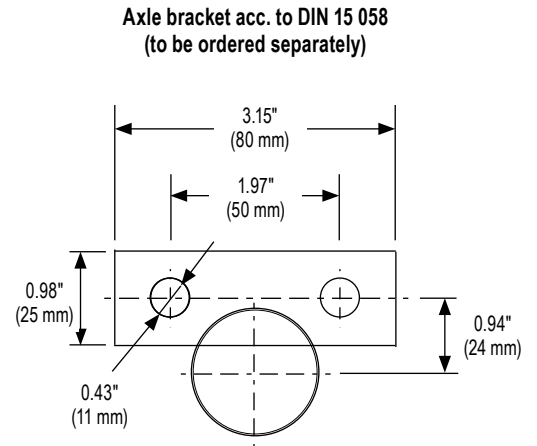
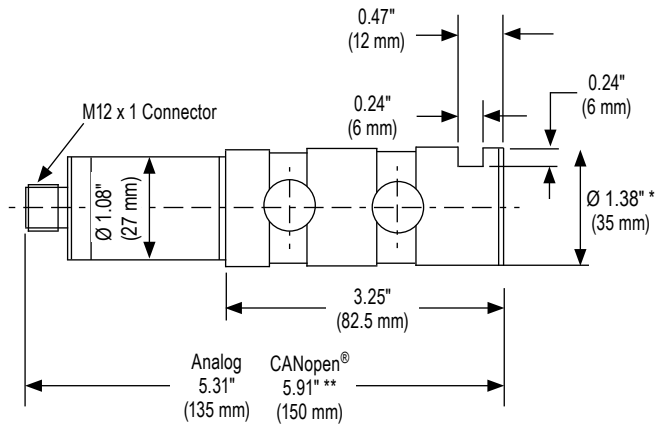

* Other load pin- Ø available
 ** Case diameter 1-37/64" (40 mm)

5308 Series - 50 kN

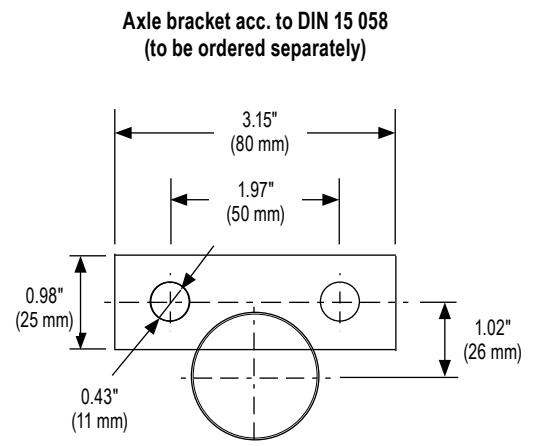
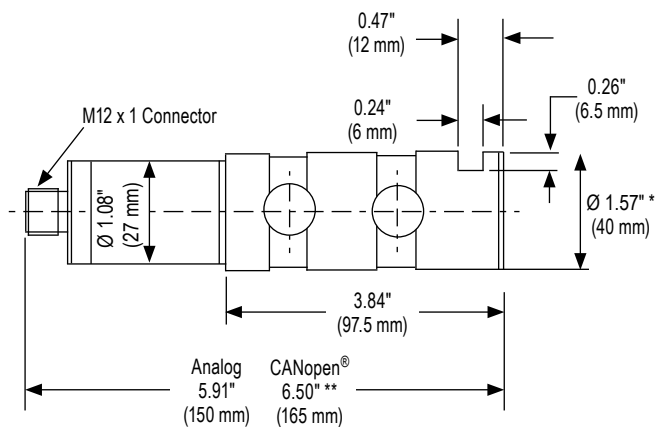

* Other load pin- Ø available
 ** Case diameter 1-37/64" (40 mm)