

Hydraulic Pump Division

TECH BRIEFS

April 2009

New Harsh Environment Design for PAVC100 Piston Pumps

PAVC100
Salt and Sand
Trucks

The PAVC Series Piston Pumps have been used successfully in Salt and Sand Truck installations for many years.

A popular pump design option for these applications is the Harsh Environment Seal. This outboard seal protects the shaft bearing from road grit and grime, providing the reliability needed to keep those trucks on the job clearing our highways. We are making a product improvement change to make this feature even more robust and eliminating some low volume variations of this special design.

Below is a picture of the new design.

Shaft Kits Contain the Parts below.

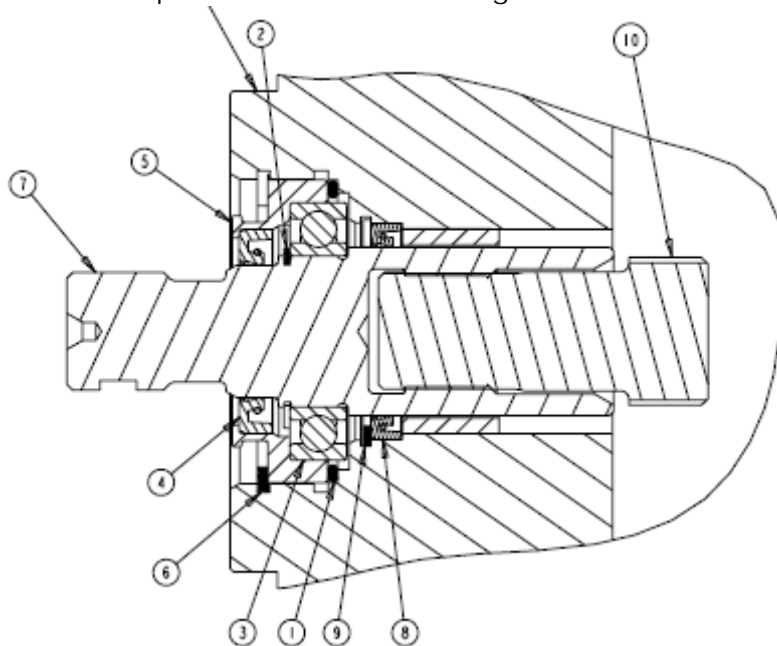

- | | |
|------------------|------------|
| 1) O-Ring | |
| 2) Snap ring | |
| 3) Ball Bearing | |
| 4) Shaft Seal | |
| 5) Bearing Gland | (New Part) |
| 6) Snap Ring | |
| 7) Shaft | (New Part) |
| 8) Shaft Seal | (New Part) |
| 9) Snap Ring | |
| 10) Idler Shaft | (New Part) |

This change will not affect the existing complete pump model codes. You will be able to order the current codes (X numbers) you used in the past. There is a P-N change for service parts summarized below. There are no price changes and implementation is immediate. Please start ordering the new service part numbers on your next order.

Description	New Part Numbers	Obsolete Part Numbers
SAE C Spline HE Shaft Kit	789853	788593, 789353 & 789508
SAE C Keyed HE Shaft Kit	789852	788625 & 789506
HE Seal Kit	789507	789118

When servicing the old style PAVC100 HE pumps, the complete shaft kit must be ordered. New shafts will not be sold as individual parts since they will not be compatible with the old HE design parts.