

SIGHT GAGES - CLOSED CIRCUIT

G601 SERIES

The G601 Series front mount closed circuit sight gages provide front viewing of the fluid level through a clear glass sight all secured within an aluminum body. Functionally equivalent to the G605 Series sight gages, but miniaturized with smaller mounting studs, a lower profile and a smaller width viewing window.

Standard Features:

- Front mount
- Fluid level visible from the front of gage (.31 inches wide)
- Clear borosilicate sight glass
- Suitable for use with most hydraulic and machine lubricating oils

Standard Materials:

- Aluminum construction
- Buna N seals
- Borosilicate glass sight
- Zinc plated, steel hex nuts

Temperature and Pressure Ratings:

- Maximum working pressure up to 200 PSI (1379 kPa) at 150°F (65°C), no corrosion
- Please refer to Temperature Ratings by Seal Material for additional operating conditions (Appendix RA-5 on page RA-A5)

NOTE:

- Please refer to Appendix RA-6 on page RA-A6 for installation instructions

CAUTION: • Not recommended for use with water, steam, acidic fluids, caustic fluids and volatile fluids
• If aluminum construction is selected for a water application, anodizing is recommended

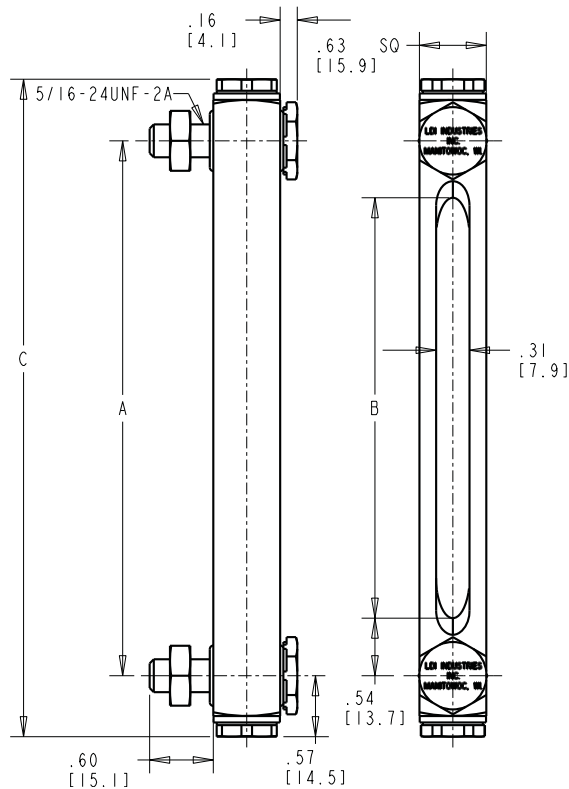

NOTE: All dimensions are inches [mm]

G601 Series			
Part No.	A inches (mm)	B inches (mm)	C inches (mm)
G601-03-A-1	3.00 (76.20)	1.93 (49.02)	4.15 (105.41)
G601-05-A-1	5.00 (127.00)	3.93 (99.82)	6.15 (156.21)



ORDERING OPTIONS CODES:

BODY MATERIAL

- A- Aluminum gage body (standard)
- B- Brass gage body (optional)

SEAL MATERIAL

- 1- Buna N seals (standard)
- 2- Butyl seals (optional)
- 3- Viton® seals (optional)
- 4- Ethylene propylene seals (optional)

HOW TO ORDER

EXAMPLE:

G601-05-A-1 — Buna N Seals
Aluminum body
5.00 (127.00 mm) mounting centers
Series G601

Dimensions and specifications are subject to change without notice. Not all items are Made-To-Stock, contact us for availability.

02/14

Ph : 920-682-6877
Fx : 920-684-7210



sales@ldi-industries.com
www.ldi-industries.com

SIGHT GAGES - CLOSED CIRCUIT

G603 SERIES

The G603 Series front mount closed circuit sight gage is mounted securely with end blocks made from aluminum. These end blocks are connected with a clear, flexible tubular vinyl sight providing 360° viewing of the fluid level. The flexible vinyl sight bends easily to conform to irregular or cylindrical shaped reservoir bodies.

Standard Features:

- Front mount
- 360° of viewing fluid level
- Suitable for use with most hydraulic and machine lubricating oils

Standard Materials:

- Aluminum end blocks and mounting bolts
- Vinyl tubular sight
- Buna N seals

Temperature and Pressure Ratings:

- 150°F (65°C) maximum operating temperature
- 5 psi (35 kPa) maximum operating pressure
- Please refer to Temperature Ratings by Seal Material for additional operating conditions (Appendix RA-5 on page RA-A5)

NOTE:

- Please refer to Appendix RA-11 on page RA-A11 for installation instructions

CAUTION: • Not recommended for use with water, steam, acidic fluids, caustic fluids and volatile fluids

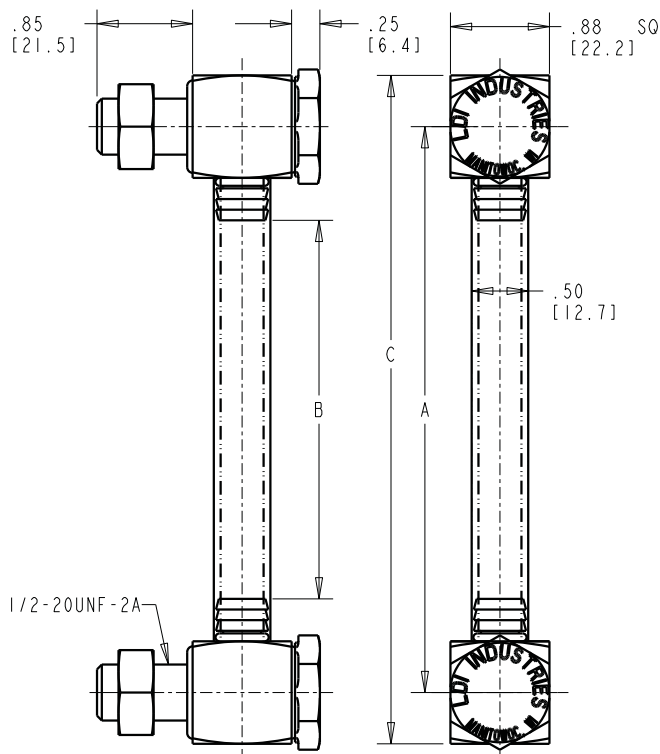

G603 Series		
A inches (mm)	B inches (mm)	C inches (mm)
3.00 (76.20)	1.34 (34.04)	3.91 (9.93)
4.00 (101.60)	2.34 (59.44)	4.91 (124.71)
5.00 (127.00)	3.34 (84.84)	5.91 (150.11)
6.00 (152.40)	4.34 (110.24)	6.91 (175.51)
7.00 (177.80)	5.34 (135.64)	7.91 (200.91)
8.00 (203.20)	6.34 (161.04)	8.91 (226.31)
9.00 (228.60)	7.34 (186.44)	9.91 (251.71)
10.00 (254.00)	8.34 (211.84)	10.91 (277.11)
11.00 (279.40)	9.34 (237.24)	11.91 (302.51)
12.00 (304.80)	10.34 (262.64)	12.91 (327.91)



NOTE: All dimensions are inches [mm]

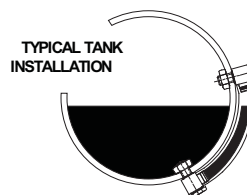

ORDERING OPTIONS CODES:

BODY MATERIAL

- A- Aluminum end blocks (standard)
- B- Brass end blocks (optional)

SEAL MATERIAL

- 1- Buna N seals (standard)
- 2- Butyl seals (optional)
- 3- Viton® seals (optional)
- 4- Ethylene propylene seals (optional)

HOW TO ORDER

EXAMPLE:

G603-05-A-1 — Buna N Seals
 Aluminum end blocks
 5.00 (127.00 mm) mounting centers
 Series G603

Dimensions and specifications are subject to change without notice. Not all items are Made-To-Stock, contact us for availability.

02/14

Ph : 920-682-6877
 Fx : 920-684-7210

LDI Industries

sales@ldi-industries.com
 www.ldi-industries.com

SIGHT GAGES - CLOSED CIRCUIT

GA603 SERIES

The GA603 Series front mount closed circuit sight gage is mounted securely with end blocks made from aluminum. These end blocks are connected with a clear, flexible tubular vinyl sight providing 360° viewing of the fluid level. The flexible vinyl sight bends easily to conform to irregular or cylindrical shaped reservoir bodies. Pipe adapters are provided with the gage for mounting directly to NPT couplings.

Standard Features:

- Front mount
- 360° of viewing fluid level
- Suitable for use with most hydraulic and machine lubricating oils

Standard Materials:

- Aluminum end blocks and mounting bolts
- Brass pipe adapters
- Vinyl tubular sight
- Buna N seals

Temperature and Pressure Ratings:

- 150°F (65°C) maximum operating temperature
- 5 psi (35 kPa) maximum operating pressure
- Please refer to Temperature Ratings by Seal Material for additional operating conditions (Appendix RA-5 on page RA-A5)

NOTES:

- Access to inside of reservoir is required to mount this style sight gage
- Please refer to Appendix RA-7 on page RA-A7 for installation instructions

CAUTION: • Not recommended for use with water, steam, acidic fluids, caustic fluids and volatile fluids

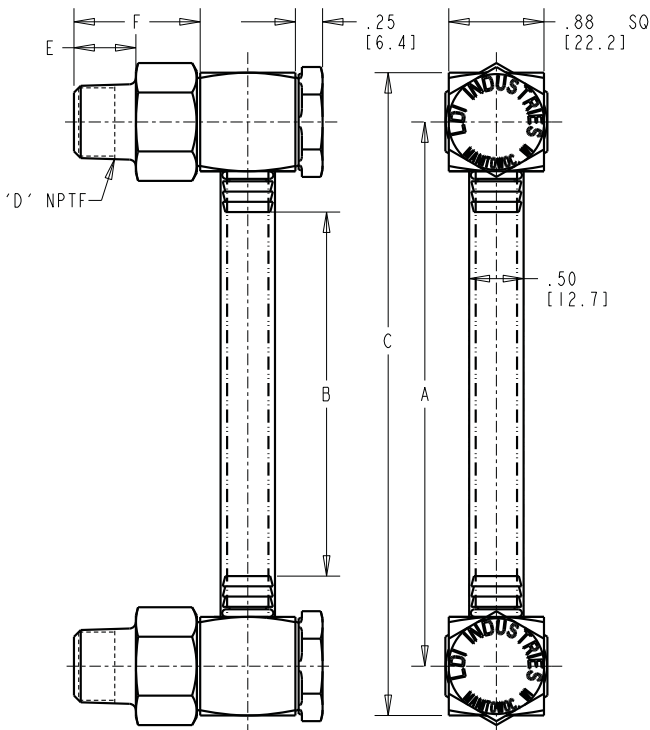

GA603 Series		
A	B	C
inches (mm)	inches (mm)	inches (mm)
3.00 (76.20)	1.34 (34.04)	3.91 (9.93)
4.00 (101.60)	2.34 (59.44)	4.91 (124.71)
5.00 (127.00)	3.34 (84.84)	5.91 (150.11)
6.00 (152.40)	4.34 (110.24)	6.91 (175.51)
7.00 (177.80)	5.34 (135.64)	7.91 (200.91)
8.00 (203.20)	6.34 (161.04)	8.91 (226.31)
9.00 (228.60)	7.34 (186.44)	9.91 (251.71)
10.00 (254.00)	8.34 (211.84)	10.91 (277.11)
11.00 (279.40)	9.34 (237.24)	11.91 (302.51)
12.00 (304.80)	10.34 (262.64)	12.91 (327.91)

Pipe Adapter		
D	E	F
NPTF	inches (mm)	inches (mm)
1/4-18	.57 (14.48)	1.22 (30.99)
3/8-18	.57 (14.48)	1.16 (29.46)
1/2-14	.76 (19.30)	1.16 (29.46)
3/4-14	.76 (19.30)	1.16 (29.46)

NOTE: All dimensions are inches [mm]

ORDERING OPTIONS CODES:

BODY MATERIAL

- A- Aluminum end blocks (standard)
- B- Brass end blocks (optional)

SEAL MATERIAL

- 1- Buna N seals (standard)
- 2- Butyl seals (optional)
- 3- Viton® seals (optional)
- 4- Ethylene propylene seals (optional)

PIPE SIZE

- 2- 1/4-18 male pipe thread
- 3- 3/8-18 male pipe thread
- 4- 1/2-14 male pipe thread
- 5- 3/4-14 male pipe thread

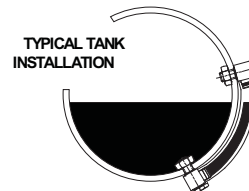

HOW TO ORDER

EXAMPLE:

GA603-05-A-1-3 — 3/8 inch NPTF
 Buna N Seals
 Aluminum end blocks
 5.00 (127.00 mm) mounting centers
 Series GA603



Dimensions and specifications are subject to change without notice. Not all items are Made-To-Stock, contact us for availability.

02/14

Ph : 920-682-6877
 Fx : 920-684-7210

LDI Industries

sales@ldi-industries.com
 www.ldi-industries.com

SIGHT GAGES - CLOSED CIRCUIT

GAT603 SERIES

The GAT603 Series front mount closed circuit sight gage is mounted securely with end blocks made from aluminum. These end blocks are connected with a clear, flexible tubular vinyl sight providing 360° viewing of the fluid level. The flexible vinyl sight bends easily to conform to irregular or cylindrical shaped reservoir bodies. A wetted dial thermometer provides direct reading of the fluid temperature and pipe adapters are provided with the gage for mounting directly to NPT couplings.

Standard Features:

- Front mount
- 360° of viewing fluid level
- 1.38 inch diameter dual scale dial thermometer, 50° to 300°F and 10° to 150°C
- Suitable for use with most hydraulic and machine lubricating oils

Standard Materials:

- Aluminum end blocks and mounting bolts
- Brass pipe adapters
- Vinyl tubular sight
- Buna N seals

Temperature and Pressure Ratings:

- 150°F (65°C) maximum operating temperature
- 5 psi (35 kPa) maximum operating pressure
- Please refer to Temperature Ratings by Seal Material for additional operating conditions (Appendix RA-5 on page RA-A5)

NOTE:

- Please refer to Appendix RA-7 on page RA-A7 for installation instructions

CAUTION: • Not recommended for use with water, steam, acidic fluids, caustic fluids and volatile fluids
• Reservoir must be drained to remove dial thermometer or loss of fluid will occur

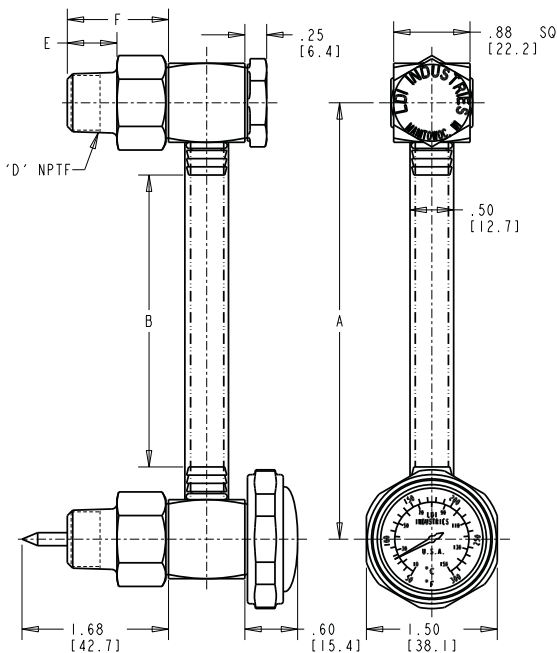

NOTE: All dimensions are inches [mm]

GAT603 Series			Pipe Adapter		
A inches (mm)	B inches (mm)	C inches (mm)	D NPTF	E inches (mm)	F inches (mm)
3.00 (76.20)	1.34 (34.04)	3.91 (9.93)	1/4-18	.57 (14.48)	1.22 (30.99)
4.00 (101.60)	2.34 (59.44)	4.91 (124.71)	3/8-18	.57 (14.48)	1.16 (29.46)
5.00 (127.00)	3.34 (84.84)	5.91 (150.11)	1/2-14	.76 (19.30)	1.16 (29.46)
6.00 (152.40)	4.34 (110.24)	6.91 (175.51)	3/4-14	.76 (19.30)	1.16 (29.46)
7.00 (177.80)	5.34 (135.64)	7.91 (200.91)			
8.00 (203.20)	6.34 (161.04)	8.91 (226.31)			
9.00 (228.60)	7.34 (186.44)	9.91 (251.71)			
10.00 (254.00)	8.34 (211.84)	10.91 (277.11)			
11.00 (279.40)	9.34 (237.24)	11.91 (302.51)			
12.00 (304.80)	10.34 (262.64)	12.91 (327.91)			



ORDERING OPTIONS CODES:

BODY MATERIAL

- A- Aluminum end blocks (standard)
- B- Brass end blocks (optional)

SEAL MATERIAL

- 1- Buna N seals (standard)
- 2- Butyl seals (optional)
- 3- Viton® seals (optional)
- 4- Ethylene propylene seals (optional)

PIPE SIZE - GA603, GAT603 ONLY

- 2- 1/4-18 male pipe thread
- 3- 3/8-18 male pipe thread
- 4- 1/2-14 male pipe thread
- 5- 3/4-14 male pipe thread

TYPICAL TANK INSTALLATION



HOW TO ORDER

EXAMPLE:

GAT603-11-A-1-3 — 3/8 inch NPTF
Buna N Seals
Aluminum end blocks
11.00 (279.40 mm) mounting centers
Series GAT603

Dimensions and specifications are subject to change without notice. Not all items are Made-To-Stock, contact us for availability.

02/14

Ph : 920-682-6877
Fx : 920-684-7210

LDI Industries

sales@ldi-industries.com
www.ldi-industries.com

SIGHT GAGES - CLOSED CIRCUIT

GT603 SERIES

The GT603 Series front mount closed circuit sight gage is mounted securely with end blocks made from aluminum. These end blocks are connected with a clear, flexible tubular vinyl sight providing 360° viewing of the fluid level. A wetted dial thermometer provides direct reading of the fluid temperature.

Standard Features:

- Front mount
- 360° of viewing fluid level
- 1.38" diameter dual scale dial thermometer, 50° to 300°F and 10° to 150°C
- Suitable for use with most hydraulic and machine lubricating oils

Standard Materials:

- Aluminum end blocks and mounting bolts
- Vinyl tubular sight
- Buna N seals

Temperature and Pressure Ratings:

- 150°F (65°C) maximum operating temperature
- 5 psi (35 kPa) maximum operating pressure
- Please refer to Temperature Ratings by Seal Material for additional operating conditions (Appendix RA-5 on page RA-A5)

NOTE:

- Please refer to Appendix RA-11 on page RA-A11 for installation instructions

CAUTION: • Not recommended for use with water, steam, acidic fluids, caustic fluids and volatile fluids
• Reservoir must be drained to remove dial thermometer or loss of fluid will occur

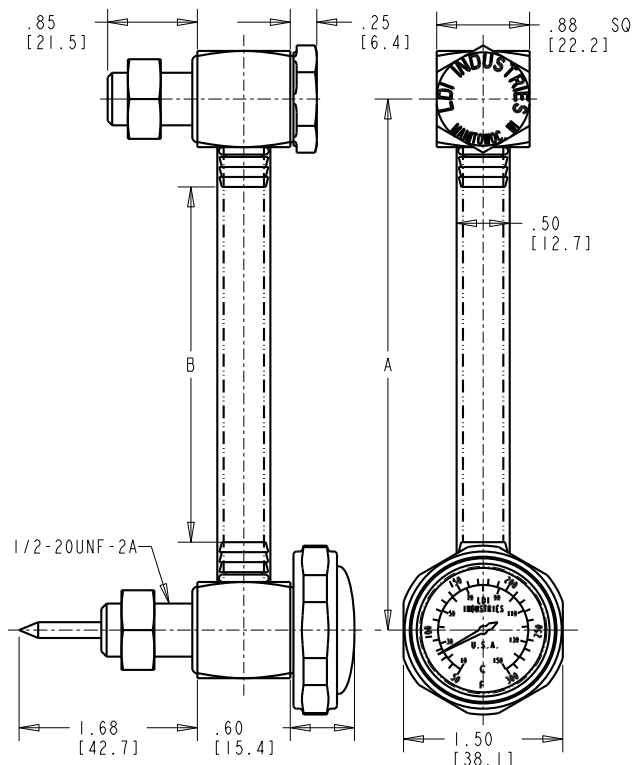

NOTE: All dimensions are inches [mm]

GT603 Series		
A	B	C
inches (mm)	inches (mm)	inches (mm)
3.00 (76.20)	1.34 (34.04)	3.91 (9.93)
4.00 (101.60)	2.34 (59.44)	4.91 (124.71)
5.00 (127.00)	3.34 (84.84)	5.91 (150.11)
6.00 (152.40)	4.34 (110.24)	6.91 (175.51)
7.00 (177.80)	5.34 (135.64)	7.91 (200.91)
8.00 (203.20)	6.34 (161.04)	8.91 (226.31)
9.00 (228.60)	7.34 (186.44)	9.91 (251.71)
10.00 (254.00)	8.34 (211.84)	10.91 (277.11)
11.00 (279.40)	9.34 (237.24)	11.91 (302.51)
12.00 (304.80)	10.34 (262.64)	12.91 (327.91)

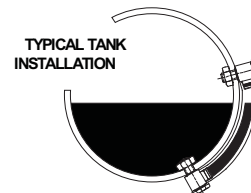

ORDERING OPTIONS CODES:

BODY MATERIAL

- A- Aluminum end blocks (standard)
- B- Brass end blocks (optional)

SEAL MATERIAL

- 1- Buna N seals (standard)
- 2- Butyl seals (optional)
- 3- Viton® seals (optional)
- 4- Ethylene propylene seals (optional)

HOW TO ORDER

EXAMPLE:

GT603-08-A-1 — Buna N Seals
Aluminum end blocks
8.00 (203.20 mm) mounting centers
Series GT603

Dimensions and specifications are subject to change without notice. Not all items are Made-To-Stock, contact us for availability.

02/14

Ph : 920-682-6877
Fx : 920-684-7210

LDI Industries

sales@ldi-industries.com
www.ldi-industries.com

SIGHT GAGES - CLOSED CIRCUIT

G605 SERIES

The G605 Series front mount closed circuit sight gages provide front viewing of the fluid level clearly delineated by a redline on white background integral to the glass sight all secured within an aluminum body. HIGH-LOW markings are stamped into the aluminum body.

Standard Features:

- Front mount
- Fluid level visible from front of gage (.50 inches wide)
- Viewing enhanced by redline on white background integral to sight glass
- Suitable for use with most hydraulic and machine lubricating oils

Standard Materials:

- Aluminum gage body and mounting bolts
- Buna N seals
- Borosilicate glass sight
- Zinc plated, steel locknuts

Temperature and Pressure Ratings:

- Please refer to Appendix RA-1 on page RA-A1 for Sight Opening & Pressure Rating information
- Please refer to Temperature Ratings by Seal Material for additional operating conditions (Appendix RA-5 on page RA-A5)

NOTE:

- Please refer to Appendix RA-2 on page RA-A2 for installation instructions

CAUTION: • Not recommended for use with water, steam, acidic fluids, caustic fluids and volatile fluids
• If aluminum construction is selected for a water application, anodizing is recommended

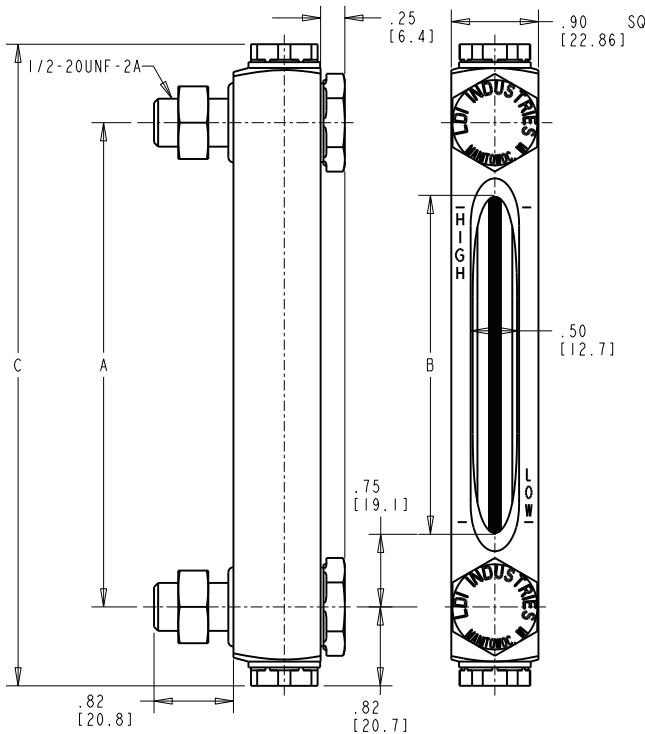

NOTE: All dimensions are inches [mm]

G605 Series		
A	B	C
inches	inches	inches
(mm)	(mm)	(mm)
3.00	1.50	4.62
(76.20)	(38.10)	(117.35)
4.00	2.50	5.62
(101.60)	(63.50)	(142.75)
5.00	3.50	6.62
(127.00)	(88.90)	(168.15)
6.00	4.50	7.62
(152.40)	(114.30)	(193.55)
7.00	5.50	8.62
(177.80)	(139.70)	(218.95)
8.00	6.50	9.62
(203.20)	(165.10)	(244.35)
9.00	7.50	10.62
(228.60)	(190.50)	(269.75)
10.00	8.50	11.62
(254.00)	(215.90)	(295.15)
11.00	9.50	12.62
(279.40)	(241.30)	(320.55)
12.00	10.50	13.62
(304.80)	(266.70)	(345.95)



NOTE: The sight opening in all cases is 1.50 inches (38.10mm) less than mounting centers and overall length is 1.62 inches (41.15mm) greater than mounting centers. Gages with 13.00 inch (330.20mm) and greater mounting centers are furnished with spacer sleeves to space gage from tank allowing for bowing of the tank wall in larger reservoirs. Center mounting kits are furnished with gages 48.00 inches (1219.20mm) and greater mounting centers.

ORDERING OPTIONS CODES:

BODY MATERIAL

- A- Aluminum gage body (standard)
- B- Brass gage body (optional)
- S- Steel gage body (optional)
- Y- Stainless Steel gage body (optional)

SEAL MATERIAL

- 1- Buna N seals (standard)
- 2- Butyl seals (optional)
- 3- Viton® seals (optional)
- 4- Ethylene propylene seals (optional)
- 10- Neoprene seals (optional)

HOW TO ORDER

EXAMPLE:

G605-05-A-1 — Buna N Seals
Aluminum gage body
5.00 (127.00 mm) mounting centers
Series G605

Dimensions and specifications are subject to change without notice. Not all items are Made-To-Stock, contact us for availability.

02/14

Ph : 920-682-6877
Fx : 920-684-7210



sales@ldi-industries.com
www.ldi-industries.com

SIGHT GAGES - CLOSED CIRCUIT

G607 SERIES

The G607 Series front mount closed circuit sight gages provide front viewing of the fluid level clearly delineated by a redline on white background integral to the glass sight all secured within an aluminum body (HIGH-LOW markings). Brass pipe adapters are provided with the sight gages for direct assembly of the sight gage to NPT couplings.

Standard Features:

- Front mount
- Fluid level visible from front of gage (.50 inches wide)
- Viewing enhanced by redline on white background integral to sight glass
- Suitable for use with most hydraulic and machine lubricating oils

Standard Materials:

- Aluminum gage body and mounting bolts
- Brass pipe adapters
- Buna N seals
- Borosilicate glass sight

Temperature and Pressure Ratings:

- Please refer to Appendix RA-1 on page RA-A1 for Sight Opening & Pressure Rating information
- Please refer to Temperature Ratings by Seal Material for additional operating conditions (Appendix RA-5 on page RA-A5)

NOTE:

- Please refer to Appendix RA-7 on page RA-A7 for installation instructions

CAUTION: • Not recommended for use with water, steam, acidic fluids, caustic fluids and volatile fluids

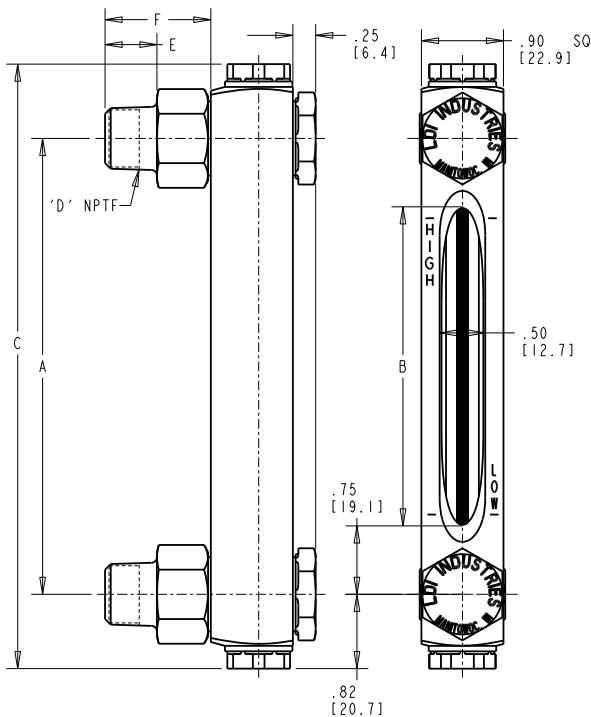

G607 Series			Pipe Adapter		
A inches (mm)	B inches (mm)	C inches (mm)	D NPTF	E inches (mm)	F inches (mm)
3.00 (76.20)	1.50 (38.10)	4.62 (117.35)	1/4-18	.57 (14.48)	1.22 (30.99)
4.00 (101.60)	2.50 (63.50)	5.62 (142.75)	3/8-18	.57 (14.48)	1.16 (29.46)
5.00 (127.00)	3.50 (88.90)	6.62 (168.15)	1/2-14	.76 (19.30)	1.16 (29.46)
6.00 (152.40)	4.50 (114.30)	7.62 (193.55)	3/4-14	.76 (19.30)	1.16 (29.46)
7.00 (177.80)	5.50 (139.70)	8.62 (218.95)			
8.00 (203.20)	6.50 (165.10)	9.62 (244.35)			
9.00 (228.60)	7.50 (190.50)	10.62 (269.75)			
10.00 (254.00)	8.50 (215.90)	11.62 (295.15)			
11.00 (279.40)	9.50 (241.30)	12.62 (320.55)			
12.00 (304.80)	10.50 (266.70)	13.62 (345.95)			



NOTE: All dimensions are inches [mm]

ORDERING OPTIONS CODES:

BODY MATERIAL

- A- Aluminum gage body (standard)
- B- Brass gage body (optional)
- S- Steel gage body (optional)
- Y- Stainless Steel gage body (optional)

SEAL MATERIAL

- 1- Buna N seals (standard)
- 2- Butyl seals (optional)
- 3- Viton® seals (optional)
- 4- Ethylene propylene seals (optional)
- 5- Silicone seals (optional)

SPECIFY PIPE THREAD SIZE:

- 2- 1/4 male pipe thread
- 3- 3/8 male pipe thread
- 4- 1/2 male pipe thread
- 5- 3/4 male pipe thread

HOW TO ORDER

EXAMPLE:

G607-06-A-1-4 — 1/2 inch pipe thread
 — Buna N Seals
 — Aluminum gage body
 — 6.00 (152.40 mm) mounting centers
 — Series G607

Dimensions and specifications are subject to change without notice. Not all items are Made-To-Stock, contact us for availability.

02/14

Ph : 920-682-6877
 Fx : 920-684-7210



sales@ldi-industries.com
 www.ldi-industries.com

SIGHT GAGES - CLOSED CIRCUIT

G608 SERIES

The G608 Series front mount closed circuit sight gages provide front viewing of the fluid level clearly delineated by a redline on white background integral to the glass sight all secured within an aluminum body (HIGH-LOW markings). Brass pipe adapters with integral needle valves are provided with the sight gages for direct assembly of the sight gage to NPT couplings. The needle valves allow a user to shut off flow to the sight gage allowing the sight gage to be removed from the reservoir with minimal loss of fluid

Standard Features:

- Front mount
- Fluid level visible from front of gage (.50 inches wide)
- Viewing enhanced by redline on white background integral to sight glass
- Suitable for use with most hydraulic and machine lubricating oils

Standard Materials:

- Aluminum gage body and mounting bolts
- Brass pipe adapters (with needle valves)
- Buna N seals
- Borosilicate glass sight

Temperature and Pressure Ratings:

- Maximum working pressure as noted in table below at 150°F (65°C), no corrosion
- Please refer to Temperature Ratings by Seal Material for additional operating conditions (Appendix RA-5 on page RA-A5)

NOTE:

- Please refer to Appendix RA-7 on page RA-A7 for installation instructions

CAUTION: • Not recommended for use with water, steam, acidic fluids, caustic fluids and volatile fluids

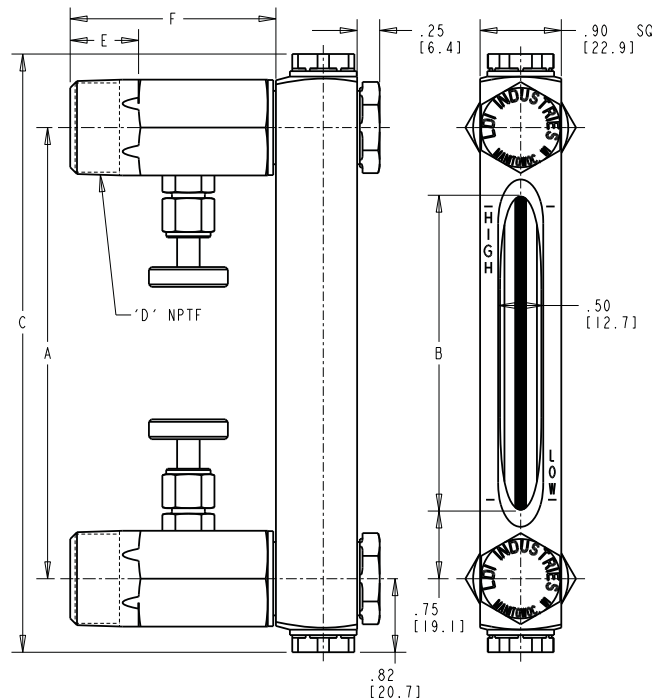

NOTE: All dimensions are inches [mm]

ORDERING OPTIONS CODES:

BODY MATERIAL

- A- Aluminum gage body (standard)
- B- Brass gage body (optional)
- S- Steel gage body (optional)
- Y- Stainless Steel gage body (optional)

SEAL MATERIAL

- 1- Buna N seals (standard)
- 2- Butyl seals (optional)
- 3- Viton® seals (optional)
- 4- Ethylene propylene seals (optional)
- 5- Silicone seals (optional)

SPECIFY PIPE THREAD SIZE:

- 2- 1/4 male pipe thread
- 3- 3/8 male pipe thread
- 4- 1/2 male pipe thread
- 5- 3/4 male pipe thread

G608 Series

A inches (mm)	B inches (mm)	C inches (mm)	Max. Work. Pressure PSI (kPa)
10.00 (254.00)	8.50 (215.90)	11.62 (295.15)	275 (1896)
12.00 (304.80)	10.50 (266.70)	13.62 (345.95)	270 (1862)
15.00 (381.00)	13.50 (342.90)	16.62 (422.15)	260 (1793)
18.00 (457.20)	16.50 (419.10)	19.62 (498.35)	240 (1655)
24.00 (609.60)	22.50 (571.50)	25.62 (650.75)	210 (1448)
30.00 (762.00)	28.50 (723.90)	31.62 (803.15)	185 (1276)

Pipe Adapter

D NPTF	E inches (mm)	F inches (mm)
1/4-18	.57 (14.48)	2.09 (53.09)
3/8-18	.57 (14.48)	2.09 (53.09)
1/2-14	.76 (19.30)	2.28 (57.91)
3/4-14	.76 (19.30)	2.28 (57.91)

HOW TO ORDER

EXAMPLE:

G608-10-A-1-4 — 1/2 inch pipe thread
 — Buna N Seals
 — Aluminum gage body
 — 10.00 (254.00 mm) mounting centers
 — Series G608



Dimensions and specifications are subject to change without notice. Not all items are Made-To-Stock, contact us for availability.

02/14

Ph : 920-682-6877
 Fx : 920-684-7210

LDI Industries

sales@ldi-industries.com
 www.ldi-industries.com

SIGHT GAGES - CLOSED CIRCUIT

G609 SERIES

The heavy duty G609 Series front mount closed circuit sight gages provide front viewing of the fluid level clearly delineated by a redline on white background integral to the glass sight all secured within an aluminum body. Installation is the similar to the G605 Series, but the robust construction of the G609 Series allows these gages to operate at higher working pressures.

Standard Features:

- Front mount
- Fluid level visible from front of gage (.62 inch wide)
- Viewing enhanced by redline on white background integral to sight glass
- Suitable for use with most hydraulic and machine lubricating oils

Standard Materials:

- Aluminum gage body and mounting bolts
- Buna N seals
- Borosilicate glass sight
- Zinc plated, steel hex nuts

Temperature and Pressure Ratings:

- 600 psi (4137 kPa) maximum working pressure at 150°F (65°C) for centerline lengths from 5 to 12 inches (*Consult factory for pressure ratings on centerline lengths outside this range*)
- Please refer to Temperature Ratings by Seal Material for additional operating conditions (Appendix RA-5 on page RA-A5)

NOTE:

- Please refer to Appendix RA-2 on page RA-A2 for installation instructions

CAUTION: • Not recommended for use with water, steam, acidic fluids, caustic fluids and volatile fluids

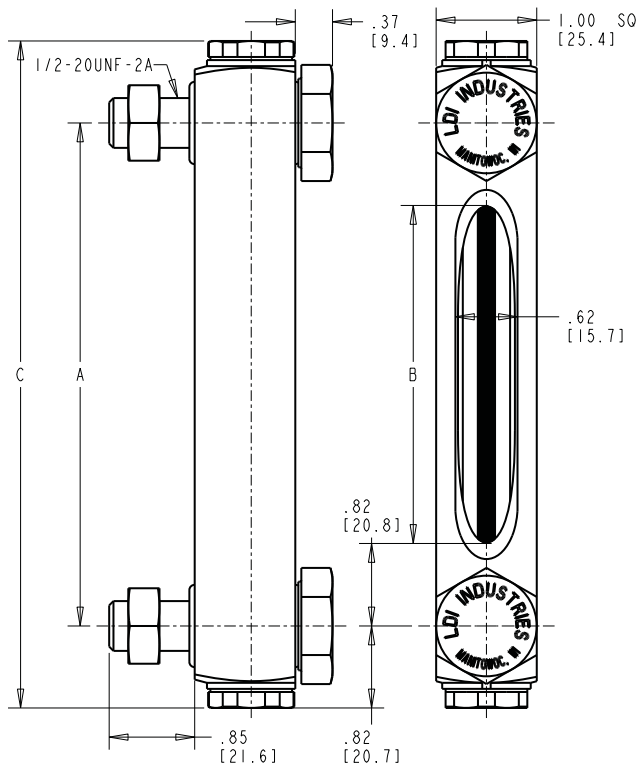

NOTE: All dimensions are inches [mm]

ORDERING OPTIONS CODES:

BODY MATERIAL

- A- Aluminum gage body (standard)
- B- Brass gage body (optional)
- S- Steel gage body (optional)
- Y- Stainless Steel gage body (optional)

SEAL MATERIAL

- 1- Buna N seals (standard)
- 2- Butyl seals (optional)
- 3- Viton® seals (optional)
- 4- Ethylene propylene seals (optional)
- 10- Neoprene seals (optional)

HOW TO ORDER

EXAMPLE:

G609-05-A-1 — Buna N Seals
 — Aluminum gage body
 — 5.00 (127.00 mm) mounting centers
 — Series G609

G609 Series				
Part No.	A inches (mm)	B inches (mm)	C inches (mm)	Max. Work. Pressure PSI (kPa)
G609-05-A-1	5.00 (127.00)	3.36 (85.34)	6.62 (168.15)	600 (4137)
G609-12-A-1	12.00 (304.80)	10.36 (263.14)	13.62 (345.95)	600 (4137)



Dimensions and specifications are subject to change without notice. Not all items are Made-To-Stock, contact us for availability.

02/14

Ph : 920-682-6877
 Fx : 920-684-7210

LDI Industries

sales@ldi-industries.com
 www.ldi-industries.com

SIGHT GAGES - CLOSED CIRCUIT

G610 SERIES

The G610 Series back mount closed circuit sight gages provide front viewing of the fluid level clearly delineated by a redline on white background integral to the sight glass all secured within an aluminum body. HIGH-LOW markings are stamped into the aluminum body.

Standard Features:

- Back mount
- Fluid level visible from front of gage (.50 inches wide)
- Viewing enhanced by redline on white background integral to sight glass
- Suitable for use with most hydraulic and machine lubricating oils

Standard Materials:

- Aluminum gage body and mounting bolts
- Buna N seals
- Borosilicate glass sight
- Zinc plated, steel hex nuts

Temperature and Pressure Ratings:

- Please refer to Appendix RA-1 on page RA-A1 for Sight Opening & Pressure Rating information
- Please refer to Temperature Ratings by Seal Material for additional operating conditions (Appendix RA-5 on page RA-A5)

NOTES:

- Access to inside of reservoir is required to mount this style sight gage
- Please refer to Appendix RA-3 on page RA-A3 for installation instructions

CAUTION: • Not recommended for use with water, steam, acidic fluids, caustic fluids and volatile fluids
• If aluminum construction is selected for a water application, anodizing is recommended

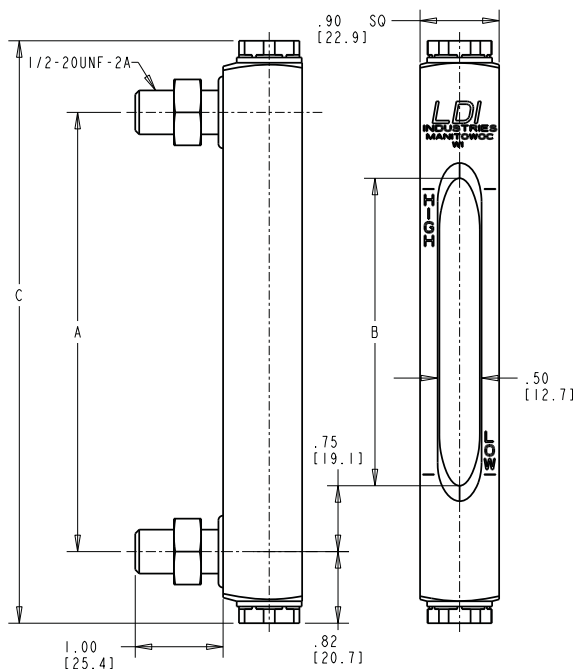

NOTE: All dimensions are inches [mm]

G610 Series		
A	B	C
inches (mm)	inches (mm)	inches (mm)
3.00 (76.20)	1.50 (38.10)	4.62 (117.35)
4.00 (101.60)	2.50 (63.50)	5.62 (142.75)
5.00 (127.00)	3.50 (88.90)	6.62 (168.15)
6.00 (152.40)	4.50 (114.30)	7.62 (193.55)
7.00 (177.80)	5.50 (139.70)	8.62 (218.95)
8.00 (203.20)	6.50 (165.10)	9.62 (244.35)
9.00 (228.60)	7.50 (190.50)	10.62 (269.75)
10.00 (254.00)	8.50 (215.90)	11.62 (295.15)
12.00 (304.80)	10.50 (266.70)	13.62 (345.95)



ORDERING OPTIONS CODES:

BODY MATERIAL

- A- Aluminum gage body (standard)
- B- Brass gage body (optional)
- S- Steel gage body (optional)
- Y- Stainless Steel gage body (optional)

SEAL MATERIAL

- 1- Buna N seals (standard)
- 2- Butyl seals (optional)
- 3- Viton® seals (optional)
- 4- Ethylene propylene seals (optional)
- 10- Neoprene seals (optional)

NOTE: The sight opening in all cases is 1.50 (38.10mm) less than mounting centers and overall length is 1.62 (41.15mm) greater than mounting centers.

HOW TO ORDER

EXAMPLE:

G610-05-A-1 — Buna N Seals
Aluminum gage body
5.00 (127.00 mm) mounting centers
Series G610

Dimensions and specifications are subject to change without notice. Not all items are Made-To-Stock, contact us for availability.

02/14

Ph : 920-682-6877
Fx : 920-684-7210



sales@ldi-industries.com
www.ldi-industries.com

SIGHT GAGES - CLOSED CIRCUIT

G613 SERIES

The G613 Series front mount closed circuit sight gage is mounted securely with end blocks made from aluminum. These end blocks are connected with a clear, rigid tubular Nylon sight providing 360° viewing of the fluid level. The Nylon sight combines rigidity with break resistant toughness.

Standard Features:

- Front mount
- 360° of viewing fluid level
- Suitable for use with most hydraulic and machine lubricating oils

Standard Materials:

- Aluminum end blocks and mounting bolts
- Nylon tubular sight
- Buna N seals

Temperature and Pressure Ratings:

- 225°F (107°C) maximum operating temperature
- 125 psi (862 kPa) maximum working pressure at 70°F (21°C)
- Please refer to Temperature Ratings by Seal Material for additional operating conditions (Appendix RA-5 on page RA-A5)

NOTE:

- Please refer to Appendix RA-8 on page RA-A8 for installation instructions

CAUTION: • Not recommended for use with diesel fuel, gasoline, ethylene glycol (antifreeze), polyglycols, ethyl alcohol, methyl alcohol, methyl ethyl ketone (MEK), acetone, isopropanol, water exceeding 194°F (90°C), steam, acidic, caustic and volatile fluids

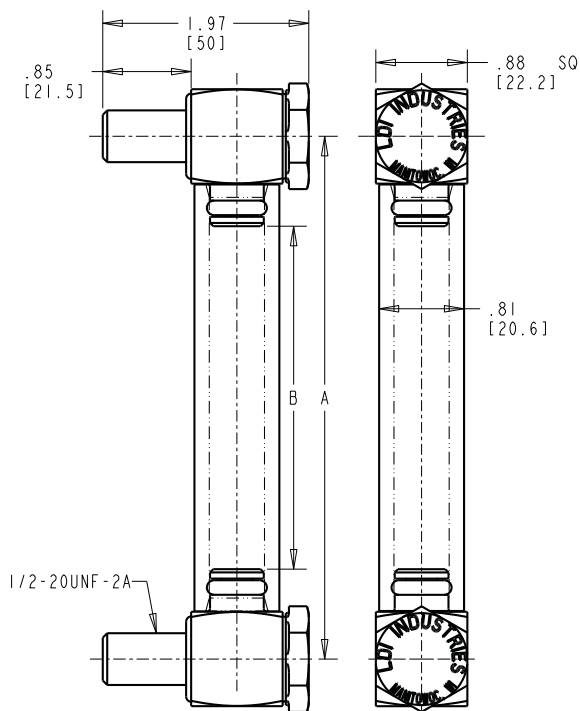

NOTE: All dimensions are inches [mm]

G613 Series	
A inches (mm)	B inches (mm)
3.00 (76.20)	1.28 (32.51)
4.00 (101.60)	2.28 (57.91)
5.00 (127.00)	3.28 (83.31)
6.00 (152.40)	4.28 (108.71)
7.00 (177.80)	5.28 (134.11)
8.00 (203.20)	6.28 (159.51)
9.00 (228.60)	7.28 (184.91)
10.00 (254.00)	8.28 (210.31)
11.00 (279.40)	9.28 (235.71)
12.00 (304.80)	10.28 (261.11)



ORDERING OPTIONS CODES:

BODY MATERIAL

- A- Aluminum end blocks (standard)
- B- Brass end blocks (optional)

SEAL MATERIAL

- 1- Buna N seals (standard)
- 2- Butyl seals (optional)
- 3- Viton® seals (optional)
- 4- Ethylene propylene seals (optional)

HOW TO ORDER

EXAMPLE:

G613-05-A-1 — Buna N Seals
 Aluminum end blocks
 5.00 (127.00 mm) mounting centers
 Series G613

Dimensions and specifications are subject to change without notice. Not all items are Made-To-Stock, contact us for availability.

02/14

Ph : 920-682-6877
 Fx : 920-684-7210



sales@ldi-industries.com
 www.ldi-industries.com

SIGHT GAGES - CLOSED CIRCUIT

GA613 SERIES

The GA613 Series front mount closed circuit sight gage is mounted securely with end blocks made from aluminum. These end blocks are connected with a clear, rigid tubular Nylon sight providing 360° viewing of the fluid level. The Nylon sight combines rigidity with break resistant toughness. Pipe adapters are provided with the gage for mounting directly to NPT couplings.

Standard Features:

- Front mount
- 360° of viewing fluid level
- Suitable for use with most hydraulic and machine lubricating oils

Standard Materials:

- Aluminum end blocks and mounting bolts
- Brass pipe adapters
- Nylon tubular sight
- Buna N seals

Temperature and Pressure Ratings:

- 225°F (107°C) maximum operating temperature
- 125 psi (862 kPa) maximum working pressure at 70°F (21°C)
- Please refer to Temperature Ratings by Seal Material for additional operating conditions (Appendix RA-5 on page RA-A5)

NOTE:

- Please refer to Appendix RA-7 on page RA-A7 for installation instructions

CAUTION: • Not recommended for use with diesel fuel, gasoline, ethylene glycol (antifreeze), polyglycols, ethyl alcohol, methyl alcohol, methyl ethyl ketone (MEK), acetone, isopropanol, water exceeding 194°F (90°C), steam, acidic, caustic and volatile fluids

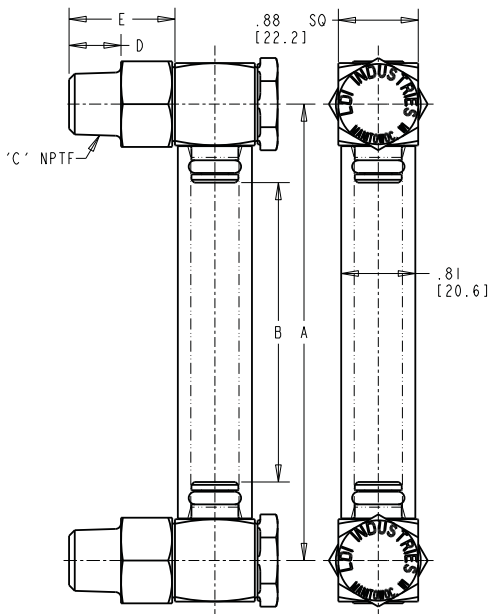

NOTE: All dimensions are inches [mm]

GA613 Series	
A inches (mm)	B inches (mm)
3.00 (76.20)	1.28 (32.51)
4.00 (101.60)	2.28 (57.91)
5.00 (127.00)	3.28 (83.31)
6.00 (152.40)	4.28 (108.71)
7.00 (177.80)	5.28 (134.11)
8.00 (203.20)	6.28 (159.51)
9.00 (228.60)	7.28 (184.91)
10.00 (254.00)	8.28 (210.31)
11.00 (279.40)	9.28 (235.71)
12.00 (304.80)	10.28 (261.11)

Pipe Adapter		
C NPTF	D inches (mm)	E inches (mm)
1/4-18	.56 (14.22)	1.19 (30.23)
3/8-18	.56 (14.22)	1.12 (28.45)
1/2-14	.75 (19.05)	1.12 (28.45)
3/4-14	.75 (19.05)	1.12 (28.45)

ORDERING OPTIONS CODES:

BODY MATERIAL

- A- Aluminum end blocks (standard)
- B- Brass end blocks (optional)
- S- Steel end blocks (optional)
- Y- Stainless Steel end blocks (optional)

SEAL MATERIAL

- 1- Buna N seals (standard)
- 2- Butyl seals (optional)
- 3- Viton® seals (optional)
- 4- Ethylene propylene seals (optional)
- 5- Silicone seals (optional)

SPECIFY PIPE THREAD SIZE:

- 2- 1/4 male pipe thread
- 3- 3/8 male pipe thread
- 4- 1/2 male pipe thread
- 5- 3/4 male pipe thread

HOW TO ORDER

EXAMPLE:

GA613-06-A-1-4 — 1/2 inch NPTF
 Buna N Seals
 Aluminum end blocks
 6.00 (152.40 mm) mounting centers
 Series GA613



Dimensions and specifications are subject to change without notice. Not all items are Made-To-Stock, contact us for availability.

02/14

SIGHT GAGES - CLOSED CIRCUIT

GT613 SERIES

The GT613 Series front mount closed circuit sight gage is mounted securely with end blocks made from aluminum. These end blocks are connected with a clear, rigid tubular Nylon sight providing 360° viewing of the fluid level. The Nylon sight combines rigidity with break resistant toughness. A wetted dial thermometer provides direct reading of the fluid temperature.

Standard Features:

- Front mount
- 360° of viewing fluid level
- 1.38" diameter dual scale dial thermometer, 50° to 300°F and 10° to 150°C
- Suitable for use with most hydraulic and machine lubricating oils

Standard Materials:

- Aluminum end blocks and mounting bolts
- Nylon tubular sight
- Buna N seals

Temperature and Pressure Ratings:

- 225°F (107°C) maximum operating temperature
- 125 psi (862 kPa) maximum working pressure at 70°F (21°C)
- Please refer to Temperature Ratings by Seal Material for additional operating conditions (Appendix RA-5 on page RA-A5)

NOTE:

- Please refer to Appendix RA-8 on page RA-A8 for installation instructions

CAUTION: • Not recommended for use with diesel fuel, gasoline, ethylene glycol (antifreeze), polyglycols, ethyl alcohol, methyl alcohol, methyl ethyl ketone (MEK), acetone, isopropanol, water exceeding 194°F (90°C), steam, acidic, caustic and volatile fluids
• Reservoir must be drained to remove dial thermometer or loss of fluid will occur

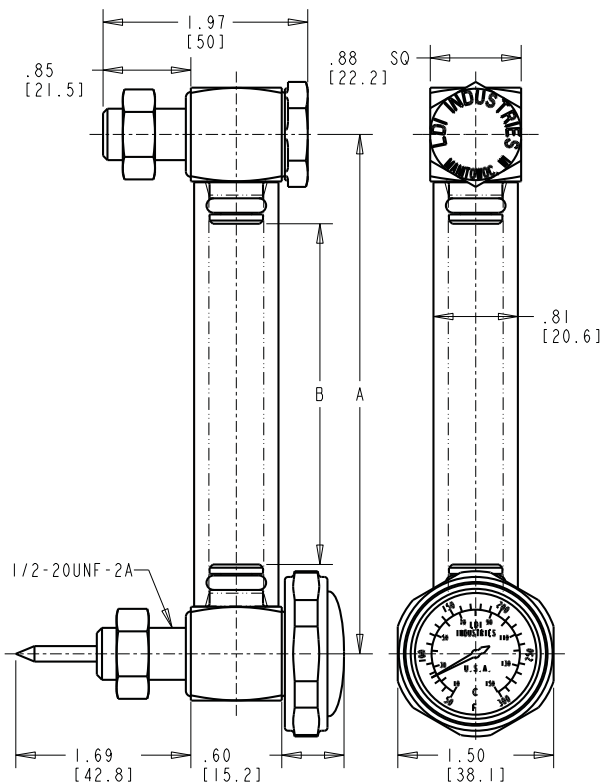

NOTE: All dimensions are inches [mm]

GT613 Series

A inches (mm)	B inches (mm)
3.00 (76.20)	1.28 (32.51)
4.00 (101.60)	2.28 (57.91)
5.00 (127.00)	3.28 (83.31)
6.00 (152.40)	4.28 (108.71)
7.00 (177.80)	5.28 (134.11)
8.00 (203.20)	6.28 (159.51)
9.00 (228.60)	7.28 (184.91)
10.00 (254.00)	8.28 (210.31)
11.00 (279.40)	9.28 (235.71)
12.00 (304.80)	10.28 (261.11)



ORDERING OPTIONS CODES:

BODY MATERIAL

- A- Aluminum end blocks (standard)
- B- Brass end blocks (optional)

SEAL MATERIAL

- 1- Buna N seals (standard)
- 2- Butyl seals (optional)
- 3- Viton® seals (optional)
- 4- Ethylene propylene seals (optional)

HOW TO ORDER

EXAMPLE:

GT613-05-A-1 — Buna N Seals
Aluminum end blocks
5.00 (127.00 mm) mounting centers
Series GT613

Dimensions and specifications are subject to change without notice. Not all items are Made-To-Stock, contact us for availability.

02/14

Ph : 920-682-6877
Fx : 920-684-7210



sales@ldi-industries.com
www.ldi-industries.com

SIGHT GAGES - CLOSED CIRCUIT

G615 SERIES

The G615 Series front mount closed circuit sight gages provide front viewing of the fluid level clearly delineated by a redline on white background integral to the glass sight all secured within an aluminum body. HIGH-LOW markings are stamped into the aluminum body and a wetted dial thermometer provides direct reading of the fluid temperature.

Standard Features:

- Front mount
- Fluid level visible from front of gage (.50 inches wide)
- Viewing enhanced by redline on white background integral to sight glass
- 1.38" diameter dual scale dial thermometer, 50° to 300°F and 10° to 150°C
- Suitable for use with most hydraulic and machine lubricating oils

Standard Materials:

- Aluminum gage body and mounting bolts
- Buna N seals
- Borosilicate glass sight
- Zinc plated, steel hex nuts

Temperature and Pressure Ratings:

- Please refer to Appendix RA-1 on page RA-A1 for Sight Opening & Pressure Rating information
- Please refer to Temperature Ratings by Seal Material for additional operating conditions (Appendix RA-5 on page RA-A5)

NOTE:

- Please refer to Appendix RA-2 on page RA-A2 for installation instructions

CAUTION: • Not recommended for use with water, steam, acidic fluids, caustic fluids and volatile fluids
 • If aluminum construction is selected for a water application, anodizing is recommended
 • Reservoir must be drained to remove dial thermometer or loss of fluid will occur

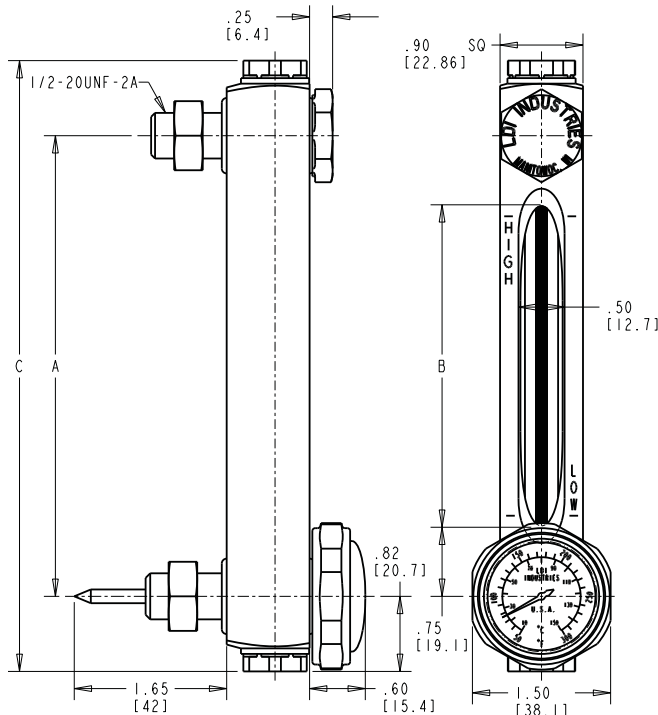

NOTE: All dimensions are inches [mm]

ORDERING OPTIONS CODES:

BODY MATERIAL

- A- Aluminum gage body (standard)
- B- Brass gage body (optional)
- S- Steel gage body (optional)
- Y- Stainless Steel gage body (optional)

SEAL MATERIAL

- 1- Buna N seals (standard)
- 2- Butyl seals (optional)
- 3- Viton® seals (optional)
- 4- Ethylene propylene seals (optional)
- 10- Neoprene seals (optional)

G615 Series		
A inches (mm)	B inches (mm)	C inches (mm)
3.00 (76.20)	1.50 (38.10)	4.62 (117.35)
4.00 (101.60)	2.50 (63.50)	5.62 (142.75)
5.00 (127.00)	3.50 (88.90)	6.62 (168.15)
6.00 (152.40)	4.50 (114.30)	7.62 (193.55)
7.00 (177.80)	5.50 (139.70)	8.62 (218.95)
8.00 (203.20)	6.50 (165.10)	9.62 (244.35)
9.00 (228.60)	7.50 (190.50)	10.62 (269.75)
10.00 (254.00)	8.50 (215.90)	11.62 (295.15)
11.00 (279.40)	9.50 (241.30)	12.62 (320.55)
12.00 (304.80)	10.50 (266.70)	13.62 (345.95)

NOTE: The sight opening in all cases is 1.50 inches (38.10mm) less than mounting centers and overall length is 1.62 inches (41.15mm) greater than mounting centers. Gages with 13.00 inch (330.20mm) and greater mounting centers are furnished with spacer sleeves to space gage from tank allowing for bowing of the tank wall in larger reservoirs. Center mounting kits are furnished with gages 48.00 inches (1219.20mm) and greater mounting centers.

HOW TO ORDER

EXAMPLE:

G615-05-A-1 — Buna N Seals
 Aluminum gage body
 5.00 (127.00 mm) mounting centers
 Series G615



Dimensions and specifications are subject to change without notice. Not all items are Made-To-Stock, contact us for availability.

02/14

Ph : 920-682-6877
 Fx : 920-684-7210

LDI Industries

sales@ldi-industries.com
 www.ldi-industries.com

SIGHT GAGES - CLOSED CIRCUIT

G617 SERIES

The G617 Series front mount closed circuit sight gages provide front viewing of the fluid level clearly delineated by a redline on white background integral to the sight glass all secured within an aluminum body (HIGH-LOW markings). Brass pipe adapters are provided with each sight gage for assembly of the sight gage to NPT couplings. Integral to the sight gage body is a wetted dial thermometer providing direct reading of the fluid temperature.

Standard Features:

- Front mount
- Fluid level visible from front of gage (.50 inches wide)
- Viewing enhanced by redline on white background integral to sight glass
- 1.38" diameter dual scale dial thermometer, 50° to 300°F and 10° to 150°C
- Suitable for use with most hydraulic and machine lubricating oils

Standard Materials:

- Aluminum gage body and mounting bolts
- Brass pipe adapters
- Buna N seals
- Borosilicate glass sight

Temperature and Pressure Ratings:

- 125 psi (862 kPa) maximum working pressure at 150°F (65°C)
- Please refer to Temperature Ratings by Seal Material for additional operating conditions (Appendix RA-5 on page RA-A5)

NOTE:

- Please refer to Appendix RA-7 on page RA-A7 for installation instructions

CAUTION: • Not recommended for use with water, steam, acidic fluids, caustic fluids and volatile fluids
 • If aluminum construction is selected for a water application, anodizing is recommended
 • Reservoir must be drained to remove dial thermometer or loss of fluid will occur

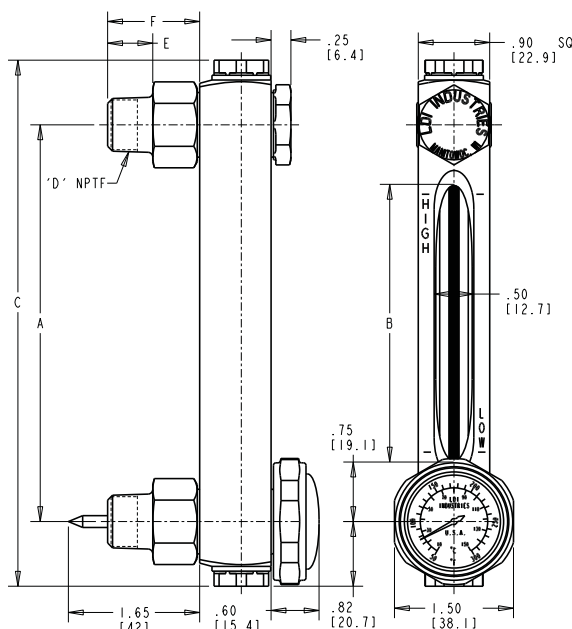

NOTE: All dimensions are inches [mm]

ORDERING OPTIONS CODES:

BODY MATERIAL

- A- Aluminum gage body (standard)
- B- Brass gage body (optional)
- S- Steel gage body (optional)
- Y- Stainless Steel gage body (optional)

SEAL MATERIAL

- 1- Buna N seals (standard)
- 2- Butyl seals (optional)
- 3- Viton® seals (optional)
- 4- Ethylene propylene seals (optional)
- 5- Silicone seals (optional)

SPECIFY PIPE THREAD SIZE:

- 2- 1/4 male pipe thread
- 3- 3/8 male pipe thread
- 4- 1/2 male pipe thread
- 5- 3/4 male pipe thread

G617 Series		
A	B	C
inches (mm)	inches (mm)	inches (mm)
5.00 (127.00)	3.50 (88.90)	6.62 (168.15)
6.00 (152.40)	4.50 (114.30)	7.62 (193.55)
7.00 (177.80)	5.50 (139.70)	8.62 (218.95)
8.00 (203.20)	6.50 (165.10)	9.62 (244.35)
9.00 (228.60)	7.50 (190.50)	10.62 (269.75)
10.00 (254.00)	8.50 (215.90)	11.62 (295.15)
12.00 (304.80)	10.50 (266.70)	13.62 (345.95)

Pipe Adapter		
D	E	F
NPTF	inches (mm)	inches (mm)
1/4-18	.56 (14.22)	1.19 (30.23)
3/8-18	.56 (14.22)	1.12 (28.45)
1/2-14	.75 (19.05)	1.12 (28.45)
3/4-14	.75 (19.05)	1.12 (28.45)

HOW TO ORDER

EXAMPLE:

G617-06-A-1-4 — 1/2 inch pipe thread
 — Buna N Seals
 — Aluminum gage body
 — 6.00 (152.40 mm) mounting centers
 — Series G617



Dimensions and specifications are subject to change without notice. Not all items are Made-To-Stock, contact us for availability.

02/14

Ph : 920-682-6877
 Fx : 920-684-7210

LDI Industries

sales@ldi-industries.com
 www.ldi-industries.com

SIGHT GAGES - CLOSED CIRCUIT

G619 SERIES

The heavy duty G619 Series front mount closed circuit sight gages provide front viewing of the fluid level clearly delineated by a redline on white background integral to the glass sight all secured within an aluminum body. A dry dial thermometer allows for temperature monitoring. The thermowell for the thermometer combines with the thermometer shield to serve as one of the mounting bolts for the sight gage. This construction allows the thermometer orientation to be adjusted independent of the sight gage and replaced without having to drain the reservoir. Installation is the similar to the G615 Series, but the robust construction of the G619 Series allows these gages to operate at higher working pressures.

Standard Features:

- Front mount
- Fluid level visible from front of gage (.62 inch wide)
- Viewing enhanced by redline on white background integral to sight glass
- 1.38" diameter dual scale dial thermometer, 50° to 300°F and 10° to 150°C
- Dial thermometer may be removed from a filled reservoir without loss of fluid
- Suitable for use with most hydraulic and machine lubricating oils

Standard Materials:

- Aluminum gage body and mounting bolt
- Buna N seals
- Borosilicate glass sight
- Zinc plated, steel hex nuts

Temperature and Pressure Ratings:

- 600 psi (4137 kPa) maximum working pressure at 150°F (65°C) for centerline lengths from 4 to 12 inches (*Consult factory for pressure ratings on centerline lengths outside this range*)
- Please refer to Temperature Ratings by Seal Material for additional operating conditions (Appendix RA-5 on page RA-A5)

NOTE:

- Please refer to Appendix RA-2 on page RA-A2 for installation instructions

CAUTION: • Not recommended for use with water, steam, acidic fluids, caustic fluids and volatile fluids

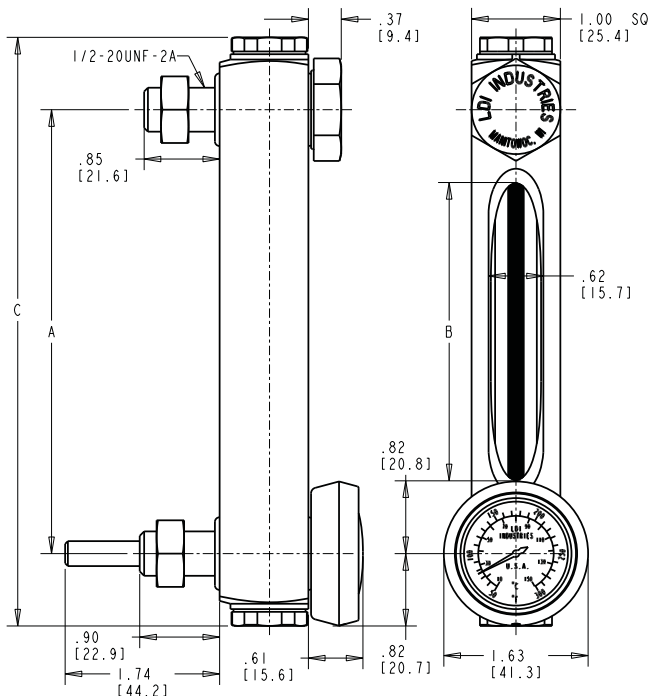

NOTE: All dimensions are inches [mm]

ORDERING OPTIONS CODES:

BODY MATERIAL

- A- Aluminum gage body (standard)
- B- Brass gage body (optional)
- S- Steel gage body (optional)
- Y- Stainless Steel gage body (optional)

SEAL MATERIAL

- 1- Buna N seals (standard)
- 2- Butyl seals (optional)
- 3- Viton® seals (optional)
- 4- Ethylene propylene seals (optional)
- 10- Neoprene seals (optional)

HOW TO ORDER

EXAMPLE:

G619-05-A-1 — Buna N Seals
 Aluminum gage body
 5.00 (127.00 mm) mounting centers
 Series G619

G619 Series				
Part No.	A inches (mm)	B inches (mm)	C inches (mm)	Max. Work. Pressure PSI (kPa)
G619-05-A-1	5.00 (127.00)	3.36 (85.34)	6.62 (168.15)	600 (4137)
G619-12-A-1	12.00 (304.80)	10.36 (263.14)	13.62 (345.95)	600 (4137)



Dimensions and specifications are subject to change without notice. Not all items are Made-To-Stock, contact us for availability.

02/14

Ph : 920-682-6877
 Fx : 920-684-7210

LDI Industries

sales@ldi-industries.com
 www.ldi-industries.com

SIGHT GAGES - CLOSED CIRCUIT

G620 SERIES

The G620 Series back mount closed circuit sight gages provide front viewing of the fluid level clearly delineated by a redline on white background integral to the sight glass all secured within an aluminum body (HIGH-LOW markings). A wetted dial thermometer provides an analog display of the fluid temperature.

Standard Features:

- Back mount
- Fluid level visible from front of gage (.50 inches wide)
- Viewing enhanced by redline on white background integral to sight glass
- 1.38" diameter dual scale dial thermometer, 50° to 300°F and 10° to 150°C
- Aluminum tube shields thermometer probe extending into reservoir
- Suitable for use with most hydraulic and machine lubricating oils

Standard Materials:

- Aluminum gage body
- Buna N seals
- Borosilicate glass sight
- Zinc plated, steel hex nuts

Temperature and Pressure Ratings:

- Please refer to Appendix RA-1 on page RA-A1 for Sight Opening & Pressure Rating information
- Please refer to Temperature Ratings by Seal Material for additional operating conditions (Appendix RA-5 on page RA-A5)

NOTES:

- Access to inside of reservoir is required to mount this style sight gage
- Please refer to Appendix RA-3 on page RA-A3 for installation instructions

CAUTION: • Not recommended for use with water, steam, acidic fluids, caustic fluids and volatile fluids
 • If aluminum construction is selected for a water application, anodizing is recommended
 • Reservoir must be drained to remove dial thermometer or loss of fluid will occur

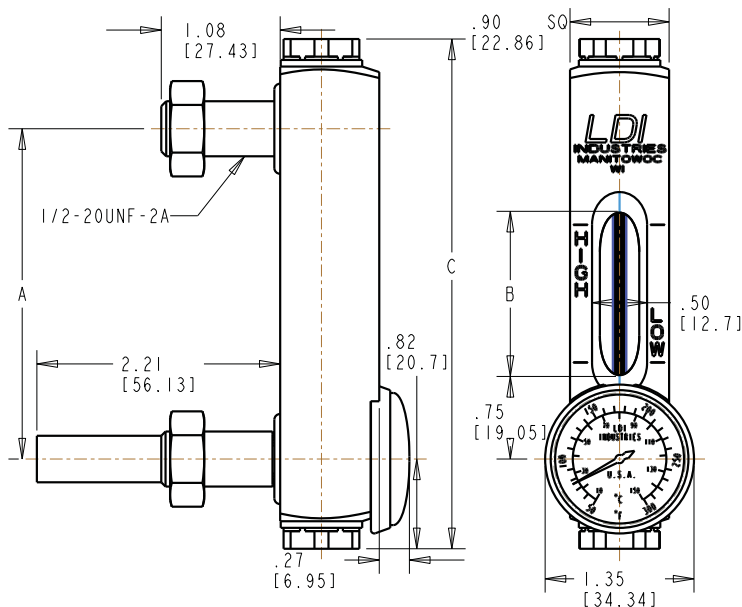

NOTE: All dimensions are inches [mm]

G620 Series		
A	B	C
inches (mm)	inches (mm)	inches (mm)
3.00 (76.20)	1.50 (38.10)	4.62 (117.35)
4.00 (101.60)	2.50 (63.50)	5.62 (142.75)
5.00 (127.00)	3.50 (88.90)	6.62 (168.15)
6.00 (152.40)	4.50 (114.30)	7.62 (193.55)
7.00 (177.80)	5.50 (139.70)	8.62 (218.95)
8.00 (203.20)	6.50 (165.10)	9.62 (244.35)
9.00 (228.60)	7.50 (190.50)	10.62 (269.75)
10.00 (254.00)	8.50 (215.90)	11.62 (295.15)
12.00 (304.80)	10.50 (266.70)	13.62 (345.95)



ORDERING OPTIONS CODES:

BODY MATERIAL

- A- Aluminum gage body (standard)
- B- Brass gage body (optional)
- S- Steel gage body (optional)
- Y- Stainless Steel gage body (optional)

SEAL MATERIAL

- 1- Buna N seals (standard)
- 2- Butyl seals (optional)
- 3- Viton® seals (optional)
- 4- Ethylene propylene seals (optional)
- 10- Neoprene seals (optional)

NOTE: The sight opening in all cases is 1.50 inch (38.10mm) less than mounting centers and overall length is 1.62 inch (41.15mm) greater than mounting centers.

HOW TO ORDER

EXAMPLE:

G620-05-A-1 — Buna N Seals
 — Aluminum gage body
 — 5.00 (127.00 mm) mounting centers
 — Series G620

Dimensions and specifications are subject to change without notice. Not all items are Made-To-Stock, contact us for availability.

02/14

Ph : 920-682-6877
 Fx : 920-684-7210



sales@ldi-industries.com
 www.ldi-industries.com

SIGHT GAGES - CLOSED CIRCUIT

G623 SERIES

G623 Series front mount closed circuit low profile sight gages are molded from a clear Nylon providing 180° of viewing. A white insert integral to the sight gage helps draw eye contact to the fluid level quickly.

Standard Features:

- Front mount
- Tough, break resistant, transparent molded Nylon gage body
- 180° of viewing fluid level
- Viewing enhanced by white background integral to molded gage body
- Suitable for use with most hydraulic and machine lubricating oils

Standard Materials:

- Constructed with a molded, transparent Nylon
- Buna N seals
- Black, powder coated steel guard

Temperature and Pressure Ratings:

- 212°F (100°C) maximum operating temperature
- 50 psi (345 kPa) maximum operating pressure at 70°F (21°C)
- Please refer to Temperature Ratings by Seal Material for additional operating conditions (Appendix RA-5 on page RA-A5)

NOTE:

- Please refer to Appendix RA-9 on page RA-A9 for installation instructions

CAUTION: • Not recommended for use with alcohol or steam

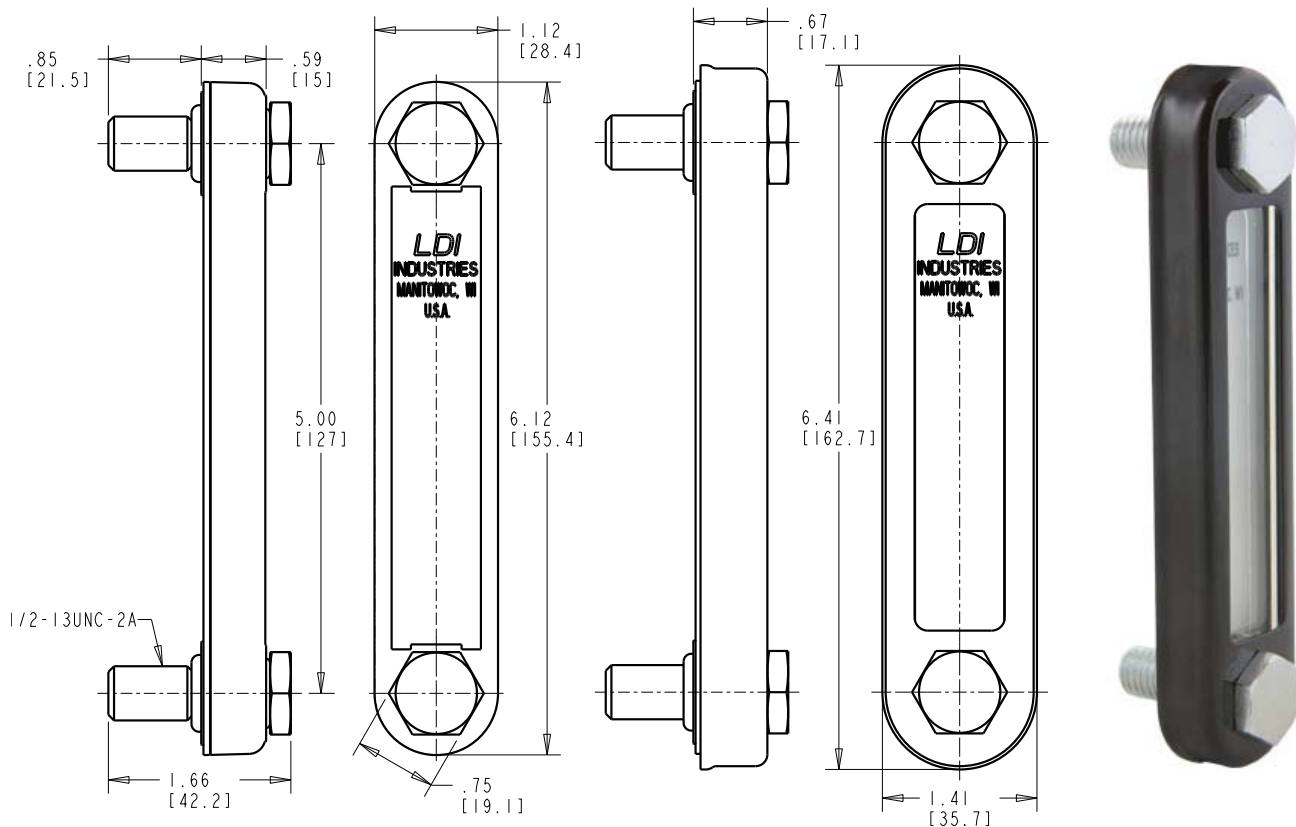

NOTE: All dimensions are inches [mm]

ORDERING OPTIONS CODES:

SEAL MATERIAL

- 1- Buna N seals (standard)
- 3- Viton® seals (optional)
- M- M12 x 1.75 bolts (optional)
- G- Guard (optional)

HOW TO ORDER

EXAMPLE:

- G623-05-PG-1C** — 1/2-13 UNC bolts, std
 — Buna N Seals
 — Guard
 — Polymer body
 — 5.00 (127.00 mm) mounting centers
 — Series G623

Dimensions and specifications are subject to change without notice. Not all items are Made-To-Stock, contact us for availability.

02/14

Ph : 920-682-6877
 Fx : 920-684-7210



sales@ldi-industries.com
 www.ldi-industries.com

SIGHT GAGES - CLOSED CIRCUIT

GT623 SERIES

G623 Series front mount closed circuit low profile sight gages are molded from a clear Nylon providing 180° of viewing. A white insert integral to the sight gage helps draw eye contact to the fluid level quickly.

Standard Features:

- Front mount
- Tough, break resistant, transparent molded Nylon gage body
- 180° of viewing fluid level
- Viewing enhanced by white background integral to molded gage body
- Card thermometer, dual scale 0°F to 220°F and -20°C to 110°C
- Suitable for use with most hydraulic and machine lubricating oils

Standard Materials:

- Constructed with a molded, transparent Nylon
- Red color alcohol within thermometer bulb
- Buna N seals

Temperature and Pressure Ratings:

- 212°F (100°C) maximum operating temperature
- 50 psi (345 kPa) maximum operating pressure at 70°F (21°C)
- Please refer to Temperature Ratings by Seal Material for additional operating conditions (Appendix RA-5 on page RA-A5)

NOTE:

- Please refer to Appendix RA-9 on page RA-A9 for installation instructions

CAUTION: • Not recommended for use with alcohol or steam

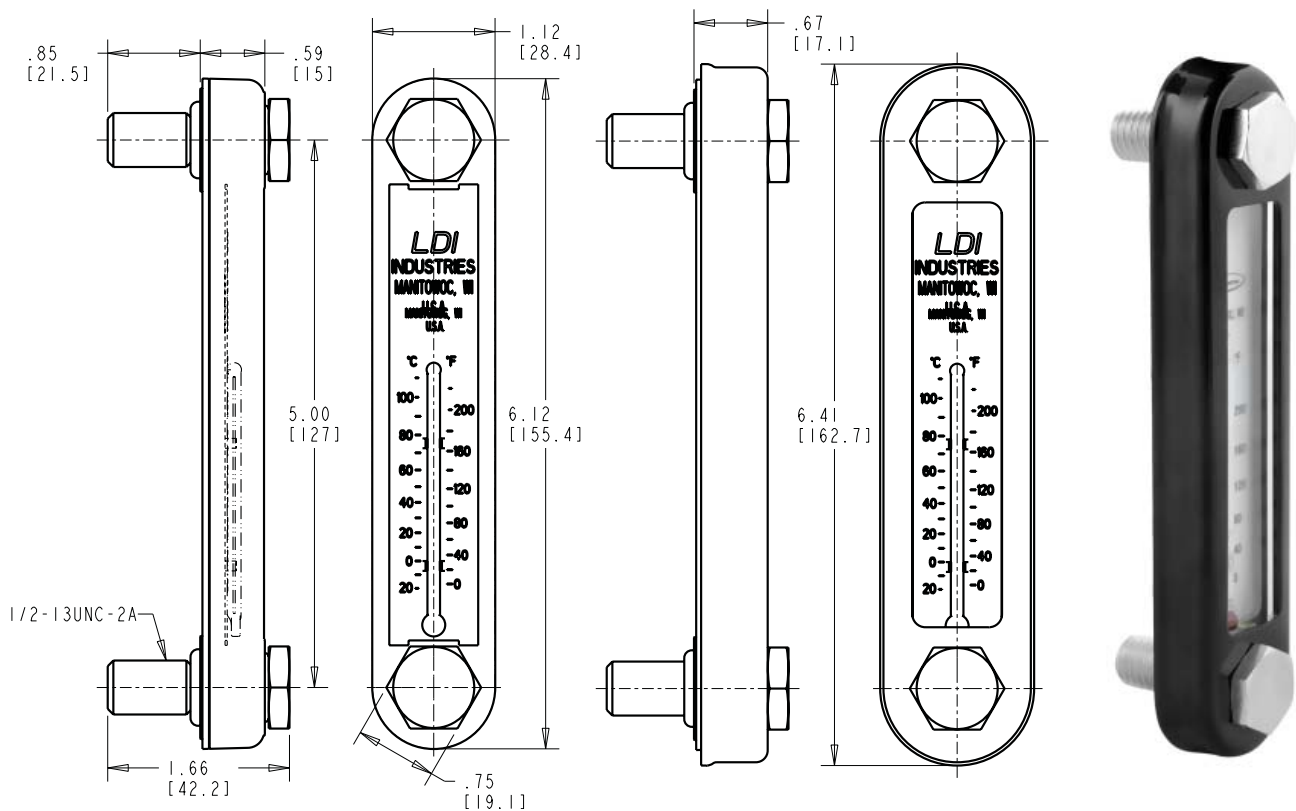

NOTE: All dimensions are inches [mm]

ORDERING OPTIONS CODES:

SEAL MATERIAL

- 1- Buna N seals (standard)
- 3- Viton® seals (optional)
- M- M12 x 1.75 bolts (optional)
- G- Guard (optional)

HOW TO ORDER

EXAMPLE:

- GT623-05-PG-1C**
- 1/2-13 UNC bolts, std
 - Buna N Seals
 - Guard
 - Polymer body
 - 5.00 (127.00 mm) mounting centers
 - Series GT623

Dimensions and specifications are subject to change without notice. Not all items are Made-To-Stock, contact us for availability.

02/14

Ph : 920-682-6877
Fx : 920-684-7210



sales@ldi-industries.com
www.ldi-industries.com

SIGHT GAGES - CLOSED CIRCUIT

G632 SERIES

The G632 Series back mount closed circuit sight gages provide 270° of viewing the fluid level clearly delineated by a redline on white background integral to the sight glass all secured within an aluminum body (HIGH-LOW markings). A wetted front facing dial thermometer provides an analog display of the fluid temperature. The oversized gage body allows a deeper recess of the sight glass and dial thermometer for maximum protection of these components against damage.

Standard Features:

- Back mount
- 270° of viewing the fluid level (.88 inch front and .50 inch side width windows)
- Viewing enhanced by redline on white background integral to sight glass
- 1.38 inch diameter dual scale dial thermometer, 50° to 300°F and 10° to 150°C
- Aluminum tube shields thermometer probe extending into reservoir
- Suitable for use with most hydraulic and machine lubricating oils

Standard Materials:

- Aluminum construction
- Buna N seals
- Borosilicate glass sight
- Zinc plated, steel hex nuts

Temperature and Pressure Ratings:

- 125 psi (862 kPa) maximum working pressure at 150°F (65°C)
- Please refer to Temperature Ratings by Seal Material for additional operating conditions (Appendix RA-5 on page RA-A5)

NOTES:

- Access to inside of reservoir is required to mount this style sight gage
- Please refer to Appendix RA-3 on page RA-A3 for installation instructions

CAUTION: • Not recommended for use with water, steam, acidic fluids, caustic fluids and volatile fluids
• Reservoir must be drained to remove dial thermometer or loss of fluid will occur

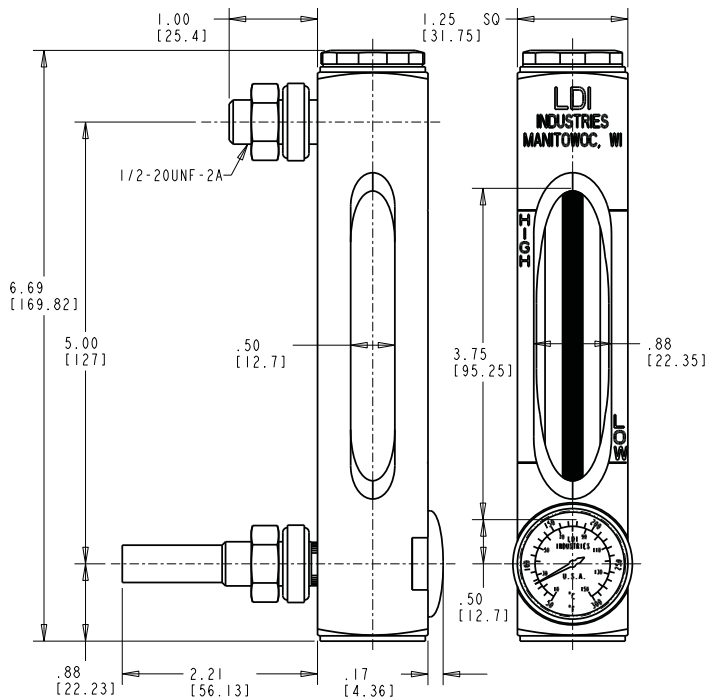

NOTE: All dimensions are inches [mm]

ORDERING OPTIONS CODES:

BODY MATERIAL

-A- Aluminum gage body (standard)

SEAL MATERIAL

- 1- Buna N seals (standard)
- 2- Butyl seals (optional)
- 3- Viton® seals (optional)
- 4- Ethylene propylene seals (optional)
- 5- Silicone seals (optional)

HOW TO ORDER

EXAMPLE:

G632-05-A-1 — Buna N Seals
Aluminum gage body
5.00 (127.00 mm) mounting centers
Series G632



Dimensions and specifications are subject to change without notice. Not all items are Made-To-Stock, contact us for availability.

02/14

Ph : 920-682-6877
Fx : 920-684-7210

LDI Industries

sales@ldi-industries.com
www.ldi-industries.com

SIGHT GAGES - CLOSED CIRCUIT

G635 SERIES

The G635 Series front mount closed circuit sight gage provides 270° of viewing the fluid level clearly delineated by a redline on white background integral to the sight glass all secured within an aluminum body (HIGH-LOW markings). The oversized gage body allows a deeper recess of the sight glass for maximum protection of the sight glass against damage.

Standard Features:

Front mount
270° of viewing the fluid level (.88 inch front and .50 inch side width windows)
Viewing enhanced by redline on white background integral to sight glass
Suitable for use with most hydraulic and machine lubricating oils

Standard Materials:

- Aluminum gage body and mounting bolts
- Buna N seals
- Borosilicate glass sight
- Zinc plated, steel hex nuts

Temperature and Pressure Ratings:

- Please refer to Appendix RA-1 on page RA-A1 for Sight Opening & Pressure Rating information
- Please refer to Temperature Ratings by Seal Material for additional operating conditions (Appendix RA-5 on page RA-A5))

NOTE:

- Please refer to Appendix RA-2 on page RA-A2 for installation instructions

CAUTION: • Not recommended for use with water, steam, acidic fluids, caustic fluids and volatile fluids
• If aluminum construction is selected for a water application, anodizing is recommended

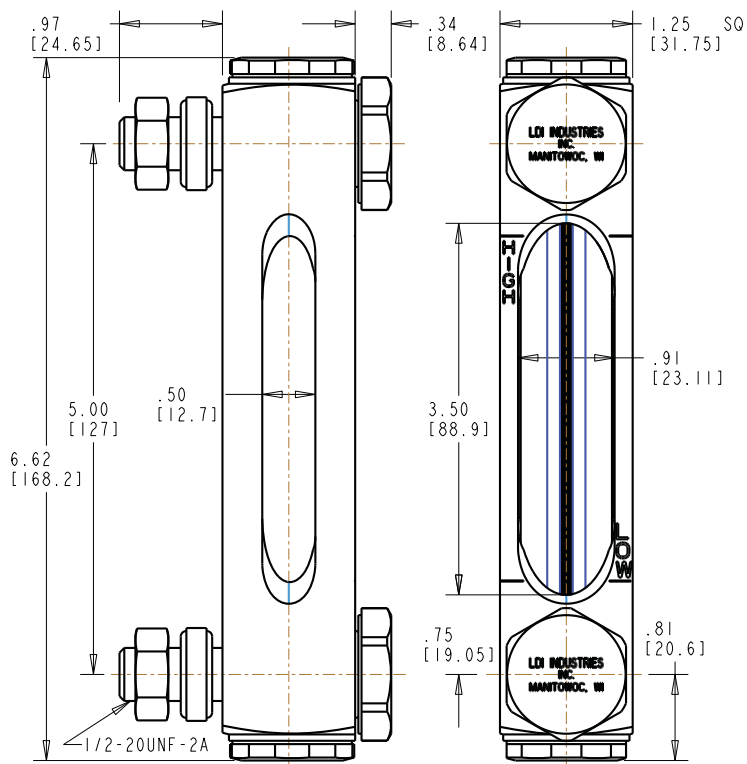

NOTE: All dimensions are inches [mm]



ORDERING OPTIONS CODES:

BODY MATERIAL

- A- Aluminum gage body (standard)
- B- Brass gage body (optional)

SEAL MATERIAL

- 1- Buna N seals (standard)
- 2- Butyl seals (optional)
- 3- Viton® seals (optional)
- 4- Ethylene propylene seals (optional)
- 5- Silicone seals (optional)

HOW TO ORDER

EXAMPLE:

- G635-05-A-1** — Buna N Seals
Aluminum gage body
5.00 (127.00 mm) mounting centers
Series G635

Dimensions and specifications are subject to change without notice. Not all items are Made-To-Stock, contact us for availability.

02/14

Ph : 920-682-6877
Fx : 920-684-7210



sales@ldi-industries.com
www.ldi-industries.com

SIGHT GAGES - CLOSED CIRCUIT

G640 SERIES

The G640 Series back mount closed circuit sight gages provide front viewing of the fluid level clearly delineated by a redline on white background integral to the sight glass all secured within an aluminum body (HIGH-LOW markings). A wetted dial thermometer provides an analog display of the fluid temperature.

Standard Features:

- Back mount
- Fluid level visible from front of gage (.50 inches wide)
- Viewing enhanced by redline on white background integral to sight glass
- 1.81" diameter dual scale dial thermometer, 0° to 300°F and -20° to 150°C
- Aluminum tube shields thermometer probe extending into reservoir
- Suitable for use with most hydraulic and machine lubricating oils

Standard Materials:

- Aluminum construction
- Buna N seals
- Borosilicate glass sight
- Zinc plated, steel hex nuts

Temperature and Pressure Ratings:

- 125 psi (862 kPa) maximum working pressure at 150°F (65°C)
- Please refer to Temperature Ratings by Seal Material for additional operating conditions (Appendix RA-5 on page RA-A5)

NOTES:

- Access to inside of reservoir is required to mount this style sight gage
- Please refer to Appendix RA-3 on page RA-A3 for installation instructions

CAUTION: • Not recommended for use with water, steam, acidic fluids, caustic fluids and volatile fluids
 • If aluminum construction is selected for a water application, anodizing is recommended
 • Reservoir must be drained to remove dial thermometer or loss of fluid will occur

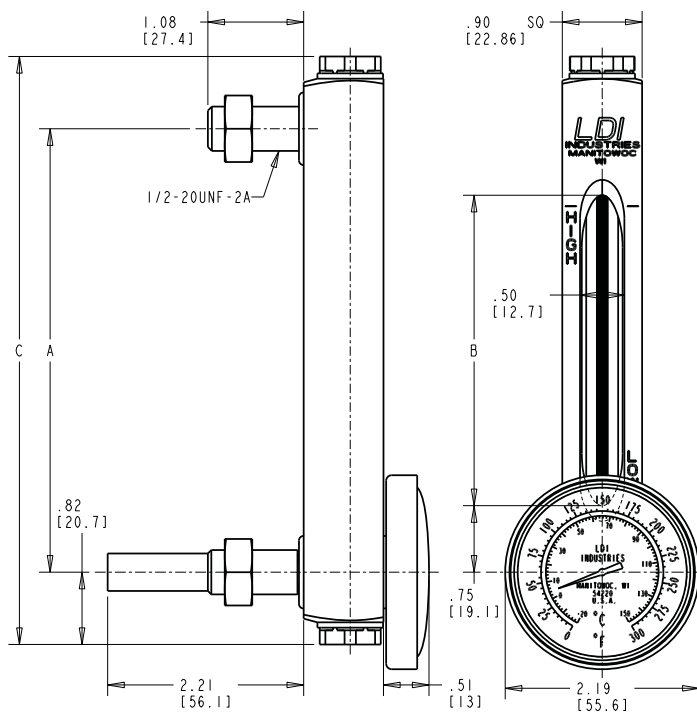

NOTE: All dimensions are inches [mm]

G640 Series		
A	B	C
inches	inches	inches
(mm)	(mm)	(mm)
5.00	3.50	6.62
(127.00)	(88.90)	(168.15)
6.00	4.50	7.62
(152.40)	(114.30)	(193.55)
10.00	8.50	11.62
(254.00)	(215.90)	(295.15)
12.00	10.50	13.62
(304.80)	(266.70)	(345.95)



ORDERING OPTIONS CODES:

BODY MATERIAL

- A- Aluminum gage body (standard)
- B- Brass gage body (optional)
- S- Steel gage body (optional)
- Y- Stainless Steel gage body (optional)

SEAL MATERIAL

- 1- Buna N seals (standard)
- 2- Butyl seals (optional)
- 3- Viton® seals (optional)
- 4- Ethylene propylene seals (optional)
- 5- Silicone seals (optional)

HOW TO ORDER

EXAMPLE:

G640-05-A-1 — Buna N Seals
 — Aluminum gage body
 — 5.00 (127.00 mm) mounting centers
 — Series G640

Dimensions and specifications are subject to change without notice. Not all items are Made-To-Stock, contact us for availability.

02/14

Ph : 920-682-6877
 Fx : 920-684-7210



sales@ldi-industries.com
 www.ldi-industries.com

SIGHT GAGES - CLOSED CIRCUIT

G642 SERIES

The G642 Series back mount closed circuit sight gages provide 270° of viewing the fluid level clearly delineated by a redline on white background integral to the sight glass all secured within an aluminum body (HIGH-LOW markings). A wetted front facing dial thermometer provides an analog display of the fluid temperature.

Standard Features:

- Back mount
- 270° of viewing the fluid level (.50 inches wide)
- Viewing enhanced by redline on white background integral to sight glass
- 1.81 inch diameter dual scale dial thermometer, 0° to 300°F and -20° to 150°C
- Aluminum tube shields thermometer probe extending into reservoir
- Suitable for use with most hydraulic and machine lubricating oils

Standard Materials:

- Aluminum construction
- Buna N seals
- Borosilicate glass sight
- Zinc plated, steel hex nuts

Temperature and Pressure Ratings:

- 125 psi (862 kPa) maximum working pressure at 150°F (65°C)
- Please refer to Temperature Ratings by Seal Material for additional operating conditions (Appendix RA-5 on page RA-A5)

NOTES:

- Access to inside of reservoir is required to mount this style sight gage
- Please refer to Appendix RA-3 on page RA-A3 for installation instructions

CAUTION: • Not recommended for use with water, steam, acidic fluids, caustic fluids and volatile fluids
 • If aluminum construction is selected for a water application, anodizing is recommended
 • Reservoir must be drained to remove dial thermometer or loss of fluid will occur

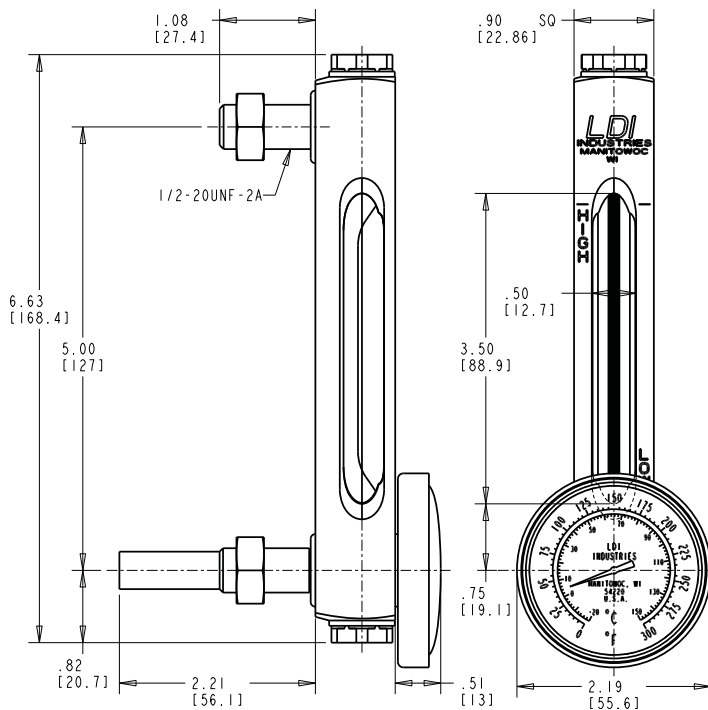

NOTE: All dimensions are inches [mm]



ORDERING OPTIONS CODES:

BODY MATERIAL

- A- Aluminum gage body (standard)
- B- Brass gage body (optional)
- S- Steel gage body (optional)
- Y- Stainless Steel gage body (optional)

SEAL MATERIAL

- 1- Buna N seals (standard)
- 2- Butyl seals (optional)
- 3- Viton® seals (optional)
- 4- Ethylene propylene seals (optional)
- 5- Silicone seals (optional)

HOW TO ORDER

EXAMPLE:

G642-05-A-1 — Buna N Seals
 — Aluminum gage body
 — 5.00 (127.00 mm) mounting centers
 — Series G642

Dimensions and specifications are subject to change without notice. Not all items are Made-To-Stock, contact us for availability.

02/14

Ph : 920-682-6877
 Fx : 920-684-7210



sales@ldi-industries.com
 www.ldi-industries.com

SIGHT GAGES - CLOSED CIRCUIT

G645 SERIES

The G645 front mount closed circuit sight gages provide front viewing of the fluid level clearly delineated by a redline on white background integral to the glass sight all secured within an aluminum body (HIGH-LOW markings). A dry dial thermometer allows for temperature monitoring. The thermowell for the thermometer also serves as one of the mounting bolts for the sight gage. This construction allows the thermometer orientation to be adjusted independent of the sight gage and removed if necessary without having to drain the reservoir.

Standard Features:

- Front mount
- Fluid level visible from front of gage (.50 inches wide)
- Viewing enhanced by redline on white background integral to sight glass
- 2.00" diameter dual scale dial thermometer, 0° to 300°F and -20° to 150°C
- Dial thermometer may be removed from a filled reservoir without loss of fluid
- Suitable for use with most hydraulic and machine lubricating oils

Standard Materials:

- Aluminum construction
- Buna N seals
- Borosilicate glass sight
- Zinc plated, steel hex nuts

Temperature and Pressure Ratings:

- Please refer to Appendix RA-1 on page RA-A1 for Sight Opening & Pressure Rating information
- Please refer to Temperature Ratings by Seal Material for additional operating conditions (Appendix RA-5 on page RA-A5)

NOTE:

- Please refer to Appendix RA-2 on page RA-A2 for installation instructions

CAUTION: • Not recommended for use with water, steam, acidic fluids, caustic fluids and volatile fluids

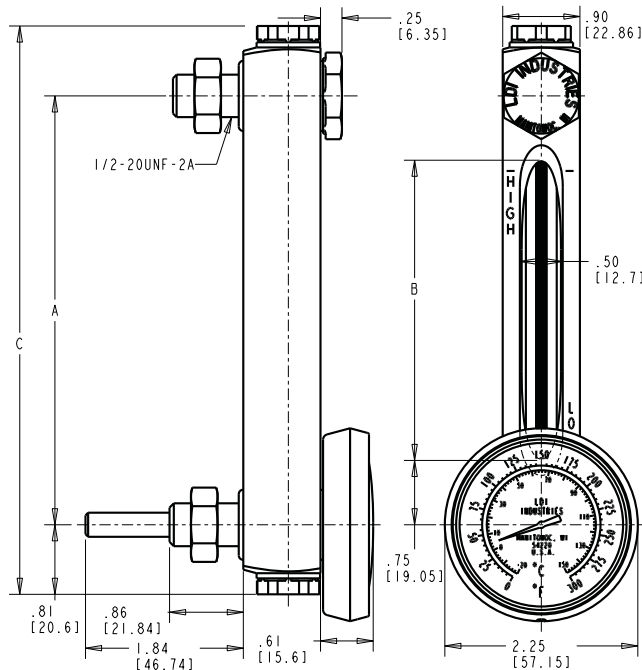

NOTE: All dimensions are inches [mm]

ORDERING OPTIONS CODES:

Select mounting centers of 5.00 inches (127.00 mm), 8.00 inches (203.20 mm) or 10.00 inches (254.00 mm) available from stock.

Consult factory for other lengths

BODY MATERIAL

- A- Aluminum gage body (standard)
- B- Brass gage body (optional)
- S- Steel gage body (optional)
- Y- Stainless Steel gage body (optional)

SEAL MATERIAL

- 1- Buna N seals (standard)
- 2- Butyl seals (optional)
- 3- Viton® seals (optional)
- 4- Ethylene propylene seals (optional)
- 5- Silicone seals (optional)

HOW TO ORDER

EXAMPLE:

G645-05-A-1 — Buna N Seals
 Aluminum gage body
 5.00 (127.00 mm) mounting centers
 Series G645

G645 Series		
A inches (mm)	B inches (mm)	C inches (mm)
5.00 (127.00)	3.50 (88.90)	6.62 (168.15)
8.00 (203.20)	6.50 (165.10)	9.62 (244.35)
10.00 (254.00)	8.50 (215.90)	11.62 (295.15)
12.00 (304.80)	810.50 (266.70)	13.62 (345.95)



Dimensions and specifications are subject to change without notice. Not all items are Made-To-Stock, contact us for availability.

02/14

Ph : 920-682-6877
 Fx : 920-684-7210



sales@ldi-industries.com
 www.ldi-industries.com

SIGHT GAGES - CLOSED CIRCUIT

G1615 SERIES

The G1615 Series front mount closed circuit sight gages provide front viewing of the fluid level through a clear glass sight. Integral to the sight gage is a thermometer contained within a white colored card for direct reading of the fluid temperature. The white colored card helps draw eye contact to the fluid level quickly.

Standard Features:

- Front Mount
- Fluid level visible from front of gage (.75 inches wide)
- Clear glass sight
- Card thermometer (3.00 inch centerline only), dual scale 60° to 180°F and 20° to 80°C graduations
- Card thermometer (on 5.00 inch and 10.00 inch centerline), dual scale 0° to 220°F and -20° to 110°C graduations
- 1/2-20UNF mounting bolts accommodate reservoir wall thicknesses up to .62 inches
- Suitable for use with most hydraulic and machine lubricating oils

Standard Materials:

- Aluminum gage body and mounting bolts
- Buna N seals
- Borosilicate glass
- Red color alcohol within thermometer bulb
- Steel, zinc plated hex nuts

Temperature and Pressure Ratings:

- Maximum working pressure up to 20 PSI (138 kPa) at 150°F (65°C), no corrosion
- Please refer to Temperature Ratings by Seal Material for additional operating conditions (Appendix RA-5 on page RA-A5)

NOTE:

- Please refer to Appendix RA-2 on page RA-A2 for installation instructions

CAUTION: • Not recommended for use with water, steam, acidic fluids, caustic fluids and volatile fluids

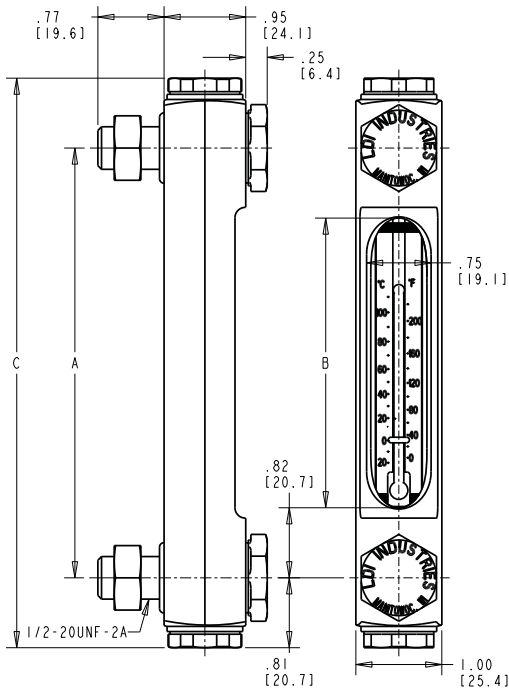

NOTE: All dimensions are inches [mm]

ORDERING OPTIONS CODES:

BODY MATERIAL

-A- Aluminum gage body (standard)

SEAL MATERIAL

-1- Buna N seals (standard)
-3- Viton® seals (optional)

OPTIONS:

- **EPDM Seals**
 - Specify -4 in place of -1 or -3 in catalog number
- **1/2-13 Coarse thread for mounting**
 - Specify "C" after the seal number
- **M12 x 1.75 thread for mounting**
 - Specify "M" after seal number
- **Consult factory for availability & price on blue fluid in thermometer**
 - Specify "B" after seal number (Not available for 3.00 [76.20mm] centers)

Dimensions and specifications are subject to change without notice. Not all items are Made-To-Stock, contact us for availability.

02/14

G1615 Series			
Part No.	A inches (mm)	B inches (mm)	C inches (mm)
Buna N SEALS			
G1615-03-A-1	3.00 (76.20)	1.37 (34.80)	4.62 (117.35)
G1615-05-A-1	5.00 (127.00)	3.37 (85.60)	6.62 (168.15)
G1615-10-A-1	10.00 (254.00)	8.37 (212.60)	11.62 (295.15)
VITON® SEALS			
G1615-03-A-3	3.00 (76.20)	1.37 (34.80)	4.62 (117.35)
G1615-05-A-3	5.00 (127.00)	3.37 (85.60)	6.62 (168.15)
G1615-10-A-3	10.00 (254.00)	8.37 (212.60)	11.62 (295.15)



HOW TO ORDER

EXAMPLE:

G1615-10-A-1 — Buna N Seals
Aluminum gage body
10.00 (254.00 mm) mounting centers
Series G1615

SIGHT GAGES - CLOSED CIRCUIT

G1620 SERIES

The G1620 Series back mount closed circuit sight gages provide front viewing of the fluid level through a clear sight glass. Integral to the sight gage is a thermometer contained within a white colored card for direct reading of the fluid temperature. The white colored card helps draw eye contact to the fluid level quickly.

Standard Features:

- Back mount
- Fluid level visible from front of gage (.75 inches wide)
- Clear sight glass
- Card thermometer (3.00 inch centerline only), dual scale 60° to 180°F and 20° to 80°C graduations
- Card thermometer (5.00 inch and 10.00 inch centerline), dual scale 0° to 220°F and -20° to 110°C graduations
- Suitable for use with most hydraulic and machine lubricating oils

Standard Materials:

- Aluminum construction
- Buna N or Fluorocarbon (Viton®) seals
- Borosilicate glass sight
- Red color alcohol within thermometer bulb
- Zinc plated, steel locknuts

Temperature and Pressure Ratings:

- 20 psi (138 kPa) maximum working pressure at 150°F (65°C)
- Please refer to Temperature Ratings by Seal Material for additional operating conditions (Appendix RA-5 on page RA-A5)

NOTES:

- Access to inside of reservoir is required to mount this style sight gage.
- Please refer to Appendix RA-3 on page RA-A3 for installation instructions

CAUTION: • Not recommended for use with water, steam, acidic fluids, caustic fluids and volatile fluids

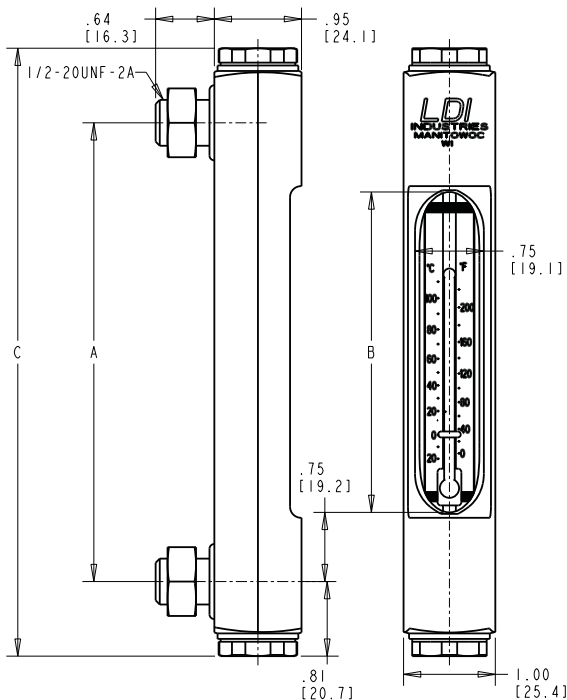

NOTE: All dimensions are inches [mm]

ORDERING OPTIONS CODES:

BODY MATERIAL

-A- Aluminum gage body (standard)

SEAL MATERIAL

-1- Buna N seals (standard)
-3- Viton® seals (optional)

OPTIONS:

- EPDM Seals
 - Specify -4 in place of -1 or -3 in catalog number
- Consult factory for availability & price on blue fluid in thermometer
 - Specify "B" after seal number (Not available for 3.00 [76.20mm] centers)

G1620 Series			
Part No.	A inches (mm)	B inches (mm)	C inches (mm)
Buna N SEALS			
G1620-03-A-1	3.00 (76.20)	1.37 (34.80)	4.62 (117.35)
G1620-05-A-1	5.00 (127.00)	3.37 (85.60)	6.62 (168.15)
G1620-10-A-1	10.00 (254.00)	8.37 (212.60)	11.62 (295.15)
VITON® SEALS			
G1620-03-A-3	3.00 (76.20)	1.37 (34.80)	4.62 (117.35)
G1620-05-A-3	5.00 (127.00)	3.37 (85.60)	6.62 (168.15)
G1620-10-A-3	10.00 (254.00)	8.37 (212.60)	11.62 (295.15)



HOW TO ORDER

EXAMPLE:

G1620-05-A-1 — Buna N Seals
Aluminum gage body
5.00 (127.00 mm) mounting centers
Series G1620

Dimensions and specifications are subject to change without notice. Not all items are Made-To-Stock, contact us for availability.

02/14

Ph : 920-682-6877
Fx : 920-684-7210

LDI Industries

sales@ldi-industries.com
www.ldi-industries.com

SIGHT GAGES - CLOSED CIRCUIT

SGC SERIES

The SGC Series front mount closed circuit sight gages provide front viewing of the fluid level through a clear sight glass. Integral to the sight gage is a thermometer contained within a white colored card for direct reading of the fluid temperature. The white colored card helps draw eye contact to the fluid level quickly. Check valves integral to mounting studs allow for removal of sight gage without having to drain the reservoir.

Standard Features:

- Front mount
- Fluid level visible from front of gage (.75 inches wide)
- Clear sight glass
- Card thermometer, dual scale 0° to 220°F and -20° to 110°C graduations
- Mounting studs accommodate reservoir wall thicknesses up to .56 inches
- Suitable for use with most hydraulic and machine lubricating oils

Standard Materials:

- Aluminum & Brass Construction
- Buna N seals
- Borosilicate glass sight

Temperature and Pressure Ratings:

- 20 psi (138 kPa) maximum working pressure at 150°F (65°C)
- Please refer to Temperature Ratings by Seal Material for additional operating conditions (Appendix RA-5 on page RA-A5)

NOTES:

- Access to inside of reservoir is required to mount studs with integral check valves.
- Please refer to Appendix RA-11 on page RA-A10 for installation instructions

CAUTION: • Not recommended for use with water, steam, acidic fluids, caustic fluids and volatile fluids

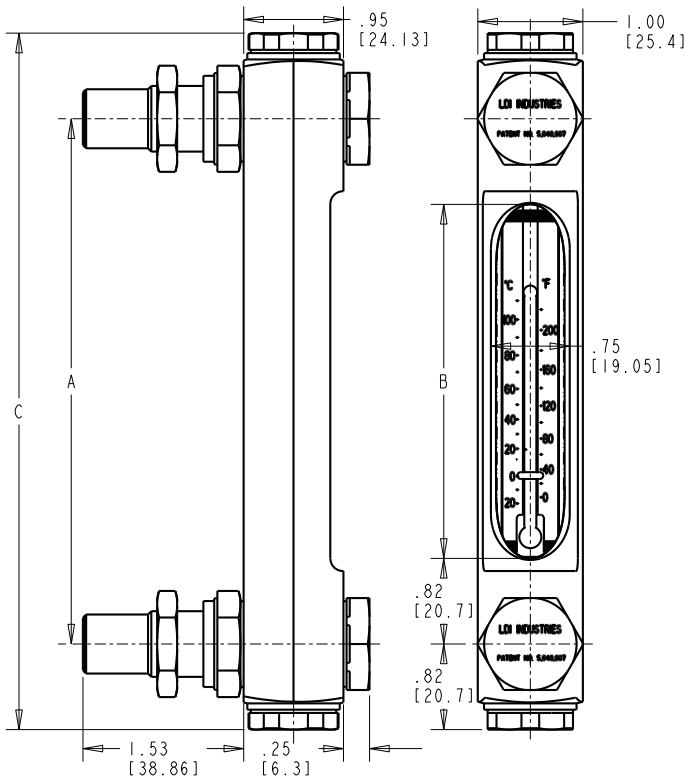

SGC Series			
Part No.	A Centers inches (mm)	B Sight inches (mm)	C Length inches (mm)
SGC5	5.00 (127.00)	3.50 (88.90)	6.62 (168.15)
SGC10	10.00 (254.00)	8.50 (215.90)	11.62 (295.15)



NOTE: All dimensions are inches [mm]

HOW TO ORDER

EXAMPLE:

SGC-10 — 10.00 inch (254.00 mm) mounting centers
Series SGC

When ordering, specify either 5.00 inch (127.00mm) or 10.00 inch (254.00mm) mounting centers following the series number, separated with a dash(-).

Dimensions and specifications are subject to change without notice. Not all items are Made-To-Stock, contact us for availability.

02/14

SIGHT GAGES - CLOSED CIRCUIT

TMA SERIES

TMA Series dial thermometers come in two assembly styles. TMA100 Series dial thermometers have a straight thread, bulkhead style mounting and the TMA200 Series dial thermometers mount directly into pipe threaded couplings.

Standard Features - TMA100 Series:

- An aluminum enclosure shields side of thermometer face
- 1.38 inch diameter dual scale dial thermometer, 50° to 300°F and 10° to 150°C
- Aluminum stud extends into reservoir to partially shield Stainless Steel thermometer probe
- Buna N o-rings
- Back mount
- Zinc plated hex jam nut

NOTES:

- Access to inside of reservoir is required to mount the TMA100 Series thermometer
- For both TMA100 and TMA200 series, please refer to Appendix RA-12 on page RA-A12 for installation instructions

Standard Materials:

- Aluminum construction
- Stainless Steel thermometer probe

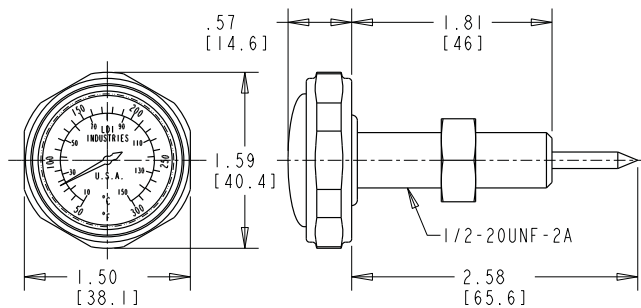

NOTE: All dimensions are inches [mm]

TMA100 Series					
Part No.	A inches (mm)	B inches (mm)	C inches (mm)	D UNF	Scale
TMA111-A-1	1.50 (38.10)	1.59 (40.39)	.50 (12.70)	1/2-20	50° to 300° F 10° to 150° C



Standard Features - TMA200 Series:

- An aluminum enclosure shields side of thermometer face
- 1.38 inch diameter dual scale dial thermometer, 50° to 300°F and 10° to 150°C (TMA202 & TMA204)
- 1.81 inch diameter dual scale dial thermometer, 0° to 300°F and -20° to 150°C (TMA214)
- Buna N o-rings
- Front mount - threads into pipe threaded coupling
- Brass pipe adapter

Temperature and Pressure Ratings:

- 125 psi (862 kPa) maximum working pressure at 150°F (65°C)
- Please refer to Temperature Ratings by Seal Material for additional operating conditions (Appendix RA-5 on page RA-A5)

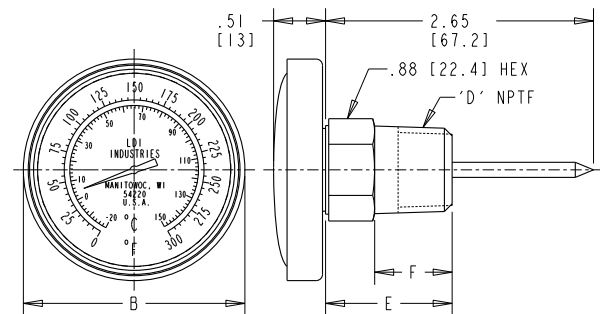

NOTE: All dimensions are inches [mm]

TMA200 Series					
Part No.	B inches (mm)	D NPTF	E inches (mm)	F inches (mm)	Scale
TMA202-A-1	1.45 (36.83)	1/4-18	1.06 (26.92)	.56 (14.22)	50° to 300° F 10° to 150° C
TMA204-A-1	1.45 (36.83)	1/2-14	1.25 (31.75)	.75 (19.05)	50° to 300° F 10° to 150° C
TMA214-A-1	2.19 (55.63)	1/2-14	1.25 (31.75)	.75 (19.05)	0° to 300° F -20° to 150° C



ORDERING OPTIONS CODES FOR TMA200 SERIES:

BODY MATERIAL

- A- Aluminum body (standard)
- B- Brass construction (optional)

SEAL MATERIAL

- 1- Buna N seals (standard)
- 3- Viton ® seals (optional)

HOW TO ORDER TMA200 SERIES

EXAMPLE:

TMA202-A-1 — Buna N Seals
 — Aluminum body
 — Style Number

Dimensions and specifications are subject to change without notice. Not all items are Made-To-Stock, contact us for availability.

02/14

Ph : 920-682-6877
 Fx : 920-684-7210

LDI Industries

sales@ldi-industries.com
 www.ldi-industries.com